

BUTLER COUNTY

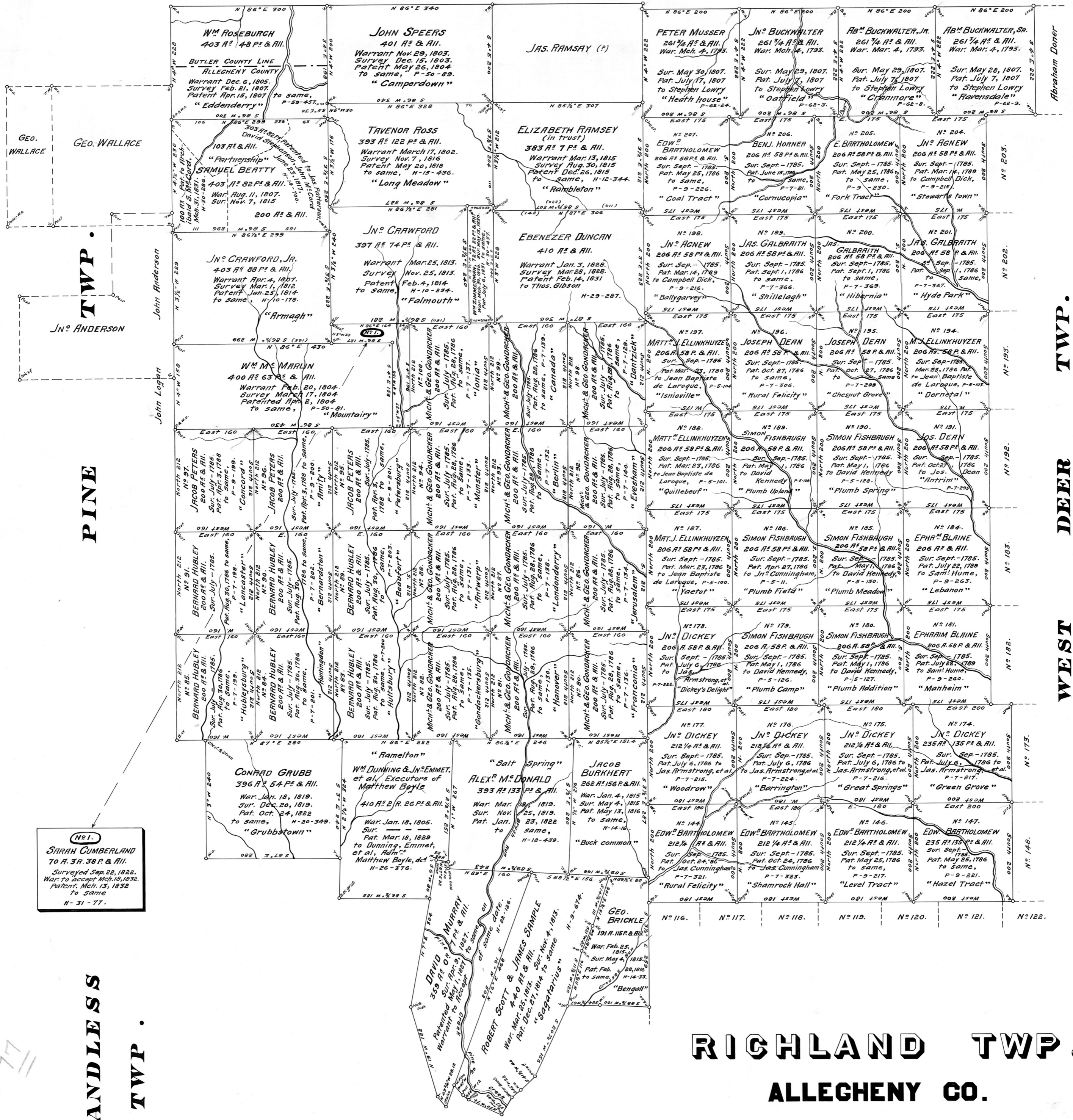

(N.R.)
SARAH CUMBERLAND
To A. R. 38 P. & Ail.
Surveyed Sep. 22, 1822.
War. to accept Mch. 15, 1832.
Patent, Mch. 13, 1832
to same.
N-31-77.

RIGHLAND TWP.

ALLEGHENY CO.

HAMPTON TWP.