

# LAWRENCE COUNTY

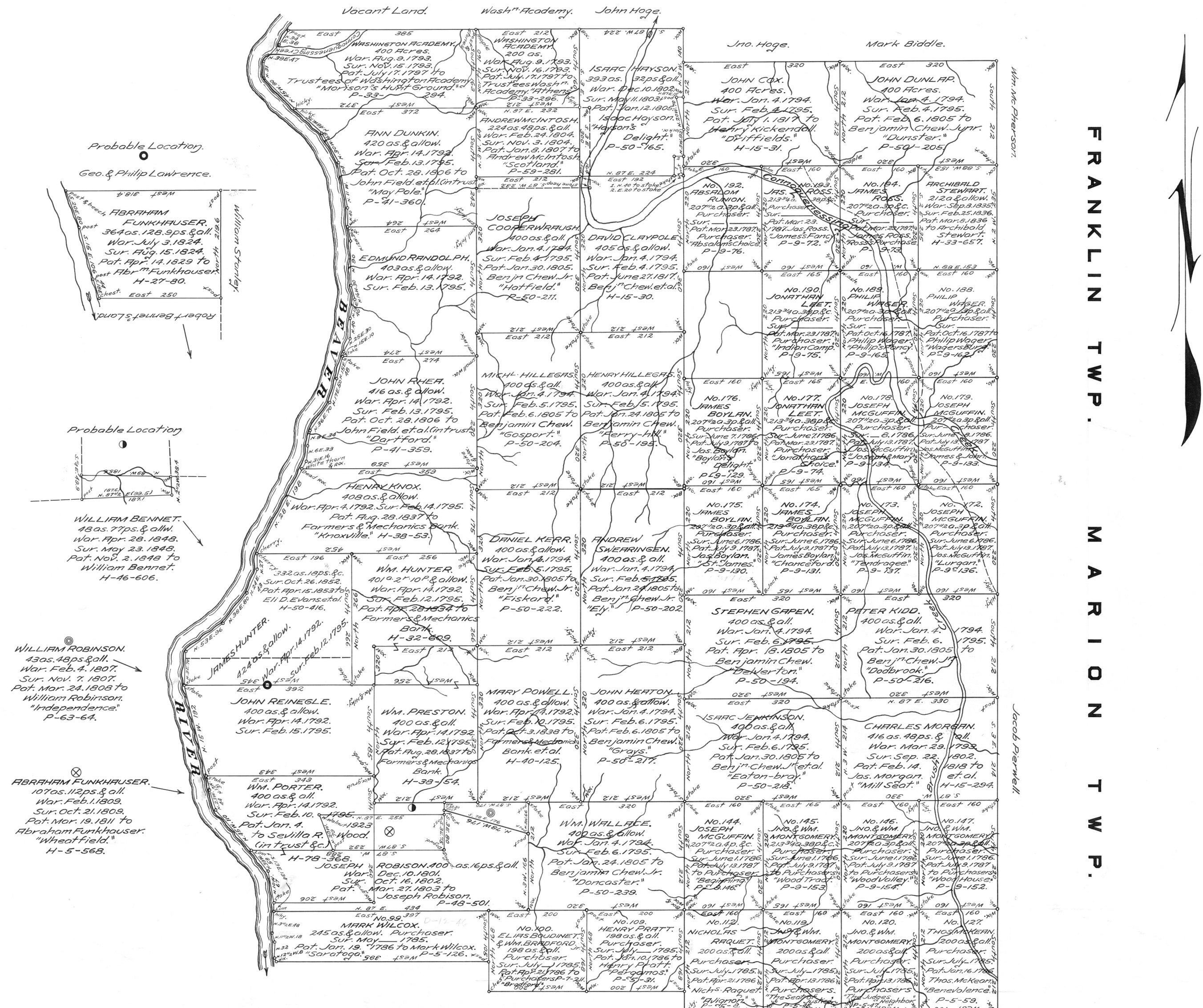

Probable Location  
Geo. & Philip Lawrence.

ABRAHAM FUNKHAUSER, 364 acs. 128.9 ps. & all. War. July 3, 1824. Pat. Apr. 14, 1824 to Abrahm Funkhauser. H-27-80.

Probable Location

WILLIAM BENNET, 48 acs. 77 ps. & all. War. Apr. 23, 1848. Sur. May 23, 1848 to William Bennet. H-16-606.

WILLIAM ROBINSON, 43 acs. 48 ps. & all. War. Feb. 4, 1807. Sur. Nov. 24, 1807 to William Robinson. "Independence." P-63-64.

ABRAHAM FUNKHAUSER, 107 acs. 11 ps. & all. War. Feb. 1, 1809. Sur. Oct. 7, 1809. Pat. Mar. 19, 1811 to Abraham Funkhauser. "Wheatfield." H-5-568.

## DAUGHERTY TOWNSHIP

In Testimony, That the above is a connected draft of all the tracts of land situated in the township of North Sewickley and county of Beaver, constructed from and compared with the original drafts remaining on file in the Department of Internal Affairs of Pennsylvania, the warrants, surveys and patents bearing date respectively as above set forth; I have hereunto set my Hand and caused the Seal of the said Department to be affixed, at Harrisburg, the twentieth day of November Anno Domini 1931.



Philip H. Dewey  
Secretary of Internal Affairs.

## NORTH SEWICKLEY TOWNSHIP

Scale: 1 Inch = 100 Rods.  
William F. Moore,  
Director of Land Records.