

1
Courses & Distances
Starting at the N.W. Cor.
1.M.74 E. 14
2.S.42 E. 44
3.S.72 E. 57
4.S.34 E. 19 1/2
5.S.33 E. 47
6.South 44
7.S.20 W. 48
8.S. 2 E. 88
9.S. 4 W. 16
10.S.18 W. 18
11.S.28 W. 20
12.S.13 W. 22
13.S.15 W. 109
14.S.10 W. 28
15.S.22 W. 45
16.S.38 W. 28
17.S.59 W. 18
18.M. 7 W. 24
19.M.21 E. 65
20.M. 2 W. 52
21.M. 9 W. 100
22.M.16 W. 50
23.M.30 W. 48
24.M.10 W. 96
25.M. 4 W. 31
26.M. 4 E. 45
27.M.15 E. 24
28.M.34 E. 41 To Beg.

2
B-23-111
THE HONR.
PROPRIETARIES
22 As. & All.
War Oct. 13, 1760
Sur Dec. 10 & 11, 1760
For the use of the
PROPRIETARIES
Huling Is.
Courses & Distances
Starting at the N.W. Cor.
1.M.52 E. 24
2.M.62 E. 11
3.M.52 E. 95
4.S.53 E. 4
5.S.37 W. 14
6.S.29 W. 119
7.M.50 W. 43
8.M.33 W. 14 To Beg.

3
B-23-112
THE HONR.
PROPRIETARIES
5 1/2 As. & All.
War Oct. 13, 1760
Sur. Nov. 13, 1760
For the use of the
PROPRIETARIES
West Fall Is.
Courses & Distances
Starting at elm of the
upper end of Island.
1.S. 7 E. 14 To Loc.
2.S.26 W. 26 To Butternut
3.S.41 W. 30 To Mub.
4.S.01 W. 13 To Hic.
5.M.27 E. 52 To Hic.
6.M.50 E. 24 To Beg.

4
C-178-237
JAMES REED
Appl. 2069 Dated Nov. 4, 1766
15 1/4 As. & All.
Sur. June 1, 1767

5
C-184-241
JAMES REED
29 As. & All.
War. Jun. 20, 1814
Sur. Aug. 9, 1814
Pat. Jan. 24, 1815
To James Reed
H-12-159

6
C-105-129
WILLIAM JOHNSTON
22 As. & All.
War. Aug. 2, 1815
Sur. Aug. 4, 1815
Courses & Distances
Starting at Stones.N.W. Cor.
1.S. 74 E. 61 To Post.
2.S. 28 E. 58 To Stones.
3.S. 86 W. 70 To Stones.
4.M. 14 E. 295 To Dogwt.
5.M. 35 W. 15 To Birch.
6.M. 7 W. 25 To Hic.
7.M. 58 W. 135 To Beg.

7
D-61-290
WILLIAM JOHNSTON
129 As. & All.
War. Jan. 26, 1775
Sur. Mar. 6, 1775

8
A-50-260
24 As. 40 P. & All.
Sur. Feb. 6, 1817
Pat. Mar. 12, 1818
To Daniel Lemmon
H-15-335

9
C-105-129
8 As. 40 P. & All.
Sur. Aug. 4, 1815
Pat. Mar. 25, 1845
To Jacob Buchanan
H-45-352

10
C-144-184
115 As. 113 P. & All.
Sur. Apr. 11, 1827
Pat. Apr. 18, 1827
To Thos. & Mary McConnell
on War to accept Apr. 18, 1827
H-22-119

11
Starting at Post.N.W. Cor.
1.M.88 E. 27 To Linn.
2.S.86 E. 14 To Bo.
3.M.77 1/2 E. 16 To Ches.
4.S.75 E. 31 To Gum.
5.M.72 E. 25 To Wa.
6.M.65 E. 8 To Hic.
7.M.81 E. 8 To Ches.
8.S.89 E. 11 To Sto.
9.M.84 1/2 E. 94 To Post.
10.S.27 1/2 W. 100 To Wa.
11.S.77 W. 187 To Service.
12.Up river 114 To Beg.

12
C-105-129
8 As. 40 P. & All.
Sur. Aug. 4, 1815
Pat. Mar. 25, 1845
To Jacob Buchanan
H-45-352

13
C-105-129
8 As. 40 P. & All.
Sur. Aug. 4, 1815
Pat. Mar. 25, 1845
To Jacob Buchanan
H-45-352

14
C-105-129
8 As. 40 P. & All.
Sur. Aug. 4, 1815
Pat. Mar. 25, 1845
To Jacob Buchanan
H-45-352

15
C-105-129
8 As. 40 P. & All.
Sur. Aug. 4, 1815
Pat. Mar. 25, 1845
To Jacob Buchanan
H-45-352

16
C-105-129
8 As. 40 P. & All.
Sur. Aug. 4, 1815
Pat. Mar. 25, 1845
To Jacob Buchanan
H-45-352

17
C-105-129
8 As. 40 P. & All.
Sur. Aug. 4, 1815
Pat. Mar. 25, 1845
To Jacob Buchanan
H-45-352

18
C-105-129
8 As. 40 P. & All.
Sur. Aug. 4, 1815
Pat. Mar. 25, 1845
To Jacob Buchanan
H-45-352

19
C-105-129
8 As. 40 P. & All.
Sur. Aug. 4, 1815
Pat. Mar. 25, 1845
To Jacob Buchanan
H-45-352

20
C-105-129
8 As. 40 P. & All.
Sur. Aug. 4, 1815
Pat. Mar. 25, 1845
To Jacob Buchanan
H-45-352

21
C-105-129
8 As. 40 P. & All.
Sur. Aug. 4, 1815
Pat. Mar. 25, 1845
To Jacob Buchanan
H-45-352

22
C-105-129
8 As. 40 P. & All.
Sur. Aug. 4, 1815
Pat. Mar. 25, 1845
To Jacob Buchanan
H-45-352

23
C-105-129
8 As. 40 P. & All.
Sur. Aug. 4, 1815
Pat. Mar. 25, 1845
To Jacob Buchanan
H-45-352

24
C-105-129
8 As. 40 P. & All.
Sur. Aug. 4, 1815
Pat. Mar. 25, 1845
To Jacob Buchanan
H-45-352

25
C-105-129
8 As. 40 P. & All.
Sur. Aug. 4, 1815
Pat. Mar. 25, 1845
To Jacob Buchanan
H-45-352

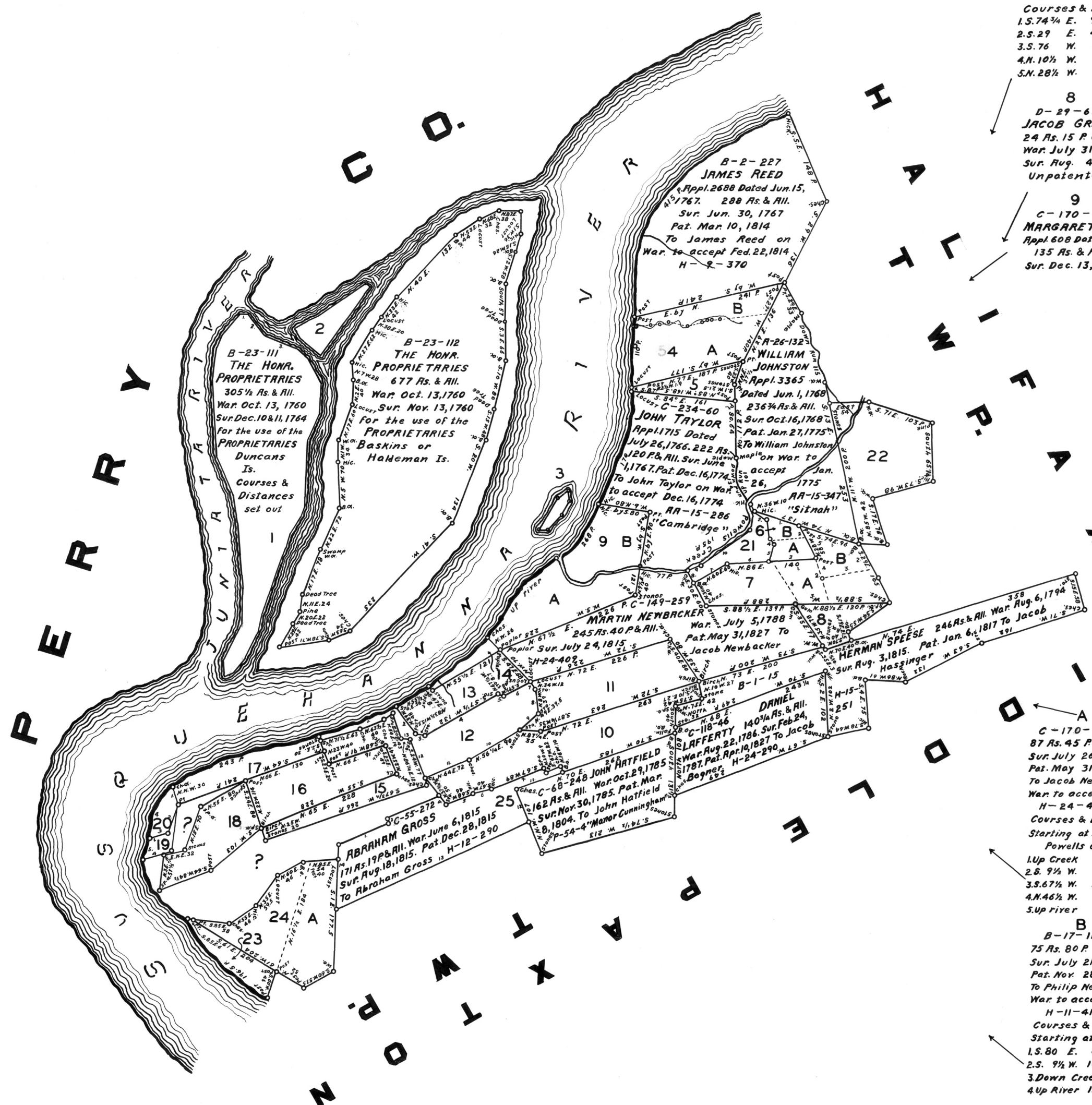

7B
C-105-50
29 As. 110 P. & All.
Sur. May 2, 1834
War. Mar. 6, 1794
To John Sawyer
H-32-614
Courses & Distances
1.S.74 1/4 E. 97 To Bo.
2.S.29 E. 44 To Stones.
3.S.76 W. 84 To Stones.
4.N.10 1/2 W. 34 To Post.
5.N.28 1/2 W. 58 To Post.

8
D-29-67
JACOB GREBIELL
24 As. 15 P. & All.
War. July 31, 1815
Sur. Aug. 4, 1815
Unpatented

9
C-170-34
MARGARET POWELL
Appl. 608 Dated Aug. 23, 1765
135 As. & All.
Sur. Dec. 13, 1766

10
B-17-113
75 As. 80 P. & All.
Sur. July 21, 1815
Pat. Nov. 28, 1815
To Philip Newbucker on
War to accept Nov. 27, 1815
H-11-415
Courses & Distances
Starting at Post.N.W. Cor.
1.S.80 E. 85 To Post.
2.S. 9 1/2 W. 101 To Sto.
3.Down Creek 155 To Mouth.
4.Up River 117 To Beg.

11
B-16-127
THOMAS ELDER et al.
159 As. 96 P. & All.
War. Feb. 22, 1827
Sur. Mar. 27, 1827
Pat. Apr. 14, 1831
To Thomas Elder et al.
H-29-380

12
B-2-103
MATTHIAS FLAM
89 As. 140 P. & All.
War. Mar. 6, 1794
Sur. Apr. 15, 1813
Pat. Jun. 28, 1836
To Robert Clark
H-36-285
Courses & Distances
Starting at Post.N.W. Cor.
1.Up river 126 P. To Stone.
2.S.39 E. 48 To Post.
3.S.83 1/2 E. 155 To Stones.
4.N.57 1/2 E. 132 To Post.
5.S.67 1/2 E. 87 To Sto.
6.N.59 1/2 E. 48 To Sto.
7.S.34 E. 12 To Stones.
8.S. 8 E. 39 To Stones.
9.S.40 W. 375 To Stones.
10.S.58 1/2 W. 90 P. To Ches.
11.S.64 W. 72 To Ches.
12.N.24 W. 67.5 To Sto.
13.S.86 1/2 W. 12 To Spac.
14.N.20 W. 43 To Spac.
15.S.54 W. 19 To Ches.
16.S.63 1/2 W. 40 To Ches.
17.S.71 1/2 W. 63 To Stones.
18.N.23 W. 6 To Beg.

13
C-28-282
ROBERT CLARK
54 1/2 As. & All.
War. June 20, 1814
Sur. Oct. 30 & 31, 1818
Pat. June 22, 1832
To Robert Clark
H-31-204

14
C-105-24
ABRAHAM JONES
Appl. 2534 Dated Apr. 27, 1767
11 As. & All.
Sur. Feb. 23, 1768
Pat. Jun. 22, 1832
To Robert Clark on War
to accept June 22, 1832
H-32-148
Courses & Distances
Starting at Ches.N.W. Cor.
1.S. E. 28 To Poplar.
2.S.57 1/2 W. 108 To Ches.
3.M.W. 8 To Sugar.
4.Up river 126 To Beg.

15
B-2-104
WILLIAM POWER
79 As. 80 P. & All.
War. Mar. 27, 1788
Sur. Oct. 15, 1819
Pat. Jun. 28, 1836
To Robert Clark
H-36-285

16
C-99-163
MARCUS HULINGS
100 As. & All.
War. Dec. 15, 1774
Sur. May 9, 1850
Pat. Nov. 30, 1850
To Jacob Haldeman
H-47-631

17
C-76-8
MARCUS HULINGS
Appl. 1834 Dated Aug. 27, 1834
50 As. & All.
Sur. June 1, 1767
Sur. Apr. 16, 1769
To Marcus Hulings on War
to accept Jan. 12, 1768
AA-10-494
"Hulings Landing"

18
C-68-177
JOHN HUBER
72 As. 80 P. & All.
War. Mar. 24, 1785
Sur. Dec. 1, 1785
Pat. Sep. 5, 1800
To John Musser et al.
P-43-285
"Partnership"

19
C-58-200
JACOB YONER
9 As. & All.
War. Apr. 15, 1761
Sur. Sep. 19, 1763
Pat. Mar. 16, 1765
To Jacob Grojean
AA-6-267
Courses & Distances
Starting at Hic.N.W. Cor.
1.E.N.E. 30 To Stones.
2.N.15 E. 48 To Stones.
3.S. 71 To Post.
4.W.5.W. 49 To Post.
5.Up river 32 To Beg.

20
A-10-223
ROBERT CLARK
10 As. 90 P. & All.
War. June 20, 1814
Sur. Oct. 10, 1819
Pat. June 23, 1836
To Robert Clark
H-36-262
Courses & Distances
1.S.24 1/2 E. 30 To Stones.
2.S.13 W. 46 To Post.
3.S.67 1/2 W. 27 To Post.
4.Up river 88 To L.M.

21
D-29-68
JACOB GREBIELL
27 As. 24 P. & All.
War. July 11, 1815
Sur. July 25, 1815
Unpatented
Courses & Distances
Starting at Ch.N.W. Cor.
1.M.65 E. 22 To —
2.M.52 E. 98 To —
3.M.35 E. 6 To —
4.M. 2 E. 22 To Hic.
5.S.58 E. 25 To Hic.
6.S. 7 E. 15 To Beech.
7.S.35 E. 25 To Dogwt.
8.S.14 W. 295 To Stones.
9.S.86 W. 66 To Wo.
10.S.60 W. 59 To B.O.
11.N.30 W. 20 To Beg.

22
C-96-218
ISAAC JONES
102 As. & All.
War. July 26, 1774
Sur. Aug. 29, 1744
Pat. Feb. 4, 1807
To Isaac Jones
P-59-232
"Mount Saluben"

23
D-63-155
JAMES FORSTER
38 As. 136 P. & All.
War. Apr. 26, 1773
Sur. Apr. 27, 1827
Pat. Sep. 15, 1827
To John Warner
H-24-536

24
D-29-116
THOMAS KENNEDY
132 As. 66 P. & All.
War. Dec. 19, 1785
Sur. Apr. 27, 1827

25
C-105-90
76 As. 80 P. & All.
Sur. Apr. 27, 1827
Pat. Sep. 15, 1827
To John Warner
H-24-536
Courses & Distances
Starting at Limwood.N.W. Cor.
1.M.67 E. 84 To Hic.
2.N.24 W. 7.4 To B.O.
3.M.67 E. 88 To Birch.
4.S.44 E. 16 To Stones.
5.M.68 E. 48 To Hic.
6.M.56 E. 40 To Hic.
7.M.67 E. 89 To Spac.
8.S.20 E. 9 To Stones.
9.M.67 E. 22 To Ches.
10.S.16 E. 10 To B.O.
11.S.65 W. 75 To Ches.
12.S.24 E. 59 To Stones.
13.S.65 W. 342 To Ches.
14.M.1 1/2 E. 104 To Beg.

A CONNECTED WARRANTEE TOWNSHIP MAP: of Reed Township, Dauphin County. The Applications, Warrants, Surveys and Patents bearing dates respectively as above set forth, constructed from and compared with the original drafts remaining on file in the Department of Internal Affairs, of the Commonwealth of Pennsylvania; under the direction of Warren J. Daniel, Director of the Land Office.

IN TESTIMONY WHEREOF: I have hereunto set my hand and caused the seal of the said Department to be affixed at Harrisburg, Pennsylvania; this twenty-first day of April, A.D. one thousand nine hundred and forty-eight.

William Stevenson
Secretary of Internal Affairs.

REED TOWNSHIP

