

Donation Donation Donation Donation

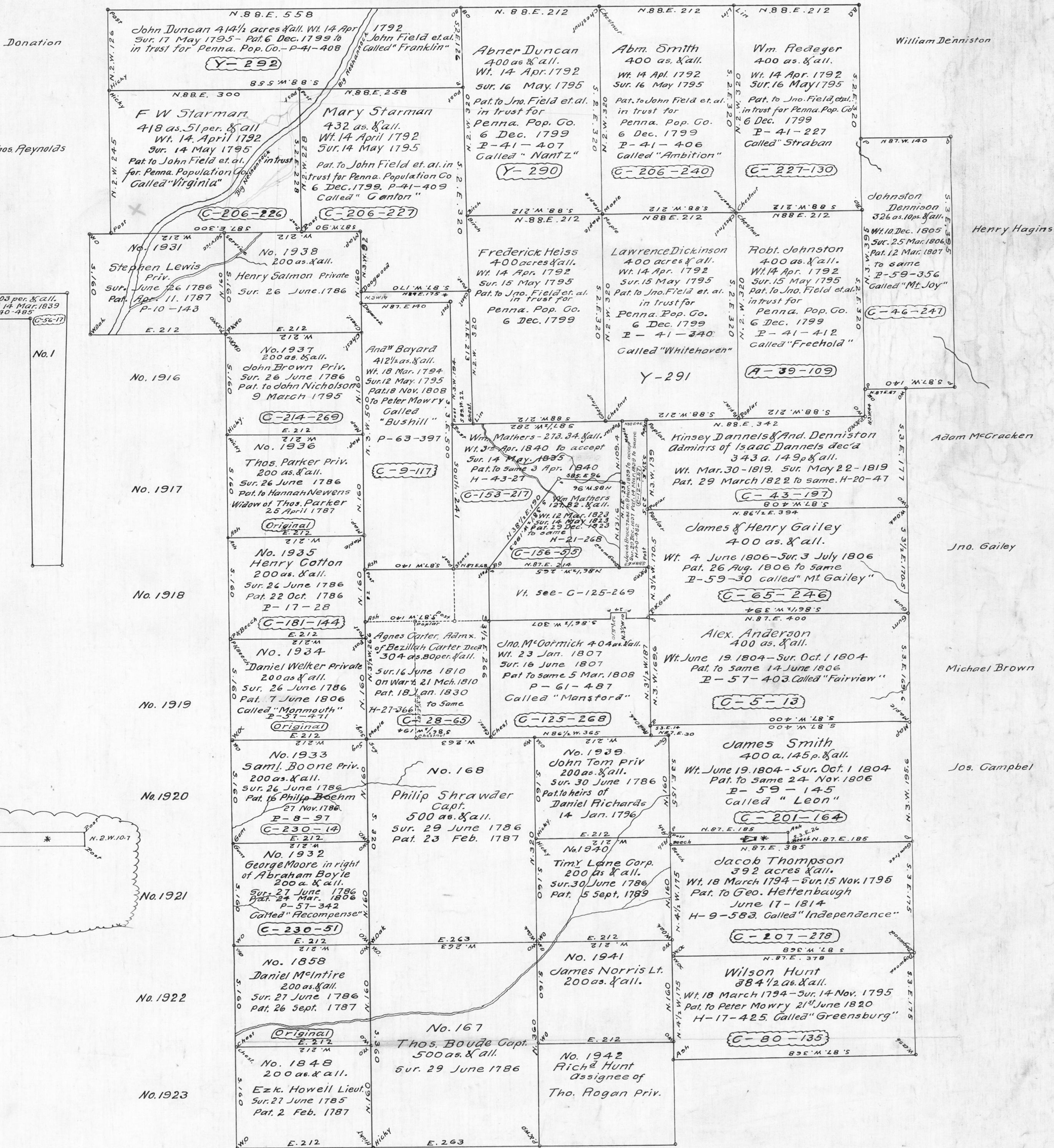

Kinsey Dannels - 48 as. 103 per. & all.
 * Sur. 29 Nov. 1837 - Wt. to accept 14 Mar. 1839
 Pat. to same 14 Mar. 1839. H-40-485

NO. 2
 Michael Hettenbaugh
 12 acres 35 & all.
 Wt. 5 Apr. 1833
 Sur. 16 Apr. 1834
 Pat. to him May 27, 1837
 H-37-403
 C-83-267