

DEER CREEK TOWNSHIP

PERRY TOWNSHIP

MILL CREEK TOWNSHIP

SANDY LAKE TOWNSHIP

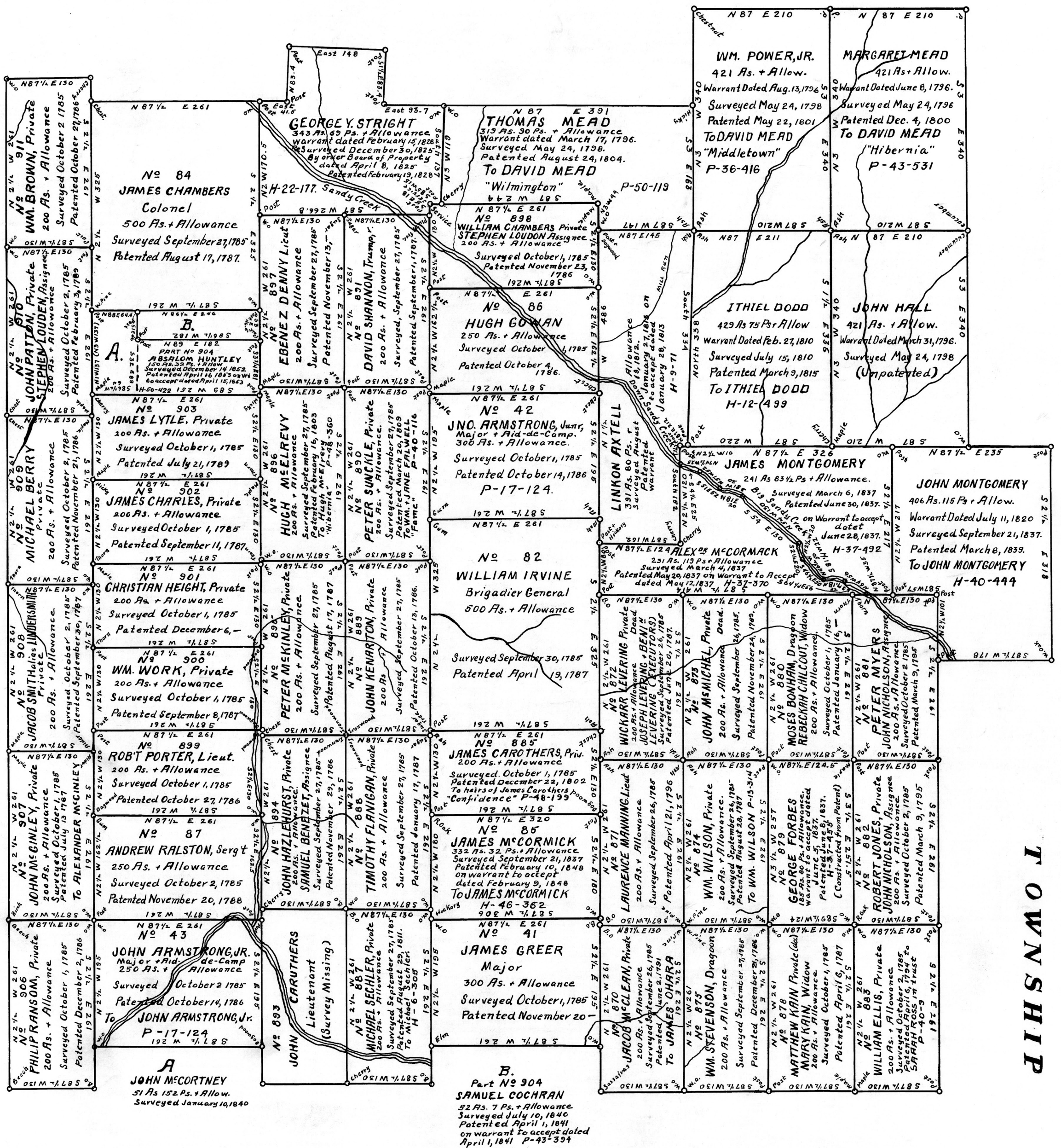

FAIRVIEW TOWNSHIP

**A CONNECTED DRAFT:** of the tracts of land situated in New Vernon Township, Mercer County. The Warrants, Surveys and Patents bearing dates respectively as above set forth, constructed from and compared with the original drafts remaining on file in the Department of Internal Affairs of Pennsylvania, under the direction of Warren J. Daniel, Director of the Land Office.

**IN TESTIMONY WHEREOF:** I have hereunto set my hand and caused the seal of the said Department to be affixed at Harrisburg, Pennsylvania this Fifth day of February A. D. One Thousand, Nine-Hundred and Forty-five.

*William S. Livezey*  
Secretary of Internal Affairs.