

SCALE: 1" = 40 RODS

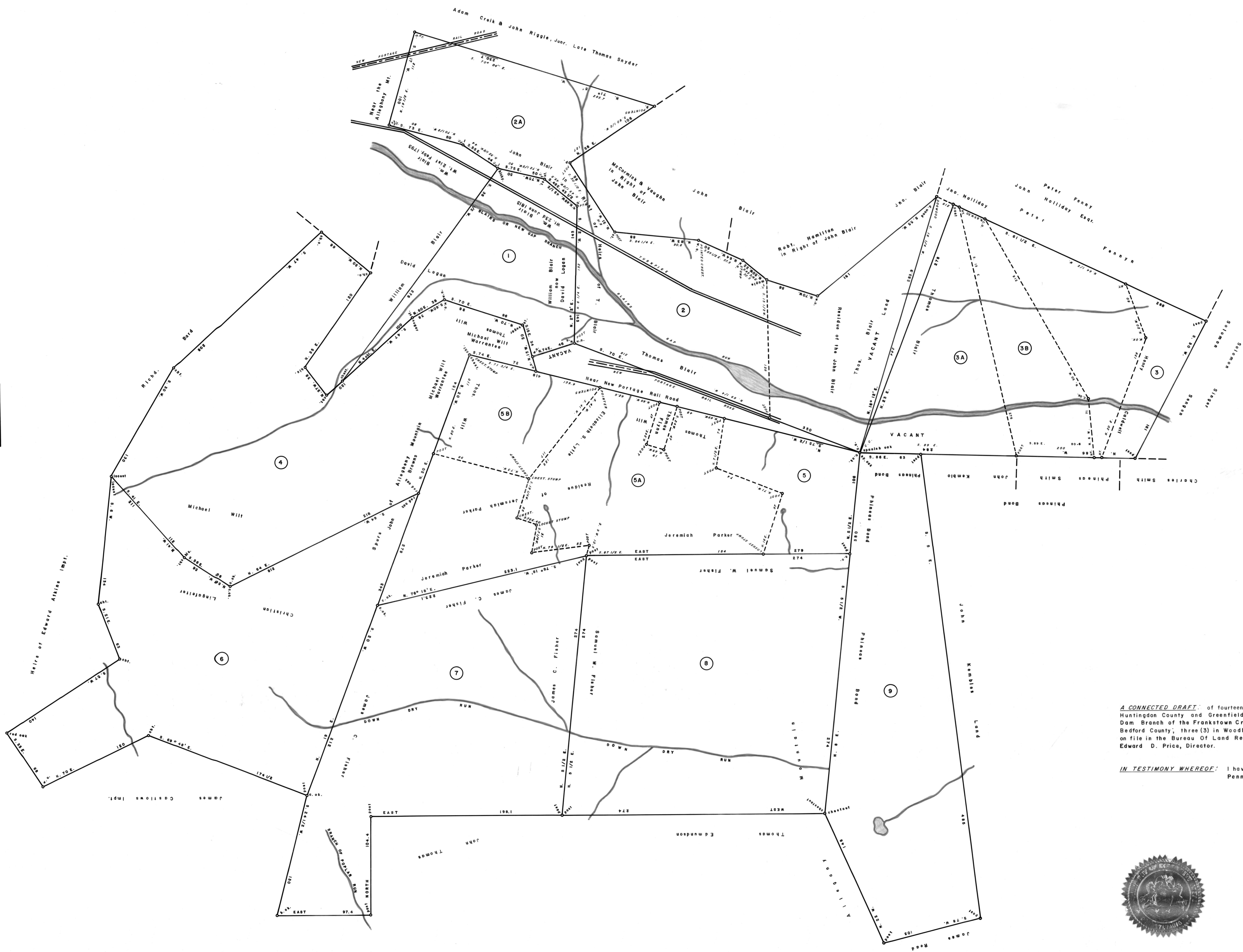
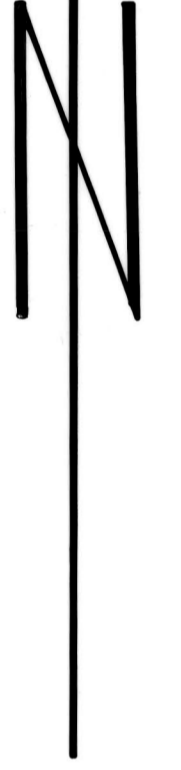

- | | | |
|---|--|--|
| <p>①
A — 76 — 251
WILLIAM BLAIR
123 ACRES — 37 PERCHES & AIL.
WARRANT — JUNE 23, 1813
SURVEY — DEC. 28, 1813
PATENT — APRIL 22, 1815
TO — JAMES BUCHANAN (in Trust)
H — 12 — 422</p> | <p>②
V — 122 — 122
JOHN BLAIR (in Trust)
422 ACRES — 19 PERCHES & AIL.
WARRANT — JUNE 23, 1813
SURVEY — DEC. 28, 1813
MASTER</p> | <p>②A
B — 10 — 79
JOHN BLAIR (in Trust)
322 ACRES — 49 PERCHES & AIL.
PART OF LARGER TRACT
WARRANT — JUNE 23, 1813
SURVEY — NOV. 23, 1815
PATENT — MAY 31, 1817
TO — CHARLES MACALESTER (Trustee)
H — 70 — 435</p> |
| <p>③
A — 54 — 156
B — 6 — 103
WILLIAM FORSYTH
324 ACRES — 4 PERCHES & AIL.
WARRANT — DEC. 27, 1815
APPL. DATE — AUG. 1, 1766
SURVEY — NO. DATE GIVEN
MASTER</p> | <p>③A
C — 435 — 435
THOMAS BLAIR
422 ACRES — 16 PERCHES & AIL.
WARRANT — JAN. 16, 1790
SURVEY — MARCH 10, 1794
MASTER</p> | <p>③B
C — 11 — 277
GEORGE BUCHANAN
322 ACRES — 49 PERCHES & AIL.
PART OF LARGER TRACT
WARRANT — JULY 12, 1824
RE-SURVEY — APRIL 1, 1824
PATENT — JULY 12, 1824
TO — GEORGE BUCHANAN
H — 22 — 37</p> |
| <p>④
A — 89 — 263
MICHAEL WILT
422 ACRES — 31 PERCHES & AIL.
WARRANT — DEC. 27, 1815
SURVEY — JAN. 15, 1816
PATENT — FEB. 4, 1815
TO — MICHAEL WILT
H — 31 — 326</p> | <p>④
C — 165 — 200
JEREMIAH PARKER
422 ACRES — 30 PERCHES & AIL.
WARRANT — MARCH 10, 1794
SURVEY — AUG. 12, 1794
MASTER</p> | <p>④A
B — 16 — 223
JEREMIAH PARKER
222 ACRES — 30 PERCHES & AIL.
PART OF LARGER TRACT
WARRANT — MARCH 10, 1794
SURVEY — DEC. 27, 1815
PATENT — MAY 31, 1817
TO — CHARLES MACALESTER (Trustee)
H — 70 — 434</p> |
| <p>⑤B
C — 165 — 197
JEREMIAH PARKER
422 ACRES — 30 PERCHES & AIL.
PART OF LARGER TRACT
WARRANT — MARCH 10, 1794
SURVEY — JAN. 19, 1812
PATENT — APRIL 10, 1812
TO — ELIZABETH WILT
H — 31 — 318</p> | <p>⑥
C — 118 — 125
CHRISTIAN LINGENFELTER
422 ACRES — 79 PERCHES & AIL.
WARRANT — MAY 24, 1815
SURVEY — JUNE 10, 1815
PATENT — MARCH 14, 1831
TO — CHRISTIAN LINGENFELTER
H — 30 — 150</p> | <p>⑦
A — 4 — 35
JAMES C. FISHER
422 ACRES — 30 PERCHES & AIL.
WARRANT — MARCH 10, 1794
SURVEY — AUG. 12, 1794
PATENT — MAY 13, 1809
TO — JOHN SKYRIN
H — 35 — 35
"Woodstock"</p> |
| <p>⑧
A — 4 — 34
SAMUEL W. FISHER
422 ACRES — 30 PERCHES & AIL.
WARRANT — MARCH 10, 1794
SURVEY — AUG. 12, 1794
PATENT — MAY 12, 1809
TO — JOHN SKYRIN
H — 35 — 34
"Mount Hope"</p> | <p>⑨
A — 10 — 135
PHINEAS BOND, JR.
322 ACRES & AIL.
APPL. NO. 12 (WEST SIDE)
APPL. DATE — AUG. 1, 1766
WARRANT (cont.) — JULY 30, 1788
TO — WILLIAM BOND (Admin.)
SURVEY — NOV. 19, 1788
PATENT — AUG. 6, 1788
TO — WILLIAM BOND (Admin. in Trust)
H — 13 — 81
"Greenfield"</p> | |

A CONNECTED DRAFT of fourteen (14) tracts of land, which when surveyed, we situate as follows: two (2) partly in Allegheny Township, Huntingdon County and Greenfield Township, Bedford County; three (3) in Juniata Township, Blair County; two (2) in the Middle or Beaver Dam Branch of the Frankstown Creek, Cumberland County; two (2) in Allegheny Township, Huntingdon County; two (2) in Greenfield Township, Bedford County; three (3) in Woodbury Township, Bedford County. The draft has been constructed from and compared with the original drafts on file in the Bureau of Land Records, Department of Community Affairs, Commonwealth of Pennsylvania, under the direction of Edward D. Price, Director.

IN TESTIMONY WHEREOF: I have hereunto set my hand and caused the seal of the said Department to be affixed at Harrisburg, Pennsylvania, this fiftieth day of October A.D., one thousand nine hundred and eighty.

SHIRLEY M. DENNIS
Secretary of Community Affairs



By: *William A. Hawkins*
WILLIAM A. HAWKINS, Executive Deputy Secretary

1388