

NOTE: THE PART MARKED (A) IS SAID TO BE CLAIMED BY THE HEIRS OF JAMES BICKHAM DECEASED. So Says John Davies Deputy Surveyor April 20th & 21st 1830

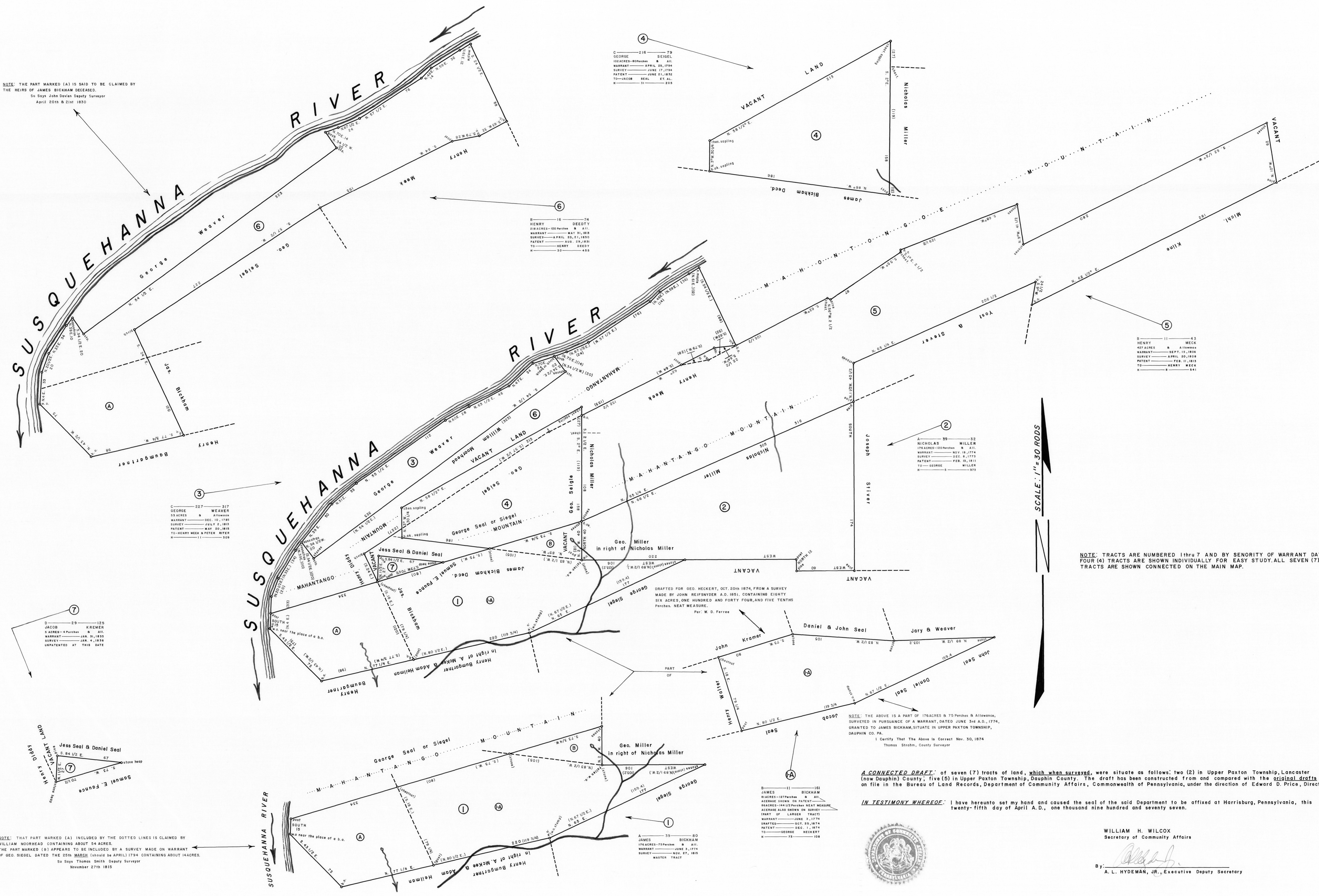

4
 C 216 79
 GEORGE SEIGEL
 100 ACRES - 80 PARCELS
 WARRANT - APRIL 25, 1794
 SURVEY - JUNE 17, 1794
 PATENT - JUNE 21, 1832
 TO - JACOB SEAL ET AL
 H 31 208

6
 B 16 74
 HENRY DEEDY
 218 ACRES - 100 PARCELS
 WARRANT - MAY 31, 1810
 SURVEY - APRIL 20, 1830
 PATENT - AUG 29, 1830
 TO - HENRY GREY
 H 50 488

5
 B 11 43
 HENRY MECK
 427 ACRES - 8 ALLOTTMENTS
 WARRANT - SEPT. 15, 1808
 SURVEY - APRIL 20, 1808
 PATENT - FEB. 11, 1813
 TO - HENRY MECK
 H 8 541

2
 A 39 32
 NICHOLAS MILLER
 176 ACRES - 100 PARCELS
 WARRANT - NOV. 18, 1774
 SURVEY - DEC. 8, 1773
 PATENT - FEB. 10, 1811
 TO - GEORGE MILLER
 H 5 373

3
 C 227 317
 GEORGE WEAVER
 33 ACRES - 8 ALLOTTMENTS
 WARRANT - DEC. 10, 1785
 SURVEY - JULY 2, 1813
 PATENT - MAY 20, 1815
 TO - HENRY MECK & PETER RITER
 H 11 309

7
 D 29 125
 JACOB KREMER
 5 ACRES - 4 PARCELS
 WARRANT - JAN. 31, 1835
 SURVEY - JAN. 4, 1836
 UNPATENTED AT THIS DATE

7
 Jess Seal & Daniel Seal
 5.84 1/2 E.
 67
 Samuel E. Founce
 70 1/2

NOTE: THAT PART MARKED (A) INCLUDED BY THE DOTTED LINES IS CLAIMED BY WILLIAM MOORHEAD CONTAINING ABOUT 54 ACRES. THE PART MARKED (B) APPEARS TO BE INCLUDED BY A SURVEY MADE ON WARRANT OF GEO. SIEGEL DATED THE 20th MARCH (should be APRIL) 1794 CONTAINING ABOUT 10 ACRES. So Says Thomas Smith Deputy Surveyor November 27th 1815

A
 B 39 80
 JAMES BICKHAM
 176 ACRES - 75 PARCELS & ALL
 WARRANT - JUNE 3, 1774
 SURVEY - NOV. 27, 1815
 MASTER TRACT

NOTE: THE ABOVE IS A PART OF 176 ACRES & 75 PARCELS & ALLOTTMENTS, SURVEYED IN PURSUANCE OF A WARRANT, DATED JUNE 3d A.D. 1774, GRANTED TO JAMES BICKHAM, SITUATE IN UPPER PAXTON TOWNSHIP, DAUPHIN CO. PA.
 I Certify That The Above is Correct Nov. 30, 1874
 Thomas Strohm, County Surveyor

A CONNECTED DRAFT: of seven (7) tracts of land, which when surveyed, were situate as follows: two (2) in Upper Paxton Township, Lancaster (now Dauphin) County; five (5) in Upper Paxton Township, Dauphin County. The draft has been constructed from and compared with the original drafts on file in the Bureau of Land Records, Department of Community Affairs, Commonwealth of Pennsylvania, under the direction of Edward D. Price, Director.

IN TESTIMONY WHEREOF: I have hereunto set my hand and caused the seal of the said Department to be affixed at Harrisburg, Pennsylvania, this twenty-fifth day of April A.D., one thousand nine hundred and seventy seven.



WILLIAM H. WILCOX
 Secretary of Community Affairs
 By: *[Signature]*
 A. L. HYDEMAN, JR., Executive Deputy Secretary

SCALE: 1" = 30 RODS

NOTE: TRACTS ARE NUMBERED 1 thru 7 AND BY SENIORITY OF WARRANT DATE. FOUR (4) TRACTS ARE SHOWN INDIVIDUALLY FOR EASY STUDY. ALL SEVEN (7) TRACTS ARE SHOWN CONNECTED ON THE MAIN MAP.