

SUGAR GROVE TWP.

WEST SALEM TWP. OTTER CREEK TWP. DELAWARE TWP.

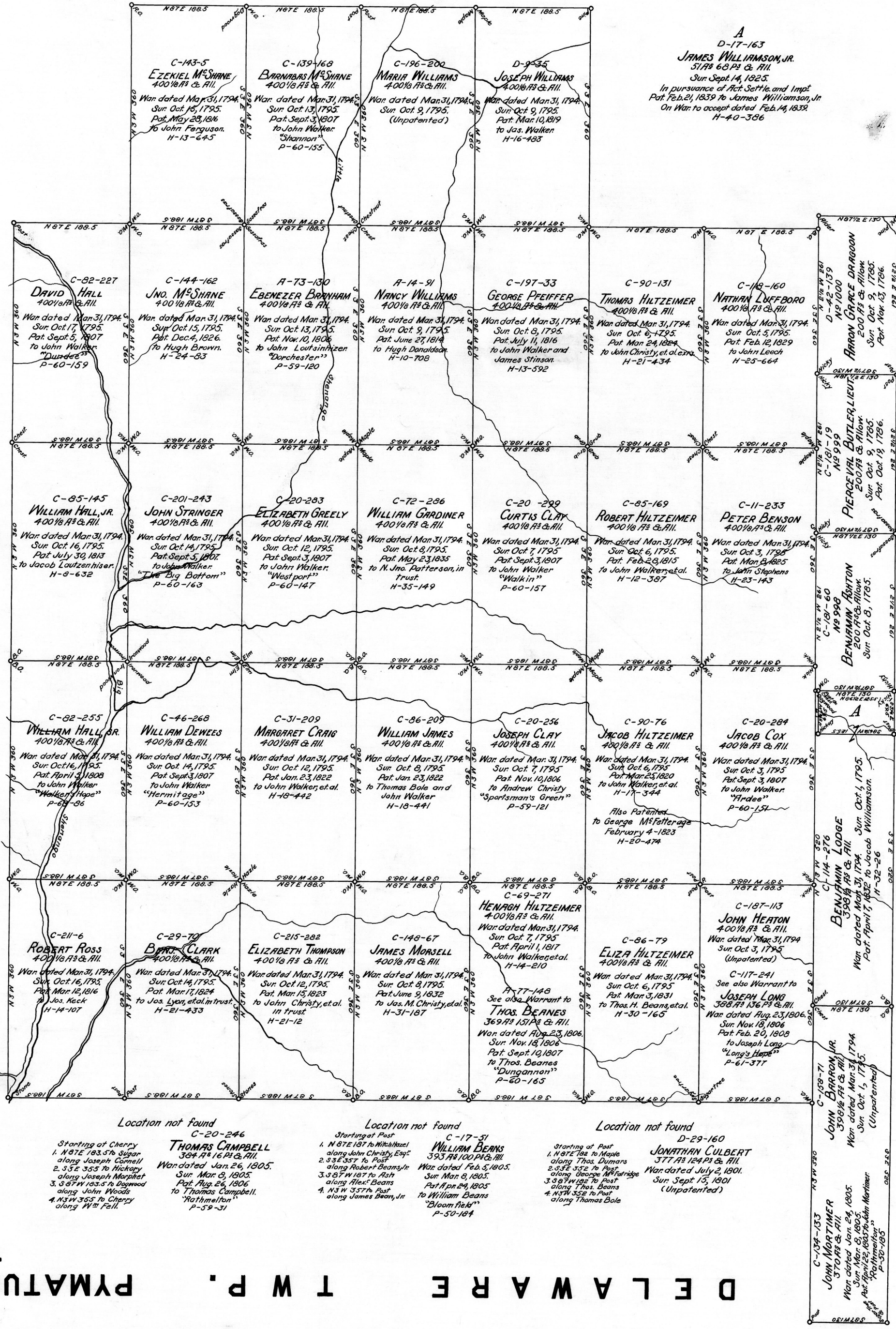

A
D-17-163
JAMES WILLIAMSON, JR.
377 AS 124 P3 & All.
Sur. Sept. 14, 1825.
In pursuance of Act. Sett. and Imp.
Pat. Feb. 21, 1839 to James Williamson, Jr.
On War. to accept dated Feb. 14, 1839.
H-40-386

Location not found
C-20-246
Starting of Cherry
1. N 87 E 183.5 Sugar
along Joseph Cornell
2. S 3 E 35 S to Hickory
along Joseph Marshall
3. S 87 W 183.5 to Deomed
along John Woods
4. N 3 W 35 S to Cherry
along W B Fell.

Location not found
C-17-51
Starting at Post
1. N 87 E 187 to Mitchell
along John Christy, Esq.
2. S 8 E 35 S to Post
along Robert Deans, Jr.
3. S 87 W 187 to Ash
along Alex Beams
4. N 3 W 35 S to Post
along James Beas, Jr.
along William Beas
"Bloom field"
P-50-184

Location not found
D-29-160
Starting at Post
1. N 87 E 183 to Maple
along Thos. Dumars
2. S 8 E 35 S to Post
along George W. Faridge
3. S 87 W 187 to Post
along Thos. Beas
4. N 3 W 35 S to Post
along Thomas Bale

A Connected Draft of the tracts of land situated in Hempfield Township, Mercer County, The War
rants, surveys, and patents bearing dates respectively as above set forth, constructed from and compared
with the original drafts remaining on file in the Department of Internal Affairs of Pennsylvania,
under the direction of Daniel J. Daniel, Director of the Land Office
In testimony whereof, I have hereunto set my hand and caused the Seal of the said Department
to be affixed at Harrisburg this nineteenth day of March, A. D. 1942.

William S. ...
Secretary of Internal Affairs