

U  
N  
I  
T  
Y

C  
O  
N  
T  
A  
I  
N  
S

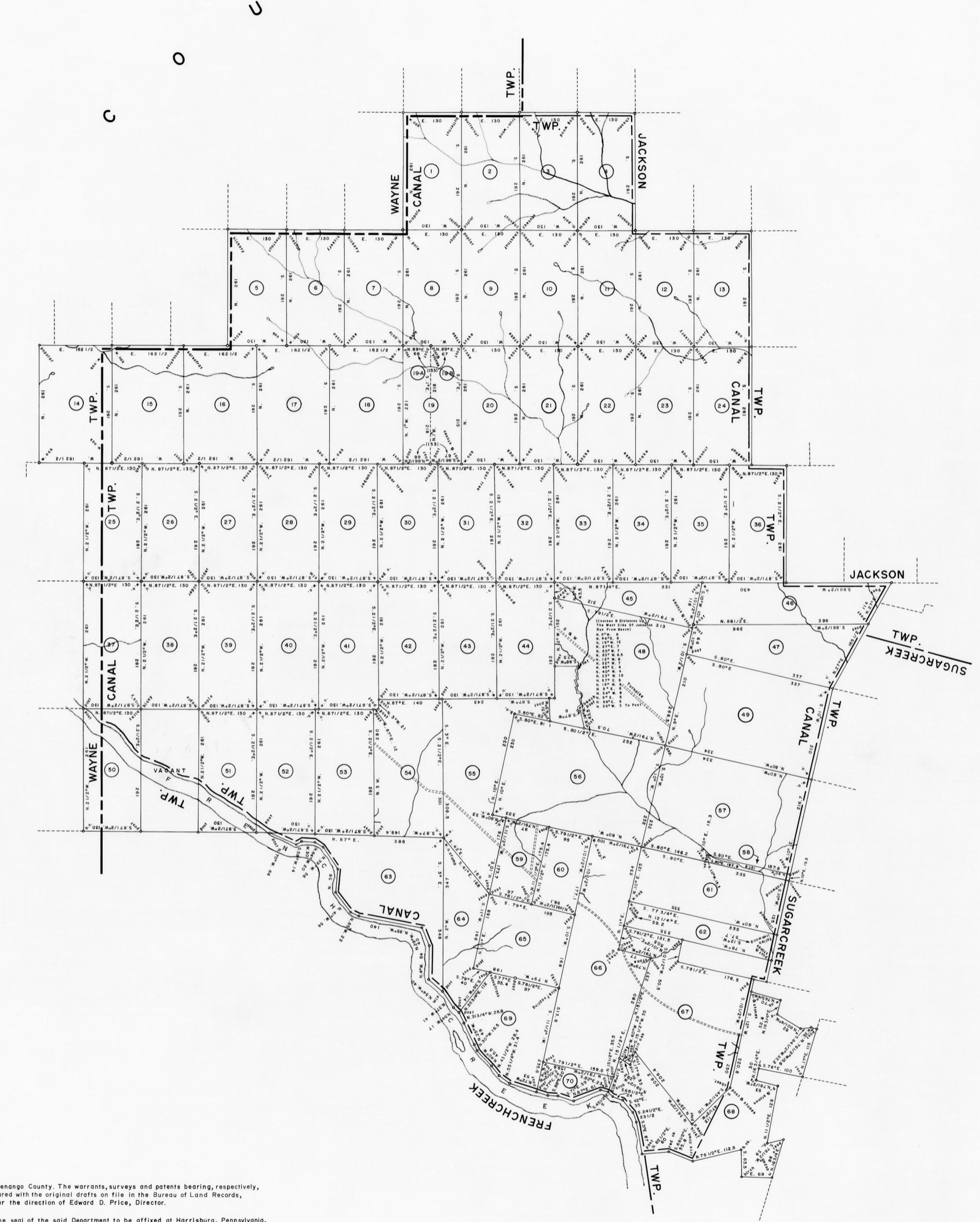

- 1 THOMAS LITTLE (Pvt) 200 ACRES & Allotment (ASSIGNEE OF) DONATION LANDS DATE OF ACT—FEB 24, 1785 PATENT—MAR 27, 1803 TO—THOMAS LITTLE "Limes Reave"
- 2 GEORGE THOMPSON (Pvt) 200 ACRES & Allotment (ASSIGNEE OF) DONATION LANDS DATE OF ACT—FEB 24, 1785 PATENT—OCT 17, 1788 TO—GEORGE THOMPSON
- 3 DANIEL BILLING (Pvt) 200 ACRES & Allotment (ASSIGNEE OF) DONATION LANDS DATE OF ACT—FEB 24, 1785 PATENT—OCT 17, 1788 TO—DANIEL BILLING
- 4 PETER B. AUGSBERT (ASSIGNEE OF) THOMAS BOYD (Pvt) 200 ACRES & Allotment (ASSIGNEE OF) DONATION LANDS DATE OF ACT—FEB 24, 1785 PATENT—MAR 12, 1785 TO—PETER B. AUGSBERT
- 5 HENRY GARDNER (Pvt) 200 ACRES & Allotment (ASSIGNEE OF) DONATION LANDS DATE OF ACT—FEB 24, 1785 PATENT—OCT 17, 1788 TO—HENRY GARDNER
- 6 THOMAS JONES (Pvt) 200 ACRES & Allotment (ASSIGNEE OF) DONATION LANDS DATE OF ACT—FEB 24, 1785 PATENT—DEC 2, 1785 TO—THOMAS JONES
- 7 JAMES M'PERSON (L) 200 ACRES & Allotment (ASSIGNEE OF) DONATION LANDS DATE OF ACT—FEB 24, 1785 PATENT—OCT 17, 1788 TO—JAMES M'PERSON
- 8 CHARLES MILLER (Pvt) 200 ACRES & Allotment (ASSIGNEE OF) DONATION LANDS DATE OF ACT—FEB 24, 1785 PATENT—OCT 17, 1788 TO—CHARLES MILLER
- 9 SAMUEL BENEZET (ASSIGNEE OF) ROBERT GARRET (Pvt) 200 ACRES & Allotment (ASSIGNEE OF) DONATION LANDS DATE OF ACT—FEB 24, 1785 PATENT—OCT 17, 1788 TO—SAMUEL BENEZET
- 10 JOSEPH THOMPSON (Pvt) 200 ACRES & Allotment (ASSIGNEE OF) DONATION LANDS DATE OF ACT—FEB 24, 1785 PATENT—OCT 17, 1788 TO—JOSEPH THOMPSON
- 11 JOHN KILLON (Pvt) 200 ACRES & Allotment (ASSIGNEE OF) DONATION LANDS DATE OF ACT—FEB 24, 1785 PATENT—OCT 17, 1788 TO—JOHN KILLON
- 12 JOSEPH ROWLAND (Pvt) 200 ACRES & Allotment (ASSIGNEE OF) DONATION LANDS DATE OF ACT—FEB 24, 1785 PATENT—OCT 17, 1788 TO—JOSEPH ROWLAND
- 13 MURRAY FRANCIS (ASSIGNEE OF) WILLIAM WILSON (Pvt) 200 ACRES & Allotment (ASSIGNEE OF) DONATION LANDS DATE OF ACT—FEB 24, 1785 PATENT—OCT 17, 1788 TO—MURRAY FRANCIS
- 14 MURRAY FRANCIS (ASSIGNEE OF) WILLIAM WILSON (Pvt) 200 ACRES & Allotment (ASSIGNEE OF) DONATION LANDS DATE OF ACT—FEB 24, 1785 PATENT—OCT 17, 1788 TO—MURRAY FRANCIS
- 15 WILLIAM MCCONNELL (Pvt) 200 ACRES & Allotment (ASSIGNEE OF) DONATION LANDS DATE OF ACT—FEB 24, 1785 PATENT—OCT 17, 1788 TO—WILLIAM MCCONNELL
- 16 HUGH THOMPSON (Pvt) 200 ACRES & Allotment (ASSIGNEE OF) DONATION LANDS DATE OF ACT—FEB 24, 1785 PATENT—OCT 17, 1788 TO—HUGH THOMPSON
- 17 ELIZABETH LUDWICK (WIDOW OF) JOHN M. LUDWICK 200 ACRES & Allotment (ASSIGNEE OF) DONATION LANDS DATE OF ACT—FEB 24, 1785 PATENT—OCT 17, 1788 TO—ELIZABETH LUDWICK & OTHERS IN TRUST
- 18 THOMAS JONES (Pvt) 200 ACRES & Allotment (ASSIGNEE OF) DONATION LANDS DATE OF ACT—FEB 24, 1785 PATENT—OCT 17, 1788 TO—THOMAS JONES
- 19 JOSEPH DEETTS & JAMES Mc BRIDE (Part of Larger Tract) 200 ACRES & Allotment (ASSIGNEE OF) DONATION LANDS DATE OF ACT—FEB 24, 1785 PATENT—OCT 17, 1788 TO—JOSEPH DEETTS & JAMES Mc BRIDE
- 20 CHRISTIAN HUFFMAN (Pvt) 200 ACRES & Allotment (ASSIGNEE OF) DONATION LANDS DATE OF ACT—FEB 24, 1785 PATENT—OCT 17, 1788 TO—CHRISTIAN HUFFMAN
- 21 MICHAEL SHAW (Pvt) 200 ACRES & Allotment (ASSIGNEE OF) DONATION LANDS DATE OF ACT—FEB 24, 1785 PATENT—OCT 17, 1788 TO—MICHAEL SHAW
- 22 NICHOLAS HACKETT (Pvt) 200 ACRES & Allotment (ASSIGNEE OF) DONATION LANDS DATE OF ACT—FEB 24, 1785 PATENT—OCT 17, 1788 TO—NICHOLAS HACKETT
- 23 THOMAS BUTTS (Pvt) 200 ACRES & Allotment (ASSIGNEE OF) DONATION LANDS DATE OF ACT—FEB 24, 1785 PATENT—OCT 17, 1788 TO—THOMAS BUTTS
- 24 JOHN SMITH (Pvt) 200 ACRES & Allotment (ASSIGNEE OF) DONATION LANDS DATE OF ACT—FEB 24, 1785 PATENT—OCT 17, 1788 TO—JOHN SMITH
- 25 MICHAEL SHAW (Pvt) 200 ACRES & Allotment (ASSIGNEE OF) DONATION LANDS DATE OF ACT—FEB 24, 1785 PATENT—OCT 17, 1788 TO—MICHAEL SHAW
- 26 JOHN NICHOLSON (Pvt) 200 ACRES & Allotment (ASSIGNEE OF) DONATION LANDS DATE OF ACT—FEB 24, 1785 PATENT—OCT 17, 1788 TO—JOHN NICHOLSON
- 27 JOHN SMITH (Pvt) 200 ACRES & Allotment (ASSIGNEE OF) DONATION LANDS DATE OF ACT—FEB 24, 1785 PATENT—OCT 17, 1788 TO—JOHN SMITH
- 28 JOHN NICHOLSON (Pvt) 200 ACRES & Allotment (ASSIGNEE OF) DONATION LANDS DATE OF ACT—FEB 24, 1785 PATENT—OCT 17, 1788 TO—JOHN NICHOLSON
- 29 JOHN SMITH (Pvt) 200 ACRES & Allotment (ASSIGNEE OF) DONATION LANDS DATE OF ACT—FEB 24, 1785 PATENT—OCT 17, 1788 TO—JOHN SMITH
- 30 JOHN NICHOLSON (Pvt) 200 ACRES & Allotment (ASSIGNEE OF) DONATION LANDS DATE OF ACT—FEB 24, 1785 PATENT—OCT 17, 1788 TO—JOHN NICHOLSON
- 31 JOHN SMITH (Pvt) 200 ACRES & Allotment (ASSIGNEE OF) DONATION LANDS DATE OF ACT—FEB 24, 1785 PATENT—OCT 17, 1788 TO—JOHN SMITH
- 32 JOHN NICHOLSON (Pvt) 200 ACRES & Allotment (ASSIGNEE OF) DONATION LANDS DATE OF ACT—FEB 24, 1785 PATENT—OCT 17, 1788 TO—JOHN NICHOLSON
- 33 JOHN SMITH (Pvt) 200 ACRES & Allotment (ASSIGNEE OF) DONATION LANDS DATE OF ACT—FEB 24, 1785 PATENT—OCT 17, 1788 TO—JOHN SMITH
- 34 JOHN NICHOLSON (Pvt) 200 ACRES & Allotment (ASSIGNEE OF) DONATION LANDS DATE OF ACT—FEB 24, 1785 PATENT—OCT 17, 1788 TO—JOHN NICHOLSON
- 35 JOHN SMITH (Pvt) 200 ACRES & Allotment (ASSIGNEE OF) DONATION LANDS DATE OF ACT—FEB 24, 1785 PATENT—OCT 17, 1788 TO—JOHN SMITH
- 36 JOHN NICHOLSON (Pvt) 200 ACRES & Allotment (ASSIGNEE OF) DONATION LANDS DATE OF ACT—FEB 24, 1785 PATENT—OCT 17, 1788 TO—JOHN NICHOLSON
- 37 JOHN SMITH (Pvt) 200 ACRES & Allotment (ASSIGNEE OF) DONATION LANDS DATE OF ACT—FEB 24, 1785 PATENT—OCT 17, 1788 TO—JOHN SMITH
- 38 JOHN NICHOLSON (Pvt) 200 ACRES & Allotment (ASSIGNEE OF) DONATION LANDS DATE OF ACT—FEB 24, 1785 PATENT—OCT 17, 1788 TO—JOHN NICHOLSON
- 39 JOHN SMITH (Pvt) 200 ACRES & Allotment (ASSIGNEE OF) DONATION LANDS DATE OF ACT—FEB 24, 1785 PATENT—OCT 17, 1788 TO—JOHN SMITH
- 40 JOHN NICHOLSON (Pvt) 200 ACRES & Allotment (ASSIGNEE OF) DONATION LANDS DATE OF ACT—FEB 24, 1785 PATENT—OCT 17, 1788 TO—JOHN NICHOLSON
- 41 JOHN SMITH (Pvt) 200 ACRES & Allotment (ASSIGNEE OF) DONATION LANDS DATE OF ACT—FEB 24, 1785 PATENT—OCT 17, 1788 TO—JOHN SMITH
- 42 JOHN NICHOLSON (Pvt) 200 ACRES & Allotment (ASSIGNEE OF) DONATION LANDS DATE OF ACT—FEB 24, 1785 PATENT—OCT 17, 1788 TO—JOHN NICHOLSON
- 43 JOHN SMITH (Pvt) 200 ACRES & Allotment (ASSIGNEE OF) DONATION LANDS DATE OF ACT—FEB 24, 1785 PATENT—OCT 17, 1788 TO—JOHN SMITH
- 44 JOHN NICHOLSON (Pvt) 200 ACRES & Allotment (ASSIGNEE OF) DONATION LANDS DATE OF ACT—FEB 24, 1785 PATENT—OCT 17, 1788 TO—JOHN NICHOLSON
- 45 JOHN SMITH (Pvt) 200 ACRES & Allotment (ASSIGNEE OF) DONATION LANDS DATE OF ACT—FEB 24, 1785 PATENT—OCT 17, 1788 TO—JOHN SMITH
- 46 JOHN NICHOLSON (Pvt) 200 ACRES & Allotment (ASSIGNEE OF) DONATION LANDS DATE OF ACT—FEB 24, 1785 PATENT—OCT 17, 1788 TO—JOHN NICHOLSON
- 47 JOHN SMITH (Pvt) 200 ACRES & Allotment (ASSIGNEE OF) DONATION LANDS DATE OF ACT—FEB 24, 1785 PATENT—OCT 17, 1788 TO—JOHN SMITH
- 48 JOHN NICHOLSON (Pvt) 200 ACRES & Allotment (ASSIGNEE OF) DONATION LANDS DATE OF ACT—FEB 24, 1785 PATENT—OCT 17, 1788 TO—JOHN NICHOLSON
- 49 JOHN SMITH (Pvt) 200 ACRES & Allotment (ASSIGNEE OF) DONATION LANDS DATE OF ACT—FEB 24, 1785 PATENT—OCT 17, 1788 TO—JOHN SMITH
- 50 JOHN NICHOLSON (Pvt) 200 ACRES & Allotment (ASSIGNEE OF) DONATION LANDS DATE OF ACT—FEB 24, 1785 PATENT—OCT 17, 1788 TO—JOHN NICHOLSON
- 51 JOHN SMITH (Pvt) 200 ACRES & Allotment (ASSIGNEE OF) DONATION LANDS DATE OF ACT—FEB 24, 1785 PATENT—OCT 17, 1788 TO—JOHN SMITH
- 52 JOHN NICHOLSON (Pvt) 200 ACRES & Allotment (ASSIGNEE OF) DONATION LANDS DATE OF ACT—FEB 24, 1785 PATENT—OCT 17, 1788 TO—JOHN NICHOLSON
- 53 JOHN SMITH (Pvt) 200 ACRES & Allotment (ASSIGNEE OF) DONATION LANDS DATE OF ACT—FEB 24, 1785 PATENT—OCT 17, 1788 TO—JOHN SMITH
- 54 JOHN NICHOLSON (Pvt) 200 ACRES & Allotment (ASSIGNEE OF) DONATION LANDS DATE OF ACT—FEB 24, 1785 PATENT—OCT 17, 1788 TO—JOHN NICHOLSON
- 55 JOHN SMITH (Pvt) 200 ACRES & Allotment (ASSIGNEE OF) DONATION LANDS DATE OF ACT—FEB 24, 1785 PATENT—OCT 17, 1788 TO—JOHN SMITH
- 56 JOHN NICHOLSON (Pvt) 200 ACRES & Allotment (ASSIGNEE OF) DONATION LANDS DATE OF ACT—FEB 24, 1785 PATENT—OCT 17, 1788 TO—JOHN NICHOLSON
- 57 JOHN SMITH (Pvt) 200 ACRES & Allotment (ASSIGNEE OF) DONATION LANDS DATE OF ACT—FEB 24, 1785 PATENT—OCT 17, 1788 TO—JOHN SMITH
- 58 JOHN NICHOLSON (Pvt) 200 ACRES & Allotment (ASSIGNEE OF) DONATION LANDS DATE OF ACT—FEB 24, 1785 PATENT—OCT 17, 1788 TO—JOHN NICHOLSON
- 59 JOHN SMITH (Pvt) 200 ACRES & Allotment (ASSIGNEE OF) DONATION LANDS DATE OF ACT—FEB 24, 1785 PATENT—OCT 17, 1788 TO—JOHN SMITH
- 60 JOHN NICHOLSON (Pvt) 200 ACRES & Allotment (ASSIGNEE OF) DONATION LANDS DATE OF ACT—FEB 24, 1785 PATENT—OCT 17, 1788 TO—JOHN NICHOLSON
- 61 JOHN SMITH (Pvt) 200 ACRES & Allotment (ASSIGNEE OF) DONATION LANDS DATE OF ACT—FEB 24, 1785 PATENT—OCT 17, 1788 TO—JOHN SMITH
- 62 JOHN NICHOLSON (Pvt) 200 ACRES & Allotment (ASSIGNEE OF) DONATION LANDS DATE OF ACT—FEB 24, 1785 PATENT—OCT 17, 1788 TO—JOHN NICHOLSON
- 63 JOHN SMITH (Pvt) 200 ACRES & Allotment (ASSIGNEE OF) DONATION LANDS DATE OF ACT—FEB 24, 1785 PATENT—OCT 17, 1788 TO—JOHN SMITH
- 64 JOHN NICHOLSON (Pvt) 200 ACRES & Allotment (ASSIGNEE OF) DONATION LANDS DATE OF ACT—FEB 24, 1785 PATENT—OCT 17, 1788 TO—JOHN NICHOLSON
- 65 JOHN SMITH (Pvt) 200 ACRES & Allotment (ASSIGNEE OF) DONATION LANDS DATE OF ACT—FEB 24, 1785 PATENT—OCT 17, 1788 TO—JOHN SMITH
- 66 JOHN NICHOLSON (Pvt) 200 ACRES & Allotment (ASSIGNEE OF) DONATION LANDS DATE OF ACT—FEB 24, 1785 PATENT—OCT 17, 1788 TO—JOHN NICHOLSON
- 67 JOHN SMITH (Pvt) 200 ACRES & Allotment (ASSIGNEE OF) DONATION LANDS DATE OF ACT—FEB 24, 1785 PATENT—OCT 17, 1788 TO—JOHN SMITH
- 68 JOHN NICHOLSON (Pvt) 200 ACRES & Allotment (ASSIGNEE OF) DONATION LANDS DATE OF ACT—FEB 24, 1785 PATENT—OCT 17, 1788 TO—JOHN NICHOLSON
- 69 JOHN SMITH (Pvt) 200 ACRES & Allotment (ASSIGNEE OF) DONATION LANDS DATE OF ACT—FEB 24, 1785 PATENT—OCT 17, 1788 TO—JOHN SMITH
- 70 JOHN NICHOLSON (Pvt) 200 ACRES & Allotment (ASSIGNEE OF) DONATION LANDS DATE OF ACT—FEB 24, 1785 PATENT—OCT 17, 1788 TO—JOHN NICHOLSON

A CONNECTED WARRANT TOWNSHIP MAP of Canal Township in Venango County. The warrants, surveys and patents bearing, respectively, the dates as above set forth, are constructed from and have been compared with the original drafts on file in the Bureau of Land Records, Department of Community Affairs, Commonwealth of Pennsylvania, under the direction of Edward D. Price, Director.

IN TESTIMONY WHEREOF: I have hereunto set my hand and caused the seal of the said Department to be affixed at Harrisburg, Pennsylvania, this ninth day of June A.D., one thousand nine hundred and seventy-one.

*William H. Price*  
Secretary of Community Affairs

