

In the NAME and by the AUTHORITY of

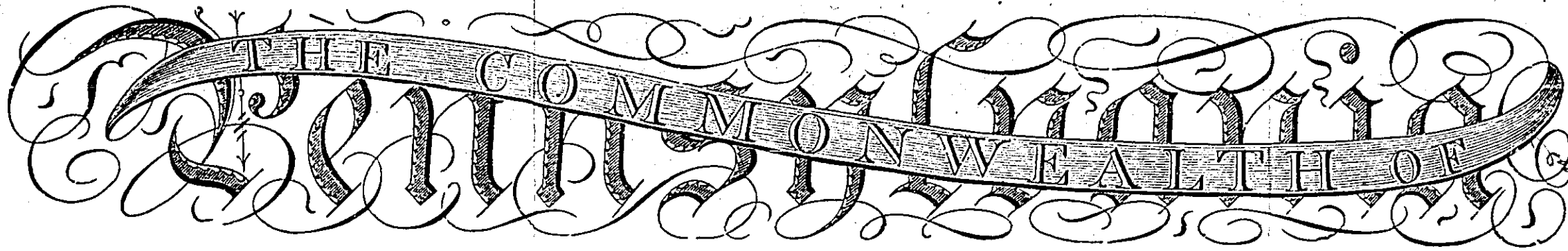

THOMAS MIFFLIN,

GOVERNOR of the said Commonwealth,

To all to whom these Presents shall come, Greeting:

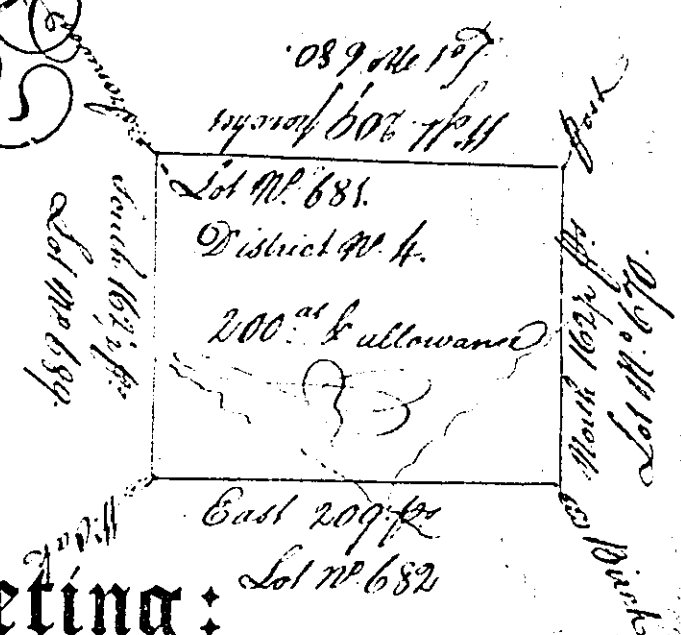

Printed by F. Bailey.

Know ye, That in consideration of the services rendered by James O'Neal Private in the army of the United States there is granted by the said commonwealth unto Clement Biddle Esquire Assignee of Alexander Power who was Assignee of Thomas O'Hern Administrator of the said James O'Neal

a certain tract or parcel of land lying in the county of Allegheny on the west side of the Allegheny River in the fourth donation district bounded and described as follows viz: beginning at an Ironwood tree and running South by lot number 689 one hundred and sixty two and a half perches to a white oak tree thence east by lot number 682 two hundred and nine perches to a birch tree thence north by lot number 670 one hundred and sixty two and a half perches to a post thence West by lot number 680 two hundred and nine perches to an Ironwood tree the place of beginning and numbered corner containing two hundred acres and the usual allowance of six acres per cent. for roads &c. numbered among lots in the said district DCLXXXI

To have and to hold the said tract or parcel of land, with the appurtenances, unto the said Clement Biddle his heirs and assigns To and for his and their own proper Use and Benefit forever

free and clear of all restrictions and reservations as to mines, royalties, quit-rents or otherwise, excepting and reserving only the fifth part of all gold and silver ore for the use of this commonwealth, to be delivered at the pit's mouth clear of all charges. In Testimony whereof I have set my Hand, and caused the great Seal of the State to be affixed to these Presents, at Philadelphia, this tenth day of March in the year of our Lord one thousand seven hundred and ninety-five and of the commonwealth the Nineteenth

By the Governor,

A. J. Dallas  
Secretary