

Scale: 1" = 80 Rods

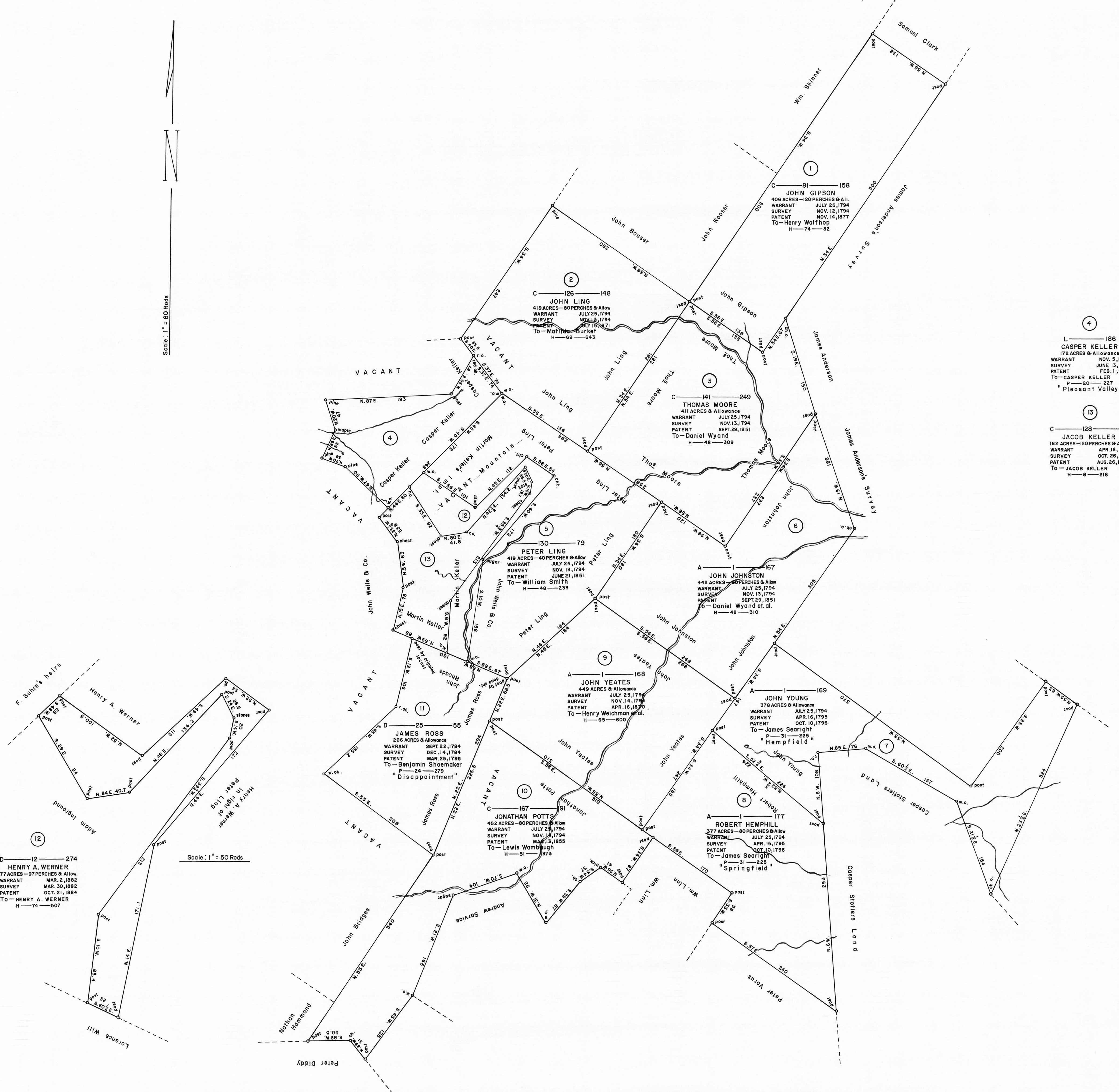

④
L—186
CASPER KELLER
172 ACRES & Allowance
WARRANT NOV. 5, 1792
SURVEY JUNE 13, 1793
PATENT FEB. 1, 1794
To—CASPER KELLER
P—20—227
"Pleasant Valley"

⑬
C—128—58
JACOB KELLER
162 ACRES—120 PERCHES & Allow
WARRANT APR. 18, 1810
SURVEY OCT. 26, 1810
PATENT AUG. 26, 1812
To—JACOB KELLER
H—8—218

⑫
D—12—274
HENRY A. WERNER
77 ACRES—87 PERCHES & Allow
WARRANT MAR. 2, 1862
SURVEY MAR. 30, 1862
PATENT OCT. 21, 1864
To—HENRY A. WERNER
H—74—507

A CONNECTED DRAFT of thirteen (13) tracts of land which, when surveyed, were situate as follows: seven (7) in Allegheny Township; four (4) in Bedford Township; and two (2) on Stony Creek in Bedford (now Somerset) County. The draft has been constructed from and compared with the original drafts on file in the Bureau of Land Records, Department of Community Affairs, Commonwealth of Pennsylvania, under the direction of Edward D. Price, Acting Director. IN TESTIMONY WHEREOF: I have hereunto set my hand and caused the seal of the said Department to be affixed at Harrisburg, Pennsylvania this first day of October A. D., one thousand nine hundred and seventy.

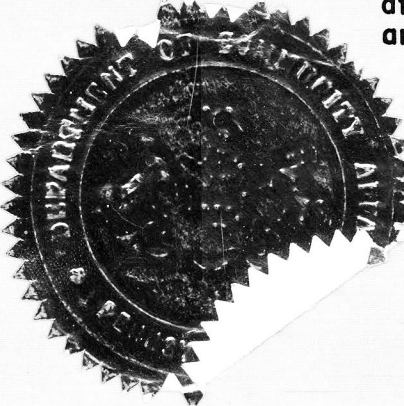

JOSEPH W. BARR, JR.
Secretary of Community Affairs

By: *Daniel Rogers*
DANIEL ROGERS, Deputy Secretary

1639

jmw