

COURSES AND DISTANCES
 14 S 87° E 80 P TO A MOUNTAIN
 20 S 87° E 80 P TO A MOUNTAIN
 34 S 87° E 80 P TO A MOUNTAIN
 40 S 87° E 80 P TO A MOUNTAIN
 80 S 87° E 80 P TO A MOUNTAIN
 80 S 87° E 80 P TO A MOUNTAIN

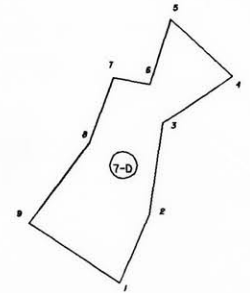

COURSES AND DISTANCES
 14 S 87° E 80 P TO A MOUNTAIN
 20 S 87° E 80 P TO A MOUNTAIN
 34 S 87° E 80 P TO A MOUNTAIN
 40 S 87° E 80 P TO A MOUNTAIN
 80 S 87° E 80 P TO A MOUNTAIN
 80 S 87° E 80 P TO A MOUNTAIN

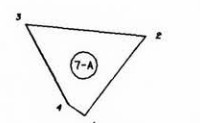

COURSES AND DISTANCES
 14 S 87° E 80 P TO A MOUNTAIN
 20 S 87° E 80 P TO A MOUNTAIN
 34 S 87° E 80 P TO A MOUNTAIN
 40 S 87° E 80 P TO A MOUNTAIN
 80 S 87° E 80 P TO A MOUNTAIN
 80 S 87° E 80 P TO A MOUNTAIN

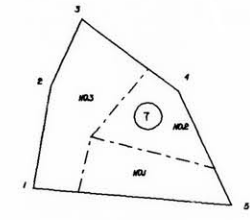

COURSES AND DISTANCES
 14 S 87° E 80 P TO A MOUNTAIN
 20 S 87° E 80 P TO A MOUNTAIN
 34 S 87° E 80 P TO A MOUNTAIN
 40 S 87° E 80 P TO A MOUNTAIN
 80 S 87° E 80 P TO A MOUNTAIN
 80 S 87° E 80 P TO A MOUNTAIN

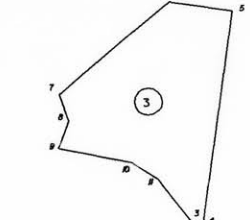

COURSES AND DISTANCES
 14 S 87° E 80 P TO A MOUNTAIN
 20 S 87° E 80 P TO A MOUNTAIN
 34 S 87° E 80 P TO A MOUNTAIN
 40 S 87° E 80 P TO A MOUNTAIN
 80 S 87° E 80 P TO A MOUNTAIN
 80 S 87° E 80 P TO A MOUNTAIN

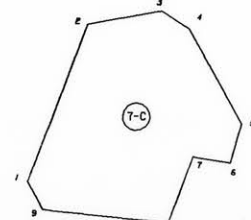

COURSES AND DISTANCES
 14 S 87° E 80 P TO A MOUNTAIN
 20 S 87° E 80 P TO A MOUNTAIN
 34 S 87° E 80 P TO A MOUNTAIN
 40 S 87° E 80 P TO A MOUNTAIN
 80 S 87° E 80 P TO A MOUNTAIN
 80 S 87° E 80 P TO A MOUNTAIN

A CONNECTED DRAFT of nine (9) tracts of land, which when surveyed, were situate as follows: five (5) on Standing Stone Creek, Cumberland County; two (2) on Standing Stone Creek, Huntingdon County; and two (2) in Barree Township, Huntingdon County, has been constructed from and compared with the original drafts on file in the Division of Land Records, Bureau of Archives and History, Historical and Museum Commission, Commonwealth of Pennsylvania, under the direction of Donna B. Munger, Chief.

IN TESTIMONY WHEREOF, I have hereunto set my hand and caused the seip of the said Commission to be affixed at Harrisburg, Pennsylvania, this ninth day of September, A.D., one thousand nine hundred and eighty-eight.

BRENT D. GLASS, Executive Director
 Historical and Museum Commission

By Harry E. Whiskey, Director,
 Bureau of Archives and History.

1
 A-38-236
 FARREL WADE
 BY AC. OF PA. ALM.
 WARRANT JAN. 1783
 SURVEY JULY 1786
 PATENT MAY 1803
 TO JOHN AND SARAH SMITH
 H-43-489

2
 C-64-296
 THOMAS GALLAGHER
 BY AC. OF PA. ALM.
 WARRANT JULY 1782
 SURVEY OCT. 1782
 PATENT MAR. 1783
 TO GEORGE GREEN
 H-10-381

3
 D-59-68
 JOHN STELL
 BY AC. OF PA. ALM.
 WARRANT NOV. 1786
 SURVEY JAN. 1787
 PATENT JULY 1787
 TO JAMES COY. ET. AL.
 H-52-500

4
 D-587
 MASTER JOHN CONEY
 BY AC. OF PA. ALM.
 WARRANT TO ACCEPT
 DATED MAR. 1785
 SURVEY APR. 1785
 PATENT APR. 1786
 TO JOHN COVENOVEN
 H-21-183

5
 C-42-99
 JOHN CHENEY
 BY AC. OF PA. ALM.
 WARRANT TO ACCEPT
 DATED MAR. 1785
 SURVEY APR. 1785
 PATENT APR. 1786
 TO JOHN CHENEY
 H-40-490

6
 A-19-39
 ANDREW BOGGS
 BY AC. OF PA. ALM.
 WARRANT TO ACCEPT
 DATED APR. 1785
 SURVEY NOV. 1786
 PATENT MAR. 1789
 TO JOHN COXE, ESQ.
 P-16-12
 "THE CONFLUENCE"

7
 B-21-82
 MATTHIAS LEAMAN
 BY AC. OF PA. ALM.
 WARRANT TO ACCEPT
 DATED APR. 1785
 SURVEY NOV. 1786
 PATENT MAR. 1789
 TO GEORGE GREEN
 H-10-381

8
 C-31-283
 JOHN GREGORY
 BY AC. OF PA. ALM.
 WARRANT TO ACCEPT
 DATED APR. 1785
 SURVEY APR. 1785
 PATENT APR. 1786
 TO JOHN COVENOVEN
 H-21-183

9
 A-66-106
 CHARLES RICKETS
 BY AC. OF PA. ALM.
 WARRANT TO ACCEPT
 DATED APR. 1785
 SURVEY NOV. 1786
 PATENT MAR. 1789
 TO JAMES COY. ET. AL.
 H-52-500

10
 D-6-285
 ISAAC WIKOFF
 BY AC. OF PA. ALM.
 WARRANT TO ACCEPT
 DATED APR. 1785
 SURVEY NOV. 1786
 PATENT MAR. 1789
 TO JOHN COXE
 P-16-23
 "PLEASANT VALE"

11
 A-19-41
 ANDREW BOGGS
 BY AC. OF PA. ALM.
 WARRANT TO ACCEPT
 DATED APR. 1785
 SURVEY NOV. 1786
 PATENT MAR. 1789
 TO JOHN COXE
 P-16-23
 "PLEASANT VALE"

12
 A-19-39
 ANDREW BOGGS
 BY AC. OF PA. ALM.
 WARRANT TO ACCEPT
 DATED APR. 1785
 SURVEY NOV. 1786
 PATENT MAR. 1789
 TO JOHN COXE
 P-16-23
 "PLEASANT VALE"

13
 A-19-41
 ANDREW BOGGS
 BY AC. OF PA. ALM.
 WARRANT TO ACCEPT
 DATED APR. 1785
 SURVEY NOV. 1786
 PATENT MAR. 1789
 TO JOHN COXE
 P-16-23
 "PLEASANT VALE"

14
 A-19-39
 ANDREW BOGGS
 BY AC. OF PA. ALM.
 WARRANT TO ACCEPT
 DATED APR. 1785
 SURVEY NOV. 1786
 PATENT MAR. 1789
 TO JOHN COXE
 P-16-23
 "PLEASANT VALE"

15
 A-19-41
 ANDREW BOGGS
 BY AC. OF PA. ALM.
 WARRANT TO ACCEPT
 DATED APR. 1785
 SURVEY NOV. 1786
 PATENT MAR. 1789
 TO JOHN COXE
 P-16-23
 "PLEASANT VALE"

16
 A-19-39
 ANDREW BOGGS
 BY AC. OF PA. ALM.
 WARRANT TO ACCEPT
 DATED APR. 1785
 SURVEY NOV. 1786
 PATENT MAR. 1789
 TO JOHN COXE
 P-16-23
 "PLEASANT VALE"

1542