

150008 – North Wales Elementary School

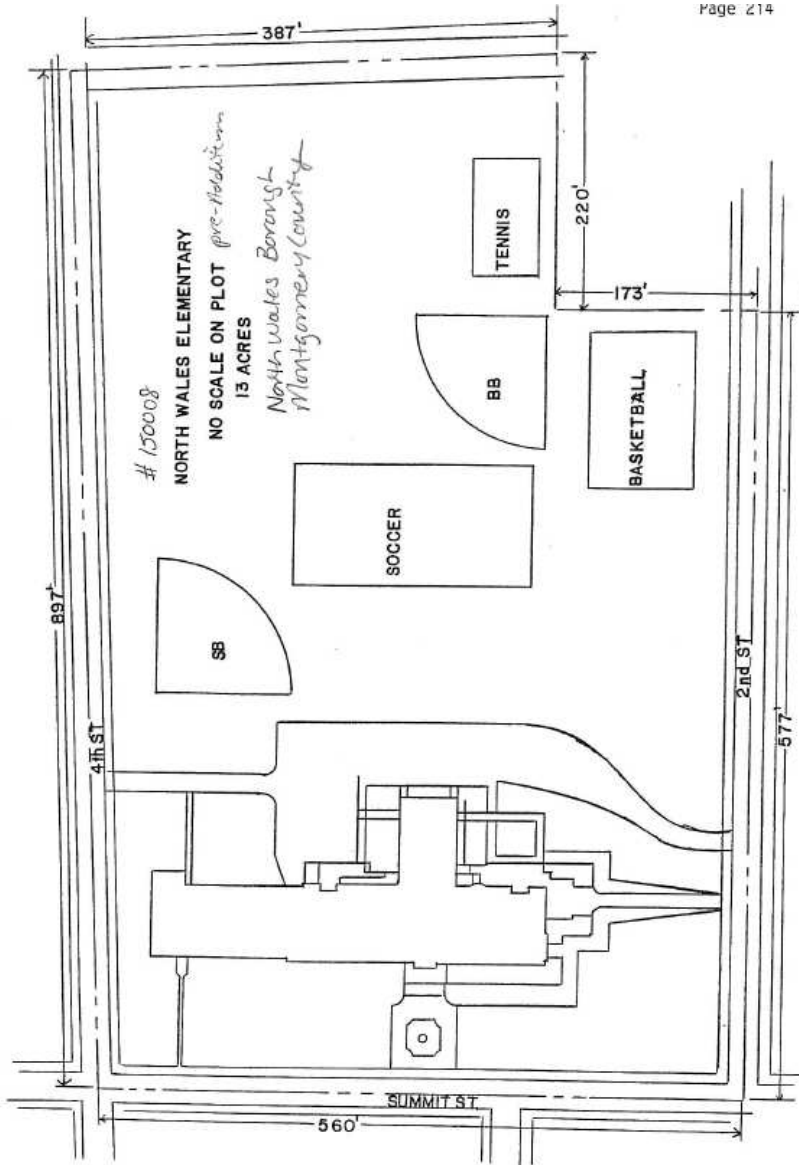



Site Plan of North Wales Elementary

North Wales Elementary School

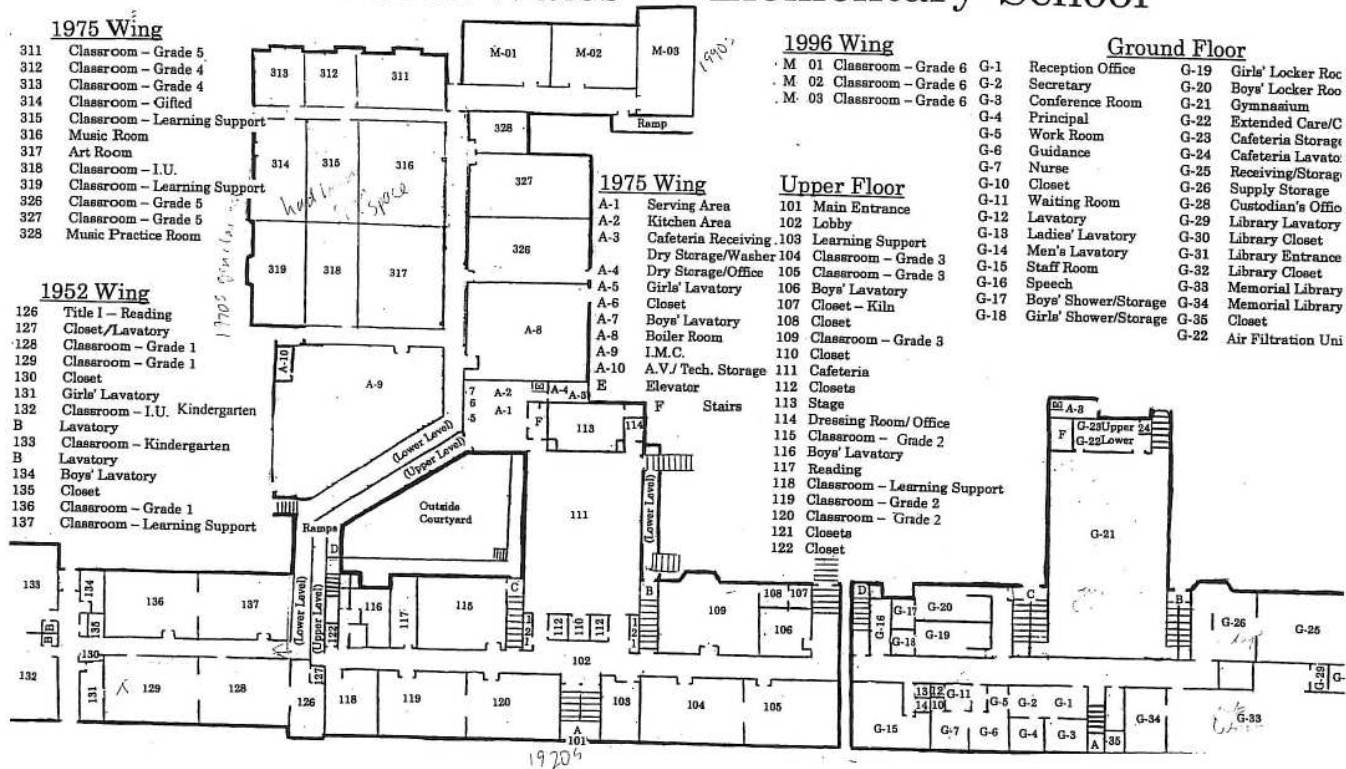

#150008
North Wales Borough
Montgomery County

Floor Plan of North Wales Elementary

150008; North Wales Elementary School. This school is located at 201 Summit Street, North Wales, Pennsylvania in North Wales Borough, Montgomery County. It is part of the North Penn School District. The 1927 school building sits at the northwest end of the property, set back from Summit Street on a slightly banked hill featuring grass lawn, concrete walkways, and scattered mature trees and bushes. A flagpole and school sign are located in front of the main entrance in a landscaped display. Playground equipment is located on the south side of the building. A paved playground area is located on the east side of the building. Behind the school are large open fields featuring baseball/softball and soccer fields. Tennis and basketball courts are located on the southwest side of the property. Mature trees are scattered around the perimeter of the property. A paved driveway accesses a small parking lot at the southwest side of the school. Parking for the school is found primarily along the roadway. Directly across Summit Street from the school is a small public park.

The original school building was a T-plan that has since become an enlarged T-plan with additions. The 1927 core of the school features interior hallways with classrooms on either side. A rear extension centered on the core, across from the main entrance, houses a gymnasium on the ground floor and a cafeteria/auditorium on the upper floor. A 1952 wing extends from the northeast end of the core. This wing also features an interior hallway with classrooms on either side. A 1975 wing includes a group of classrooms originally constructed as an open-space pod. These classrooms have since been permanently enclosed. The 1975 building addition connects with the original 1927 core to form an enclosed courtyard. Three modular classrooms extend from the 1975 wing. The modular classrooms were constructed in 1996.

The original 1927 core is a two-story building. The ground floor is partially obscured on the front façade. The brick structure sits on a stone foundation. The building features decorative brick belt courses. Rubber membrane covers the flat timber-frame roof. A non-functional brick chimney stack extends from the roof. The main entrance contains modern metal doors with sidelights set into an original surround with Gothic Revival and Tudor details. A pointed arch transom with stained glass tracery is surrounded by decorative stonework including strapwork and simulated quoining. The original lettering ("North Wales High School") on a stone plaque above the entrance was replaced in the 1950s with metal lettering reading, "North Wales Elementary School." The 1952 wing is designed with architectural details similar to the 1927 core. The 1975 wing is a concrete-block structure clad in hollow tile. The school building is lit by metal picture and hopper windows installed in 1975. These windows are smaller than the original sash. The window bays are partially filled in with stuccoed panels. Modular classrooms added in 1996 are one-story gabled frame structures with casement windows.

The original entry lobby was on the upper floor of the building. Stairs from the main entrance lead up to the original entry lobby. Stairwells in the 1927 core feature wooden steps, tile landings, and metal railings. Hallways feature dropped

ceilings with acoustic ceiling tiles, carpeted floors, fluorescent light fixtures, and painted plaster walls. Inset classroom entrances have multi-pane wood doors. Classrooms are carpeted. The gymnasium features brick walls, vinyl floor tiles, acoustic ceiling tiles, suspended basketball hoops, and a new "climbing wall." Brick support columns are located at the southwest end of the gym. Above the gymnasium is the original cafeteria/auditorium. This room features a combination of concrete-block and plaster walls, vinyl floor tiles, acoustic ceiling tiles and acoustic wall panels. A wood proscenium stage is located at the northeast end of the room. Both of these rooms were remodeled in the 1970s (Ineke MacCrea, pers. com., November 2, 2006). Specialized classrooms have included two biology laboratory classrooms on the ground floor. The ground floor was remodeled to house school offices in the 1970s. The North Wales Public Library has been located at the western corner of the ground floor of the core building since 1928. A school library is located in the 1975 addition.

The original core of the building was built as the North Wales High School in 1927, to replace high school classes held in an older nearby school building. The new school housed students in grades seven to twelve. The two-story gymnasium and cafeteria/auditorium extension was built during the original construction through funds raised by the local Women's Civic Club. The auditorium was intended for use by the community as a whole. In exchange for their donation, the group was given space in the new school building for another community project. The North Wales Memorial Free Library had been formally established in 1924 and has operated in the Summit Street school since 1928. In 1951-52 a new wing was added to the school. By the mid-1950s the school housed grades one to twelve. A fire caused some damage to the building in 1956. In response to local school district consolidation, the school was converted to an elementary school in 1956. An addition was constructed in 1975. It included an open-space "pod." Interior classroom walls were constructed by 1980. Three modular classrooms were attached to the building in 1996.

(Ineke MacCrea, Principal, pers. com., November 2, 2006)

Historical information provided by the North Wales Memorial Free Library.

United States Department of Agriculture

1942 Aerial Photograph AHO-1B-116. Created on October, 8, 1942. On file at the Pennsylvania State Archives, Record Group 31, Records of the Department of Commerce, State Planning Board Collection.

United States Geological Survey

1983 *Lansdale, PA Quadrangle*. 7.5 minute series. Topography by photogrammetric methods from aerial photographs taken 1950. Field checked 1951. Revised from aerial photographs taken 1965. Field checked 1966. Photorevised 1983. Denver, CO or Reston, VA.

1992 *Lansdale NE, PA Aerial Photograph*. USGS Reference Number 40075-B3-02-PHT. Created on April 14, 1992.



Aerial View of North Wales Elementary

More Photos of North Wales Elementary School

