

1
A-3-65
JOHN SNIEDER
60 AS. 137 P & Allow
War. Mar. 1, 1737
Sur. Oct. 27, 1739
Pat. Apr. 4, 1763
To ISAAC NORRIS
AA-5-122
Courses & Distances
1. Beginning at W.O.
N 65 E. 252 to Post
2. S 25 E. 41 to
3. S. 65 W. 252 to Stone
4. N. 25 W. 41 to W.O.

2
C-154-259
ISAAC NORRIS ESQ.
240 AS. & Allow
War. (to accept) June 25, 1742
Sur. Nov. 26, 1741
Pat. Apr. 14, 1762
To ISAAC NORRIS ESQ.
AA-3-433

3
C-89-79
JAMES INGLES
200 AS. & Allow
War. (to accept) July 20, 1739
Sur. Aug. 29, 1739
Pat. July 24, 1739
To JAMES INGLES
A-9-49

4
A-45-270
MICHAEL FISHER
150 AS. & Allow
War. Mar. 14, 1733
Sur. Aug. 29, 1734
Pat. Apr. 20, 1750
To MICHAEL FISHER
A-15-388

5
C-234-257
HENRY WOLF
50 AS. & Allow
War. Nov. 21, 1734
Sur. Oct. 15, 1761
Pat. Jan. 29, 1762
To George Wolf
AA-2-513

6
C-234-258
HENRY WOLF
150 AS. & Allow
War. Feb. 27, 1733
Sur. Sept. 26, 1735
Pat. Jan. 29, 1762
To George Wolf
AA-2-513

7
C-78-22
HENRY GARRETT
201 AS. 47 P & Allow
War. Sept. 5, 1737
Sur. Aug. 26, 1808

A
C-61-259
193 AS. 50 P & Allow
Sur. Aug. 26, 1808
Pat. July 6, 1813
To Jacob Gehret
H-10-7

B
C-78-42
7 AS. 150 P & Allow
Sur. Mar. 17, 1815
Pat. Mar. 27, 1815
To Peter & John Dunkelberger
H-12-649

8
C-185-270
JACOB STEEL
200 AS. & Allow
War. (to accept) Aug. 10, 1751
Sur. Nov. 12, 1734
Pat. Aug. 12, 1751
To JACOB STEEL
A-17-238

9
C-206-59
GEORGE SPENGLER
182 AS. 112 P & Allow
War. Oct. 29, 1760
Sur. (No date)
Pat. July 2, 1761
To GEORGE SPENGLER
AA-1-445

10
C-76-163
JOHN HAVERACRE
93 AS. 12 P & Allow
War. Oct. 25, 1737
Sur. (No date)
Pat. Feb. 12, 1762
To JOHN HAVERACRE
AA-2-504
Courses & Distances
1. Beginning at Stone
N. 70 E. 111 to Stone
2. S. 20 E. 126 to Post
3. N. 70 E. 39 to Post
4. S. 20 E. 40 to Post
5. S. 70 W. 120 to Post
6. N. 20 W. 140 to Stone
7. S. 70 W. 30 to Stone
8. N. 20 W. 26 to Stone

11
A-6-223
PETER SCHMIDT
200 AS. & Allow
War. (to accept) June 19, 1745
Sur. Mar. 20, 1738
Pat. Nov. 6, 1766
To Conrad & Philip Schmidt
AA-8-115
"Frankfurt"

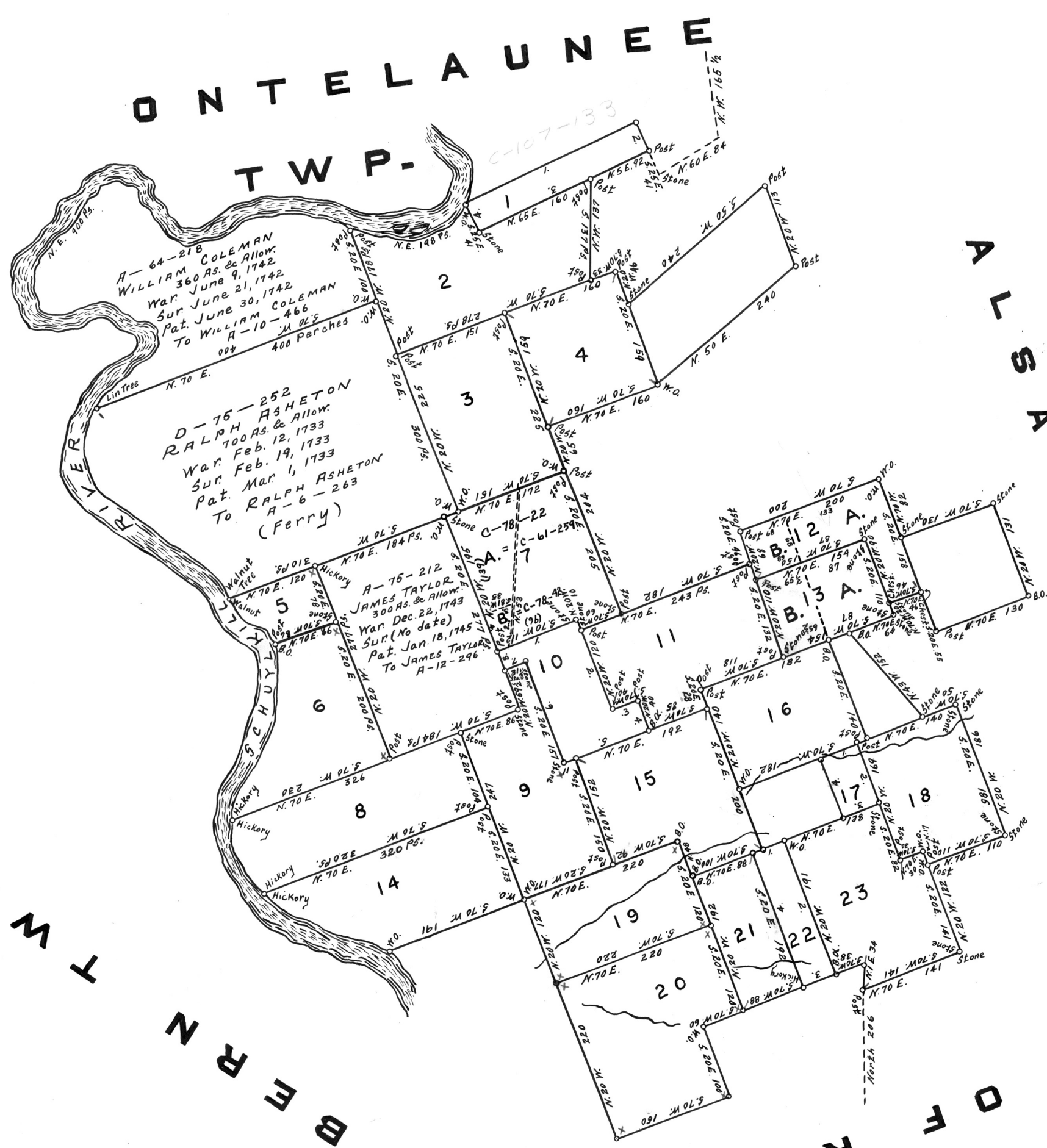

**MUHLENBURG TOWNSHIP
BERKS COUNTY**

A CONNECTED WARRANTEE MAP: of Muhlenburg Township, Berks County. The Warrants, surveys and Patents bearing dates respectively as above set forth, constructed from and compared with the original drafts remaining on file in the Department of Internal Affairs, of the Commonwealth of Pennsylvania; under the direction of Arthur A. N. Fenoglio, Assistant Director, and approved by Martha B. Curtis, Director of the Land Office.

IN TESTIMONY WHEREOF: I have hereunto set my hand and caused the seal of the said Department to be affixed at Harrisburg, Pennsylvania; this tenth day of December A.D., one thousand nine hundred and fifty-six.

Genevieve Platt
Secretary of Internal Affairs.

12
A-23-267
JACOB ALMAN
104 AS. 95 P & Allow
War. Nov. 30, 1737
Sur. June 10, 1740
A
A-17-93
77 AS. 117 P & Allow
Pat. Feb. 10, 1810
To John Weimer
"H-2-186
"Manchester"

B
A-23-279
26 AS. 130 P & Allow
Re-Sur. Nov. 25, 1808
Pat. Aug. 31, 1811
To Henry Leinbach
H-6-323
"Bloomfield"

13
A-23-280
RUDOLPH GARRET
100 AS. & Allow
War. Nov. 29, 1748
Sur. (No date)
A
C-5-100
56 AS. 68 P & Allow
Re-Sur. Aug. 4, 1809
Pat. Feb. 10, 1809
To John Weimer
H-2-186
"Manchester"

B
A-23-279
44 AS. 20 P & Allow
Re-Sur. Nov. 25, 1808
Pat. Aug. 31, 1811
To Henry Leinbach
H-6-323
"Bloomfield"

14
P-397
GEORGE CLAPP
200 AS. & Allow
War. Feb. 27, 1733
Sur. Apr. 30, 1734
Pat. Mar. 21, 1794
To Jacob Kloss
P-21-52
"Fertile Grove"

15
A-51-214
JOHN HAVERACRE
200 1/4 AS. & Allow
War. Feb. 27, 1733
Sur. May 1, 1734
Pat. Feb. 12, 1762
To JOHN HAVERACRE
AA-2-504

16
A-83-251
JOHN BROWN
150 AS. & Allow
War. Feb. 27, 1733
Sur. May 1, 1734
Pat. June 6, 1761
To Henry Snyder
AA-1-318

17
Q-11
JOHN ADAMS
25 AS. 103 P & Allow
War. Jan. 16, 1741
Sur. Nov. 2, 1742
Pat. Nov. 19, 1767
To Adam Riffle
"AA-10-240
"Hear Court"

Courses & Distances
1. Beginning at Post
N. 70 E. 50 to Post
2. S. 20 E. 87 to Stone
3. S. 70 W. 50 to Stone
4. N. 20 W. 87 to Post

18
C-58-220
HENRY GOODHART
150 AS. 84 P & Allow
War. Feb. 2, 1737
Sur. June 9, 1740
Pat. Nov. 19, 1767
To Adam Riffle
AA-10-240
"Mount Lovely"

19
C-206-49
JACOB SPENGLER
155 AS. & Allow
War. Feb. 27, 1733
Sur. Apr. 30, 1734
Pat. July 2, 1761
To George Spengler
AA-1-445

20
A-83-253
DEVOLD BAUM
250 AS. & Allow
War. Feb. 27, 1733
Sur. Apr. 30, 1734
Pat. Aug. 20, 1761
To DEVOLD BAUM
AA-2-375

21
C-190-41
ADAM REYFELL
100 AS. & Allow
War. Sept. 24, 1743
Sur. June 24, 1734
Pat. Aug. 19, 1760
To ADAM REYFELL
AA-1-59

22
C-190-41
JOHN ADAM REYFELL
50 AS. & Allow
War. Nov. 25, 1737
Sur. Mar. 29, 1738
Pat. Aug. 19, 1760
To ADAM REYFELL
AA-1-59
Courses & Distances
1. N. 70 E. 44 to W.O.
2. S. 20 E. 192 to B.O. Sap
3. S. 70 W. 44 to Hickory
4. N. 20 W. 192 to Beginning