

1 KATHERINE WELTER 200 ACRES & ALLIANCE WARRANT JAN 14, 1735 SURVEY MAY 21, 1735 PATENT FEB 15, 1736 TO KATHERINE WELTER	2 ANDREAS COFFMAN 100 ACRES & ALLIANCE WARRANT (in part) JUN 7, 1735 SURVEY MAY 21, 1735 PATENT OCT 23, 1736 TO ANDREAS COFFMAN	3 MICHAEL MILLER 200 ACRES & ALLIANCE WARRANT (in part) JUN 7, 1735 SURVEY OCT 11, 1735 PATENT MAR 21, 1736 TO DONALD BARTON	4 JOHN BRUBACKER 100 ACRES & ALLIANCE WARRANT (in part) JUN 7, 1735 SURVEY MAY 21, 1735 PATENT OCT 23, 1736 TO JOHN BRUBACKER	5 JACOB BRUBACKER 100 ACRES & ALLIANCE WARRANT (in part) JUN 7, 1735 SURVEY MAY 21, 1735 PATENT OCT 23, 1736 TO JACOB BRUBACKER	6 GEORGE ASTON 100 ACRES & ALLIANCE WARRANT (in part) JUN 7, 1735 SURVEY MAY 21, 1735 PATENT OCT 23, 1736 TO ROGER HUNT	7 JOHN & MICHAEL MOYER 100 ACRES & ALLIANCE WARRANT (in part) JUN 7, 1735 SURVEY MAY 21, 1735 PATENT OCT 23, 1736 TO JOHN MOYER	8 CASPER WARTMAN 100 ACRES & ALLIANCE WARRANT (in part) JUN 7, 1735 SURVEY MAY 21, 1735 PATENT OCT 23, 1736 TO MICHAEL FOX	9 THOMAS DOYLE 100 ACRES & ALLIANCE WARRANT (in part) JUN 7, 1735 SURVEY MAY 21, 1735 PATENT OCT 23, 1736 TO THOMAS DOYLE	10 MARTIN KUNDSCH (John Funks) 100 ACRES & ALLIANCE WARRANT (in part) JUN 7, 1735 SURVEY MAY 21, 1735 PATENT OCT 23, 1736 NOTE: PATENT (over) DONALD BARTON.	11 THOMAS THORNBURY 100 ACRES & ALLIANCE WARRANT (in part) JUN 7, 1735 SURVEY MAY 21, 1735 PATENT OCT 23, 1736 TO MICHAEL GARDNER	12 MARTIN LANDS 100 ACRES & ALLIANCE WARRANT (in part) JUN 7, 1735 SURVEY MAY 21, 1735 PATENT OCT 23, 1736 TO MICHAEL GARDNER	13 JOHN DAVIES 100 ACRES & ALLIANCE WARRANT (in part) JUN 7, 1735 SURVEY MAY 21, 1735 PATENT OCT 23, 1736 TO HENRY BOYLES	14 MICHAEL LEWIS (Muel) 100 ACRES & ALLIANCE WARRANT (in part) JUN 7, 1735 SURVEY MAY 21, 1735 PATENT OCT 23, 1736 TO MICHAEL LEWIS	15 SAMUEL WILEY 100 ACRES & ALLIANCE WARRANT (in part) JUN 7, 1735 SURVEY MAY 21, 1735 PATENT OCT 23, 1736 TO CHRISTIAN WILEY	16 SAMUEL BETHEL 100 ACRES & ALLIANCE WARRANT (in part) JUN 7, 1735 SURVEY MAY 21, 1735 PATENT OCT 23, 1736 TO SAMUEL BETHEL	17 MICHAEL MEIR 100 ACRES & ALLIANCE WARRANT (in part) JUN 7, 1735 SURVEY MAY 21, 1735 PATENT OCT 23, 1736 TO THOMAS COCKSON	18 ANDREW HAMILTON 100 ACRES & ALLIANCE WARRANT (in part) JUN 7, 1735 SURVEY MAY 21, 1735 PATENT OCT 23, 1736 TO JOHN HAMILTON	19 MICHAEL BAUGHMAN 100 ACRES & ALLIANCE WARRANT (in part) JUN 7, 1735 SURVEY MAY 21, 1735 PATENT OCT 23, 1736 TO JOHN MOYER	20 HANS TUBEREN (Turber) 100 ACRES & ALLIANCE WARRANT (in part) JUN 7, 1735 SURVEY MAY 21, 1735 PATENT OCT 23, 1736 TO ADAM TUBEREN	21 MICHAEL SHANE & HENRY PARE 100 ACRES & ALLIANCE WARRANT (in part) JUN 7, 1735 SURVEY MAY 21, 1735 PATENT OCT 23, 1736 TO MICHAEL SHANE & HENRY PARE	22 HANS SHANK 100 ACRES & ALLIANCE WARRANT (in part) JUN 7, 1735 SURVEY MAY 21, 1735 PATENT OCT 23, 1736 TO HANS SHANK	23 MICHAEL BAUGHMAN 100 ACRES & ALLIANCE WARRANT (in part) JUN 7, 1735 SURVEY MAY 21, 1735 PATENT OCT 23, 1736 TO JOHN MOYER	24 ALEXANDER BEUSE (Beuse) 100 ACRES & ALLIANCE WARRANT (in part) JUN 7, 1735 SURVEY MAY 21, 1735 PATENT OCT 23, 1736 TO MICHAEL BAUGHMAN	25 JOHN PARRER 100 ACRES & ALLIANCE WARRANT (in part) JUN 7, 1735 SURVEY MAY 21, 1735 PATENT OCT 23, 1736 TO JOHN PARRER	26 JOHN PARRER 100 ACRES & ALLIANCE WARRANT (in part) JUN 7, 1735 SURVEY MAY 21, 1735 PATENT OCT 23, 1736 TO JOHN PARRER	27 EDMUND CARLISLE 100 ACRES & ALLIANCE WARRANT (in part) JUN 7, 1735 SURVEY MAY 21, 1735 PATENT OCT 23, 1736 TO EDMUND CARLISLE	28 JOHN PARRER 100 ACRES & ALLIANCE WARRANT (in part) JUN 7, 1735 SURVEY MAY 21, 1735 PATENT OCT 23, 1736 TO JOHN PARRER	29 JACOB LANZ & ALDRICH HONNY 100 ACRES & ALLIANCE WARRANT (in part) JUN 7, 1735 SURVEY MAY 21, 1735 PATENT OCT 23, 1736 TO JACOB LANZ & ALDRICH HONNY	30 MICHAEL BAUGHMAN 100 ACRES & ALLIANCE WARRANT (in part) JUN 7, 1735 SURVEY MAY 21, 1735 PATENT OCT 23, 1736 TO JOHN MOYER	31 WILLIAM HENRY 100 ACRES & ALLIANCE WARRANT (in part) JUN 7, 1735 SURVEY MAY 21, 1735 PATENT OCT 23, 1736 TO WILLIAM HENRY	32 WILLIAM HENRY 100 ACRES & ALLIANCE WARRANT (in part) JUN 7, 1735 SURVEY MAY 21, 1735 PATENT OCT 23, 1736 TO WILLIAM HENRY	33 WILLIAM HENRY 100 ACRES & ALLIANCE WARRANT (in part) JUN 7, 1735 SURVEY MAY 21, 1735 PATENT OCT 23, 1736 TO WILLIAM HENRY	34 WILLIAM HENRY 100 ACRES & ALLIANCE WARRANT (in part) JUN 7, 1735 SURVEY MAY 21, 1735 PATENT OCT 23, 1736 TO WILLIAM HENRY	35 WILLIAM HENRY 100 ACRES & ALLIANCE WARRANT (in part) JUN 7, 1735 SURVEY MAY 21, 1735 PATENT OCT 23, 1736 TO WILLIAM HENRY	36 WILLIAM HENRY 100 ACRES & ALLIANCE WARRANT (in part) JUN 7, 1735 SURVEY MAY 21, 1735 PATENT OCT 23, 1736 TO WILLIAM HENRY	37 WILLIAM HENRY 100 ACRES & ALLIANCE WARRANT (in part) JUN 7, 1735 SURVEY MAY 21, 1735 PATENT OCT 23, 1736 TO WILLIAM HENRY	38 WILLIAM HENRY 100 ACRES & ALLIANCE WARRANT (in part) JUN 7, 1735 SURVEY MAY 21, 1735 PATENT OCT 23, 1736 TO WILLIAM HENRY	39 WILLIAM HENRY 100 ACRES & ALLIANCE WARRANT (in part) JUN 7, 1735 SURVEY MAY 21, 1735 PATENT OCT 23, 1736 TO WILLIAM HENRY	40 WILLIAM HENRY 100 ACRES & ALLIANCE WARRANT (in part) JUN 7, 1735 SURVEY MAY 21, 1735 PATENT OCT 23, 1736 TO WILLIAM HENRY	41 WILLIAM HENRY 100 ACRES & ALLIANCE WARRANT (in part) JUN 7, 1735 SURVEY MAY 21, 1735 PATENT OCT 23, 1736 TO WILLIAM HENRY	42 WILLIAM HENRY 100 ACRES & ALLIANCE WARRANT (in part) JUN 7, 1735 SURVEY MAY 21, 1735 PATENT OCT 23, 1736 TO WILLIAM HENRY	43 WILLIAM HENRY 100 ACRES & ALLIANCE WARRANT (in part) JUN 7, 1735 SURVEY MAY 21, 1735 PATENT OCT 23, 1736 TO WILLIAM HENRY	44 WILLIAM HENRY 100 ACRES & ALLIANCE WARRANT (in part) JUN 7, 1735 SURVEY MAY 21, 1735 PATENT OCT 23, 1736 TO WILLIAM HENRY	45 WILLIAM HENRY 100 ACRES & ALLIANCE WARRANT (in part) JUN 7, 1735 SURVEY MAY 21, 1735 PATENT OCT 23, 1736 TO WILLIAM HENRY	46 WILLIAM HENRY 100 ACRES & ALLIANCE WARRANT (in part) JUN 7, 1735 SURVEY MAY 21, 1735 PATENT OCT 23, 1736 TO WILLIAM HENRY	47 WILLIAM HENRY 100 ACRES & ALLIANCE WARRANT (in part) JUN 7, 1735 SURVEY MAY 21, 1735 PATENT OCT 23, 1736 TO WILLIAM HENRY	48 WILLIAM HENRY 100 ACRES & ALLIANCE WARRANT (in part) JUN 7, 1735 SURVEY MAY 21, 1735 PATENT OCT 23, 1736 TO WILLIAM HENRY	49 WILLIAM HENRY 100 ACRES & ALLIANCE WARRANT (in part) JUN 7, 1735 SURVEY MAY 21, 1735 PATENT OCT 23, 1736 TO WILLIAM HENRY	50 WILLIAM HENRY 100 ACRES & ALLIANCE WARRANT (in part) JUN 7, 1735 SURVEY MAY 21, 1735 PATENT OCT 23, 1736 TO WILLIAM HENRY	51 WILLIAM HENRY 100 ACRES & ALLIANCE WARRANT (in part) JUN 7, 1735 SURVEY MAY 21, 1735 PATENT OCT 23, 1736 TO WILLIAM HENRY	52 WILLIAM HENRY 100 ACRES & ALLIANCE WARRANT (in part) JUN 7, 1735 SURVEY MAY 21, 1735 PATENT OCT 23, 1736 TO WILLIAM HENRY	53 WILLIAM HENRY 100 ACRES & ALLIANCE WARRANT (in part) JUN 7, 1735 SURVEY MAY 21, 1735 PATENT OCT 23, 1736 TO WILLIAM HENRY	54 WILLIAM HENRY 100 ACRES & ALLIANCE WARRANT (in part) JUN 7, 1735 SURVEY MAY 21, 1735 PATENT OCT 23, 1736 TO WILLIAM HENRY	55 WILLIAM HENRY 100 ACRES & ALLIANCE WARRANT (in part) JUN 7, 1735 SURVEY MAY 21, 1735 PATENT OCT 23, 1736 TO WILLIAM HENRY	56 WILLIAM HENRY 100 ACRES & ALLIANCE WARRANT (in part) JUN 7, 1735 SURVEY MAY 21, 1735 PATENT OCT 23, 1736 TO WILLIAM HENRY	57 WILLIAM HENRY 100 ACRES & ALLIANCE WARRANT (in part) JUN 7, 1735 SURVEY MAY 21, 1735 PATENT OCT 23, 1736 TO WILLIAM HENRY	58 WILLIAM HENRY 100 ACRES & ALLIANCE WARRANT (in part) JUN 7, 1735 SURVEY MAY 21, 1735 PATENT OCT 23, 1736 TO WILLIAM HENRY	59 WILLIAM HENRY 100 ACRES & ALLIANCE WARRANT (in part) JUN 7, 1735 SURVEY MAY 21, 1735 PATENT OCT 23, 1736 TO WILLIAM HENRY	60 WILLIAM HENRY 100 ACRES & ALLIANCE WARRANT (in part) JUN 7, 1735 SURVEY MAY 21, 1735 PATENT OCT 23, 1736 TO WILLIAM HENRY	61 WILLIAM HENRY 100 ACRES & ALLIANCE WARRANT (in part) JUN 7, 1735 SURVEY MAY 21, 1735 PATENT OCT 23, 1736 TO WILLIAM HENRY	62 WILLIAM HENRY 100 ACRES & ALLIANCE WARRANT (in part) JUN 7, 1735 SURVEY MAY 21, 1735 PATENT OCT 23, 1736 TO WILLIAM HENRY	63 WILLIAM HENRY 100 ACRES & ALLIANCE WARRANT (in part) JUN 7, 1735 SURVEY MAY 21, 1735 PATENT OCT 23, 1736 TO WILLIAM HENRY	64 WILLIAM HENRY 100 ACRES & ALLIANCE WARRANT (in part) JUN 7, 1735 SURVEY MAY 21, 1735 PATENT OCT 23, 1736 TO WILLIAM HENRY	65 WILLIAM HENRY 100 ACRES & ALLIANCE WARRANT (in part) JUN 7, 1735 SURVEY MAY 21, 1735 PATENT OCT 23, 1736 TO WILLIAM HENRY	66 WILLIAM HENRY 100 ACRES & ALLIANCE WARRANT (in part) JUN 7, 1735 SURVEY MAY 21, 1735 PATENT OCT 23, 1736 TO WILLIAM HENRY	67 WILLIAM HENRY 100 ACRES & ALLIANCE WARRANT (in part) JUN 7, 1735 SURVEY MAY 21, 1735 PATENT OCT 23, 1736 TO WILLIAM HENRY	68 WILLIAM HENRY 100 ACRES & ALLIANCE WARRANT (in part) JUN 7, 1735 SURVEY MAY 21, 1735 PATENT OCT 23, 1736 TO WILLIAM HENRY	69 WILLIAM HENRY 100 ACRES & ALLIANCE WARRANT (in part) JUN 7, 1735 SURVEY MAY 21, 1735 PATENT OCT 23, 1736 TO WILLIAM HENRY	70 WILLIAM HENRY 100 ACRES & ALLIANCE WARRANT (in part) JUN 7, 1735 SURVEY MAY 21, 1735 PATENT OCT 23, 1736 TO WILLIAM HENRY	71 WILLIAM HENRY 100 ACRES & ALLIANCE WARRANT (in part) JUN 7, 1735 SURVEY MAY 21, 1735 PATENT OCT 23, 1736 TO WILLIAM HENRY	72 WILLIAM HENRY 100 ACRES & ALLIANCE WARRANT (in part) JUN 7, 1735 SURVEY MAY 21, 1735 PATENT OCT 23, 1736 TO WILLIAM HENRY	73 WILLIAM HENRY 100 ACRES & ALLIANCE WARRANT (in part) JUN 7, 1735 SURVEY MAY 21, 1735 PATENT OCT 23, 1736 TO WILLIAM HENRY	74 WILLIAM HENRY 100 ACRES & ALLIANCE WARRANT (in part) JUN 7, 1735 SURVEY MAY 21, 1735 PATENT OCT 23, 1736 TO WILLIAM HENRY	75 WILLIAM HENRY 100 ACRES & ALLIANCE WARRANT (in part) JUN 7, 1735 SURVEY MAY 21, 1735 PATENT OCT 23, 1736 TO WILLIAM HENRY	76 WILLIAM HENRY 100 ACRES & ALLIANCE WARRANT (in part) JUN 7, 1735 SURVEY MAY 21, 1735 PATENT OCT 23, 1736 TO WILLIAM HENRY	77 WILLIAM HENRY 100 ACRES & ALLIANCE WARRANT (in part) JUN 7, 1735 SURVEY MAY 21, 1735 PATENT OCT 23, 1736 TO WILLIAM HENRY	78 WILLIAM HENRY 100 ACRES & ALLIANCE WARRANT (in part) JUN 7, 1735 SURVEY MAY 21, 1735 PATENT OCT 23, 1736 TO WILLIAM HENRY	79 WILLIAM HENRY 100 ACRES & ALLIANCE WARRANT (in part) JUN 7, 1735 SURVEY MAY 21, 1735 PATENT OCT 23, 1736 TO WILLIAM HENRY	80 WILLIAM HENRY 100 ACRES & ALLIANCE WARRANT (in part) JUN 7, 1735 SURVEY MAY 21, 1735 PATENT OCT 23, 1736 TO WILLIAM HENRY	81 WILLIAM HENRY 100 ACRES & ALLIANCE WARRANT (in part) JUN 7, 1735 SURVEY MAY 21, 1735 PATENT OCT 23, 1736 TO WILLIAM HENRY	82 WILLIAM HENRY 100 ACRES & ALLIANCE WARRANT (in part) JUN 7, 1735 SURVEY MAY 21, 1735 PATENT OCT 23, 1736 TO WILLIAM HENRY	83 WILLIAM HENRY 100 ACRES & ALLIANCE WARRANT (in part) JUN 7, 1735 SURVEY MAY 21, 1735 PATENT OCT 23, 1736 TO WILLIAM HENRY	84 WILLIAM HENRY 100 ACRES & ALLIANCE WARRANT (in part) JUN 7, 1735 SURVEY MAY 21, 1735 PATENT OCT 23, 1736 TO WILLIAM HENRY	85 WILLIAM HENRY 100 ACRES & ALLIANCE WARRANT (in part) JUN 7, 1735 SURVEY MAY 21, 1735 PATENT OCT 23, 1736 TO WILLIAM HENRY
--	---	--	---	---	---	---	--	---	--	---	---	---	---	---	--	--	--	--	---	--	--	--	---	--	--	--	--	--	--	--	--	--	--	--	--	--	--	--	--	--	--	--	--	--	--	--	--	--	--	--	--	--	--	--	--	--	--	--	--	--	--	--	--	--	--	--	--	--	--	--	--	--	--	--	--	--	--	--	--	--	--	--	--	--

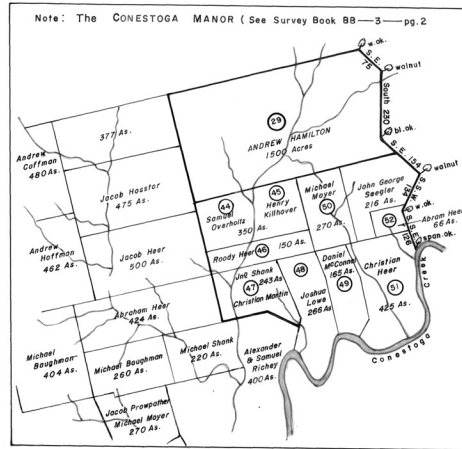

A DRAFT of eighty five (85) tracts of land, which when surveyed, were situate in the City of Lancaster and part of the Conestoga Manor in Lancaster County. The warrants, surveys and patents bearing, respectively, the dates as above set forth, are constructed from and have been compared with the original drafts on file in the Division of Land Records, Bureau of Archives and History, Historical and Museum Commission, Commonwealth of Pennsylvania, under the direction of Edward D. Price, Chief.

IN TESTIMONY WHEREOF, I have unto set my hand and caused the seal of the said Commission to be affixed at Harrisburg, Pennsylvania, this twenty sixth of February A. D., one thousand nine hundred and eighty five.



LARRY E. TISE
LARRY E. TISE, Executive Director, Historical and Museum Commission