

SCALE 1" = 1000 FEET

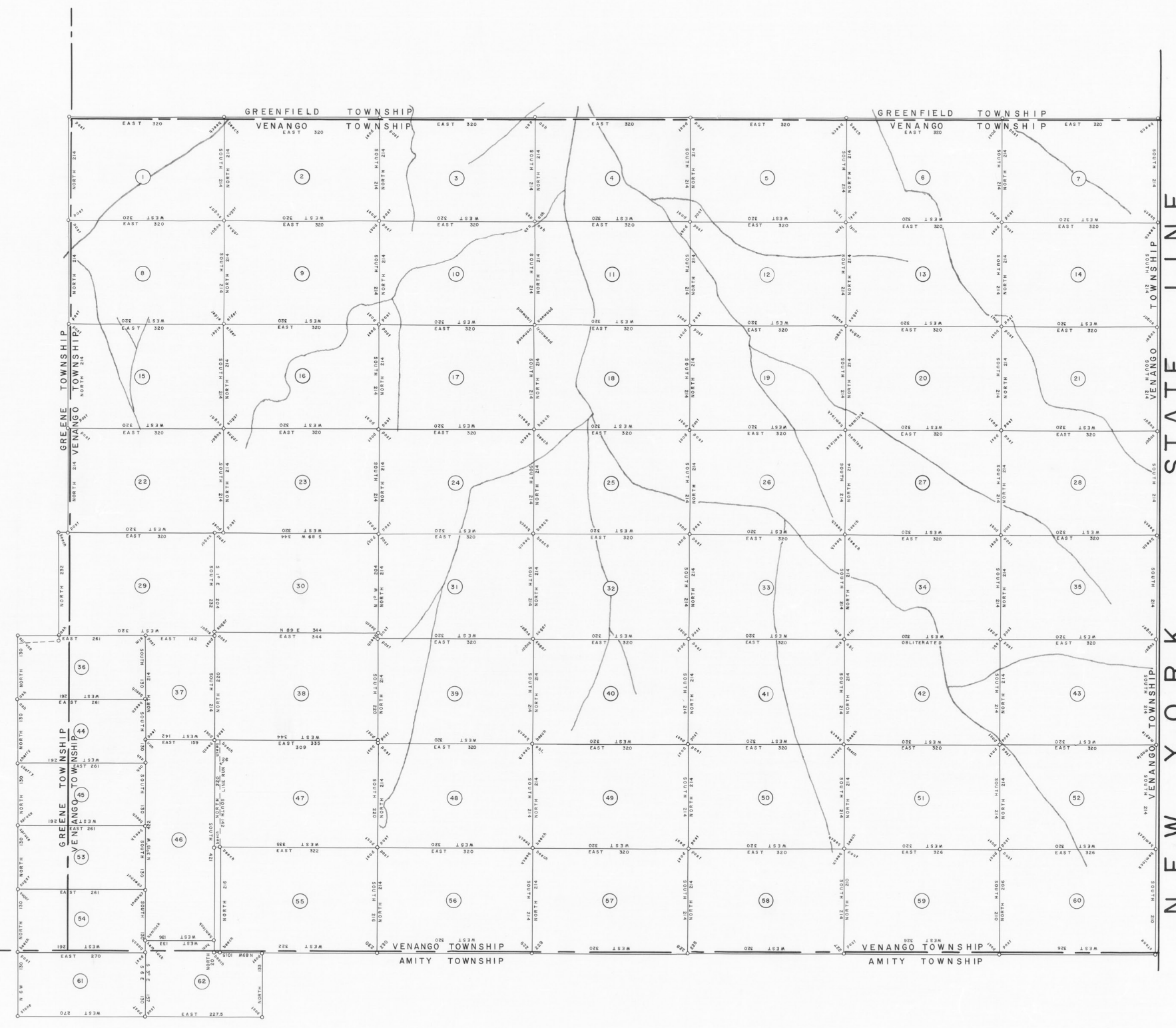

STATE LINE

| | | | | |
|---|---|---|--|--|
| 1 A-68-131 WILLIAM BROWN WARRANT APR 13/70 SURVEY JUNE 13/70 PATENT AUG 2/70 To John Field Esq (In trust) P-39-258 "Cometery" | 14 C-70-104 JOHN FISHER WARRANT APR 13/70 SURVEY JUNE 13/70 PATENT AUG 2/70 To John Field Esq (In trust) P-39-264 "Schoonhoven" | 27 K-125 JAMES CRAIG WARRANT APR 13/70 SURVEY JUNE 13/70 PATENT AUG 2/70 To John Field Esq (In trust) P-39-282 "Cometery" | 30 K-125 JOHN CLAWES WARRANT APR 13/70 SURVEY JUNE 13/70 PATENT AUG 2/70 To John Field Esq (In trust) P-39-282 "Cometery" | 33 C-36-278 WILLIAM GEISSE WARRANT APR 13/70 SURVEY JUNE 13/70 PATENT AUG 2/70 To John Field Esq (In trust) P-39-282 "Cometery" |
| 2 M-175 BOLJAMIN CHEW JR WARRANT APR 13/70 SURVEY JUNE 13/70 PATENT AUG 2/70 UNPATENTED AT THIS DATE | 15 A-68-299 JACOB BROWN WARRANT APR 13/70 SURVEY JUNE 13/70 PATENT AUG 2/70 To John Field Esq (In trust) P-41-248 "Cometery" | 28 Z-177 GEORGE FOX WARRANT APR 13/70 SURVEY JUNE 13/70 PATENT AUG 2/70 To John Field Esq (In trust) P-39-282 "Cometery" | 31 C-36-278 GEORGE COOPER WARRANT APR 13/70 SURVEY JUNE 13/70 PATENT AUG 2/70 To John Field Esq (In trust) P-39-282 "Cometery" | 34 A-61-53 JOHN GARTLEY WARRANT APR 13/70 SURVEY JUNE 13/70 PATENT AUG 2/70 To John Field Esq (In trust) P-39-282 "Cometery" |
| 3 B-177 EDWARD DOWERS WARRANT APR 13/70 SURVEY JUNE 13/70 PATENT AUG 2/70 To John Field Esq (In trust) P-41-308 "Montgomery" | 16 C-36-238 SAMUEL CLAPHAMSON WARRANT APR 13/70 SURVEY JUNE 13/70 PATENT AUG 2/70 To John Field Esq (In trust) P-41-34 "Cometery" | 29 N-72 JOHN PHILLIPS WARRANT APR 13/70 SURVEY JUNE 13/70 PATENT AUG 2/70 ON WARRANT TO ACCEPT DATED NOV 28/99 To John Field Esq (In trust) P-39-282 "Cometery" | 32 C-36-238 NATHAN COOK WARRANT APR 13/70 SURVEY JUNE 13/70 PATENT AUG 2/70 To John Field Esq (In trust) P-39-282 "Cometery" | 35 D-48-270 TRACT NO 2009 WILLIAM NORTON WARRANT APR 13/70 SURVEY JUNE 13/70 PATENT AUG 2/70 ACT OF FEBRUARY RETURN AUG 28/99 |
| 4 ANDREW DOUGLASS WARRANT APR 13/70 SURVEY JUNE 13/70 PATENT AUG 2/70 To John Field Esq (In trust) P-41-308 "Montgomery" | 17 A-20-285 JOSEPH DEAN WARRANT APR 13/70 SURVEY JUNE 13/70 PATENT AUG 2/70 To John Field Esq (In trust) P-41-308 "Montgomery" | 30 K-125 JOHN PHILLIPS WARRANT APR 13/70 SURVEY JUNE 13/70 PATENT AUG 2/70 To John Field Esq (In trust) P-39-282 "Cometery" | 33 C-36-278 PETER GALLIOT WARRANT APR 13/70 SURVEY JUNE 13/70 PATENT AUG 2/70 To John Field Esq (In trust) P-39-282 "Cometery" | 36 C-161-69 TRACT NO 2000 ABRAHAM ANDERSON (PVT) WARRANT APR 13/70 SURVEY JUNE 13/70 PATENT AUG 2/70 ACT OF FEBRUARY RETURN AUG 28/99 |
| 5 B-176 LEONARD DORNEY WARRANT APR 13/70 SURVEY JUNE 13/70 PATENT AUG 2/70 To John Field Esq (In trust) P-39-277 "Northaven" | 18 W-176 WILLIAM DAVIDSON WARRANT APR 13/70 SURVEY JUNE 13/70 PATENT AUG 2/70 To John Field Esq (In trust) P-39-243 "Northaven" | 31 K-125 DANIEL CLAWES WARRANT APR 13/70 SURVEY JUNE 13/70 PATENT AUG 2/70 To John Field Esq (In trust) P-39-282 "Cometery" | 34 C-36-278 SAMUEL GARRIGUS WARRANT APR 13/70 SURVEY JUNE 13/70 PATENT AUG 2/70 To John Field Esq (In trust) P-39-282 "Cometery" | 37 C-161-69 TRACT NO 2000 ABRAHAM ANDERSON (PVT) WARRANT APR 13/70 SURVEY JUNE 13/70 PATENT AUG 2/70 ACT OF FEBRUARY RETURN AUG 28/99 |
| 6 J-182 JOHN DORNEY WARRANT APR 13/70 SURVEY JUNE 13/70 PATENT AUG 2/70 To John Field Esq (In trust) P-39-266 "Northaven" | 19 A-20-283 GEORGE DAVID WARRANT APR 13/70 SURVEY JUNE 13/70 PATENT AUG 2/70 To John Field Esq (In trust) P-41-13 "Northaven" | 32 K-125 PAUL COXE WARRANT APR 13/70 SURVEY JUNE 13/70 PATENT AUG 2/70 To John Field Esq (In trust) P-41-323 "Northaven" | 35 C-36-278 JOSEPH BANGS (PVT) WARRANT APR 13/70 SURVEY JUNE 13/70 PATENT AUG 2/70 ACT OF FEBRUARY RETURN AUG 28/99 | 38 C-161-69 TRACT NO 2000 ABRAHAM ANDERSON (PVT) WARRANT APR 13/70 SURVEY JUNE 13/70 PATENT AUG 2/70 ACT OF FEBRUARY RETURN AUG 28/99 |
| 7 C-70-103 JEREMIAH FISHER WARRANT APR 13/70 SURVEY JUNE 13/70 PATENT AUG 2/70 To John Field Esq (In trust) P-39-335 "Northaven" | 20 A-20-283 HENRY DARRICK WARRANT APR 13/70 SURVEY JUNE 13/70 PATENT AUG 2/70 To John Field Esq (In trust) P-39-282 "Northaven" | 33 C-36-278 GARRET COTTRINGER WARRANT APR 13/70 SURVEY JUNE 13/70 PATENT AUG 2/70 To John Field Esq (In trust) P-39-282 "Northaven" | 36 C-36-278 THOMAS HEARNS (PVT) WARRANT APR 13/70 SURVEY JUNE 13/70 PATENT AUG 2/70 ACT OF FEBRUARY RETURN AUG 28/99 | 39 C-161-69 TRACT NO 2000 ABRAHAM ANDERSON (PVT) WARRANT APR 13/70 SURVEY JUNE 13/70 PATENT AUG 2/70 ACT OF FEBRUARY RETURN AUG 28/99 |
| 8 A-68-123 JOHN BROWN WARRANT APR 13/70 SURVEY JUNE 13/70 PATENT AUG 2/70 To John Field Esq (In trust) P-41-308 "Montgomery" | 21 C-70-101 RICHARD FOOTMAN WARRANT APR 13/70 SURVEY JUNE 13/70 PATENT AUG 2/70 To John Field Esq (In trust) P-39-282 "Northaven" | 34 A-20-283 ALEXANDER FULLERTON WARRANT APR 13/70 SURVEY JUNE 13/70 PATENT AUG 2/70 To John Field Esq (In trust) P-39-282 "Northaven" | 37 C-36-278 WILLIAM ALLISON WARRANT APR 13/70 SURVEY JUNE 13/70 PATENT AUG 2/70 To John Field Esq (In trust) P-39-282 "Northaven" | 40 C-161-69 TRACT NO 2000 ABRAHAM ANDERSON (PVT) WARRANT APR 13/70 SURVEY JUNE 13/70 PATENT AUG 2/70 ACT OF FEBRUARY RETURN AUG 28/99 |
| 9 C-36-278 ALEXANDER CHRISTIE WARRANT APR 13/70 SURVEY JUNE 13/70 PATENT AUG 2/70 To John Field Esq (In trust) P-41-242 "Northaven" | 22 A-68-287 ELIJAH BROWN WARRANT APR 13/70 SURVEY JUNE 13/70 PATENT AUG 2/70 To John Field Esq (In trust) P-39-356 "Northaven" | 35 C-70-102 JOHN FROWBERGER WARRANT APR 13/70 SURVEY JUNE 13/70 PATENT AUG 2/70 ON WARRANT TO ACCEPT DATED MARCH 1899 To John Field Esq (In trust) P-39-282 "Northaven" | 38 C-36-278 TIMOTHY FULLER WARRANT APR 13/70 SURVEY JUNE 13/70 PATENT AUG 2/70 ON WARRANT TO ACCEPT DATED MARCH 1899 To John Field Esq (In trust) P-39-282 "Northaven" | 41 A-79-32 WILLIAM MILES WARRANT APR 13/70 SURVEY JUNE 13/70 PATENT AUG 2/70 ON WARRANT TO ACCEPT DATED MARCH 1899 To John Field Esq (In trust) P-39-282 "Northaven" |
| 10 B-176 JOSHUA DAVIDSON WARRANT APR 13/70 SURVEY JUNE 13/70 PATENT AUG 2/70 To John Field Esq (In trust) P-41-277 "Northaven" | 23 C-36-277 DAVID CLARK WARRANT APR 13/70 SURVEY JUNE 13/70 PATENT AUG 2/70 To John Field Esq (In trust) P-39-282 "Northaven" | 36 D-48-270 TRACT NO 2006 MARTIN O'BRIEN (PVT) WARRANT APR 13/70 SURVEY JUNE 13/70 PATENT AUG 2/70 ACT OF FEBRUARY RETURN AUG 28/99 | 39 C-36-278 PHILIP CLUMBER WARRANT APR 13/70 SURVEY JUNE 13/70 PATENT AUG 2/70 To John Field Esq (In trust) P-39-282 "Northaven" | 42 A-79-32 WILLIAM MILES WARRANT APR 13/70 SURVEY JUNE 13/70 PATENT AUG 2/70 ON WARRANT TO ACCEPT DATED MARCH 1899 To John Field Esq (In trust) P-39-282 "Northaven" |
| 11 A-20-284 PHILIP DEBARS WARRANT APR 13/70 SURVEY JUNE 13/70 PATENT AUG 2/70 To John Field Esq (In trust) P-41-48 "Mount Holly" | 24 K-124 JOHN CLARK WARRANT APR 13/70 SURVEY JUNE 13/70 PATENT AUG 2/70 To John Field Esq (In trust) P-39-282 "Northaven" | 37 C-74-34 DAVID PHILLIPS WARRANT APR 13/70 SURVEY JUNE 13/70 PATENT AUG 2/70 ON WARRANT TO ACCEPT DATED MARCH 1899 To John Field Esq (In trust) P-39-282 "Northaven" | 40 C-36-241 CORNELIUS COMERTS WARRANT APR 13/70 SURVEY JUNE 13/70 PATENT AUG 2/70 To John Field Esq (In trust) P-39-240 "Northaven" | 43 D-39-130 TRACT NO 2000 ROBERT KNAP WARRANT APR 13/70 SURVEY JUNE 13/70 PATENT AUG 2/70 ACT OF FEBRUARY RETURN AUG 28/99 |
| 12 A-20-291 THOMAS DOBSON WARRANT APR 13/70 SURVEY JUNE 13/70 PATENT AUG 2/70 To John Field Esq (In trust) P-39-277 "Northaven" | 25 C-36-275 TENCH COXE WARRANT APR 13/70 SURVEY JUNE 13/70 PATENT AUG 2/70 To John Field Esq (In trust) P-39-267 "Northaven" | 38 C-174-5 DAVID PHILLIPS WARRANT APR 13/70 SURVEY JUNE 13/70 PATENT AUG 2/70 ON WARRANT TO ACCEPT DATED MARCH 1899 To John Field Esq (In trust) P-39-282 "Northaven" | 41 C-36-272 STEPHEN COLLINS WARRANT APR 13/70 SURVEY JUNE 13/70 PATENT AUG 2/70 To John Field Esq (In trust) P-39-313 "Northaven" | 44 A-89-274 ELLIS WILLIAMS WARRANT DEC 13/81 SURVEY JUL 1/86 PATENT JUL 1/86 To John Field Esq (In trust) P-39-313 "Northaven" |
| 13 A-20-284 ARTHUR DONALDSON WARRANT APR 13/70 SURVEY JUNE 13/70 PATENT AUG 2/70 To John Field Esq (In trust) P-39-285 "Stafford" | 26 C-36-243 JOHN COXE WARRANT APR 13/70 SURVEY JUNE 13/70 PATENT AUG 2/70 To John Field Esq (In trust) P-39-285 "Stafford" | 39 C-36-272 DAVID PHILLIPS WARRANT APR 13/70 SURVEY JUNE 13/70 PATENT AUG 2/70 ON WARRANT TO ACCEPT DATED MARCH 1899 To John Field Esq (In trust) P-39-282 "Northaven" | 42 C-36-272 STEPHEN COLLINS WARRANT APR 13/70 SURVEY JUNE 13/70 PATENT AUG 2/70 To John Field Esq (In trust) P-39-313 "Northaven" | 45 A-89-274 ELLIS WILLIAMS WARRANT DEC 13/81 SURVEY JUL 1/86 PATENT JUL 1/86 To John Field Esq (In trust) P-39-313 "Northaven" |

A CONNECTED WARRANTEE TOWNSHIP MAP of Venango Township in Erie County. The warrants, surveys, and patents bearing, respectively, the dates as above set forth, are constructed from and have been compared with the original drafts on file in the Bureau of Land Records, Department of Internal Affairs, Commonwealth of Pennsylvania, under the direction of Blair A. Griffith, Director.

IN TESTIMONY WHEREOF, I have hereunto set my hand and caused the seal of the said Department to be affixed at Harrisburg, Pennsylvania, this twenty-first day of June A.D., one thousand nine hundred and sixty-eight.

John F. Talbot
Director of Internal Affairs

