

JEFFERSON TOWNSHIP.

Scale of 100 Rods to One Inch.

JOHN H. CAMPBELL,
CHIEF DRAFTSMAN.

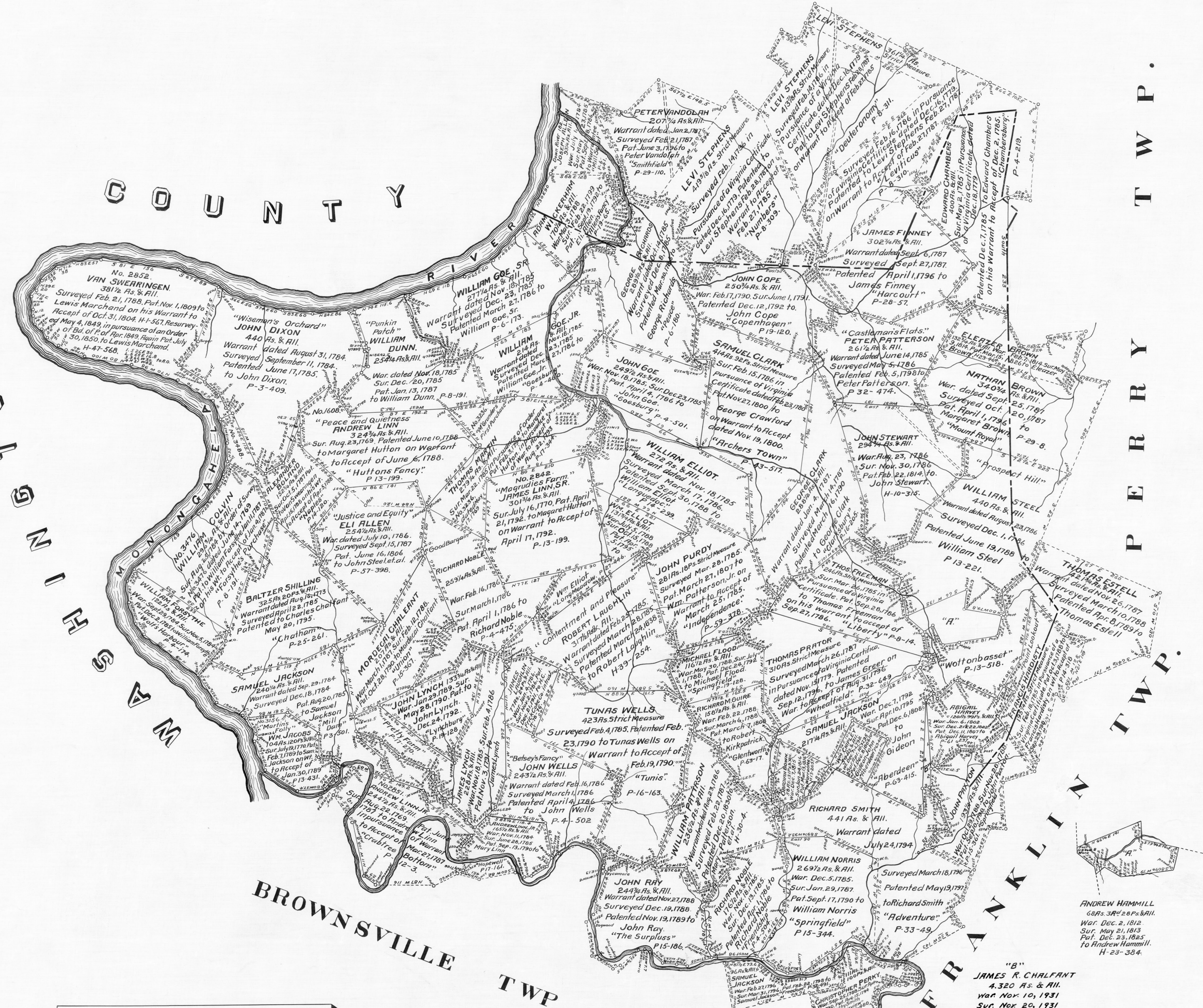

In Testimony, That the above is a connected draft of all the tracts of land situated in the township of Jefferson and County of Fayette; that the warrants, surveys and patents bear date respectively as above set forth, and that said draft was constructed from and compared with the original drafts remaining on file in the Department of Internal Affairs of Pennsylvania, I have hereunto set my hand and caused the Seal of said Department to be affixed, at Harrisburg, the seventeenth day of May, Anno Domini 1923.



J. T. Woodward
Secretary of Internal Affairs.