

CRAWFORD COUNTY

S A L E M T O W N S H I P

D E E R C R E E K T O W N S H I P

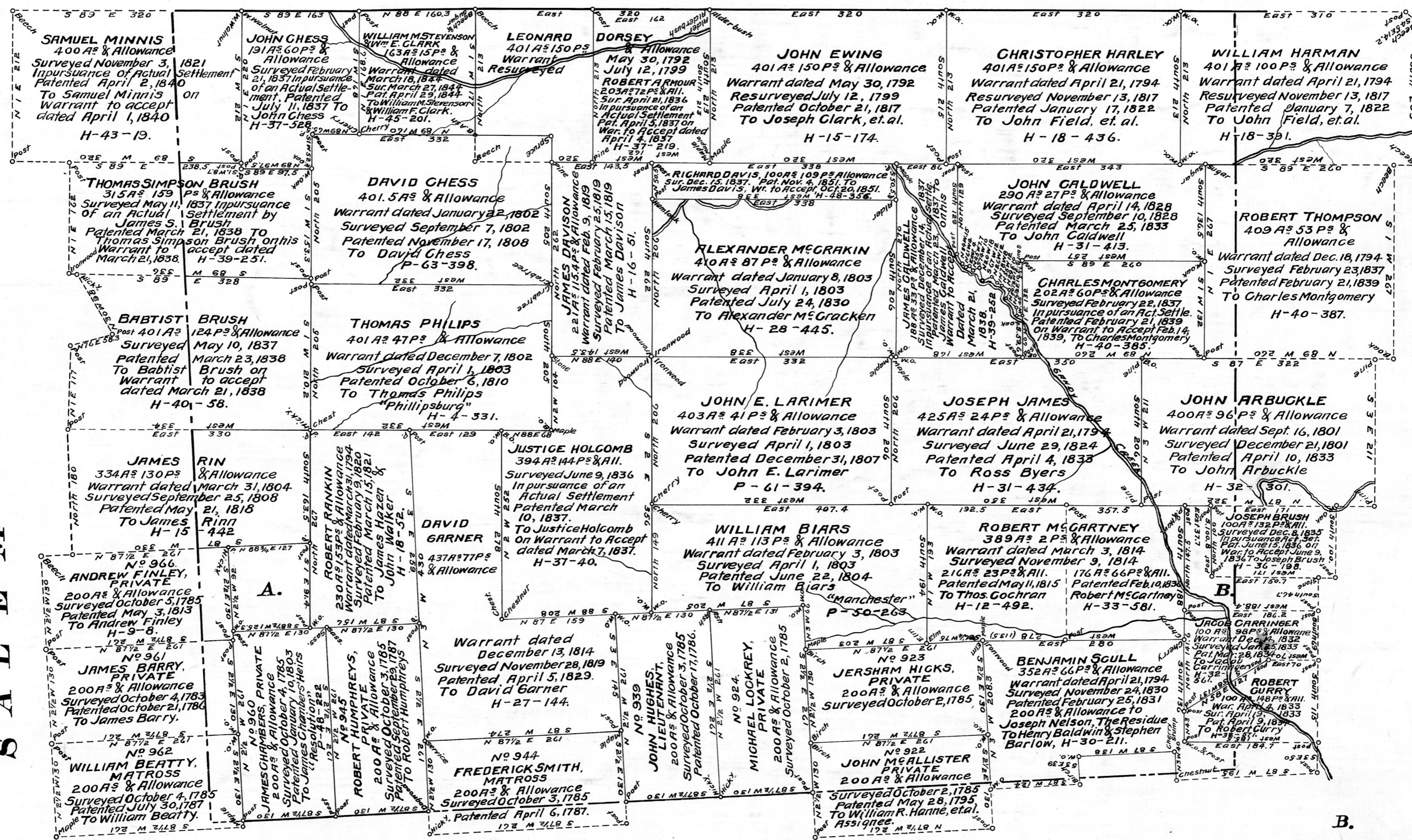

A.

JOHN CONDIT
68A² 5P² & Allowance
Surveyed September 10, 1849
In pursuance of an Actual Settlement
Patented February 15, 1850
To John Condit on Warrant
to Accept dated Feb. 14, 1850
H-47-377.

B.

JAMES BRUSH
74A² 4B² & Allowance
Surveyed December 23, 1837
In pursuance of an Actual Settlement
Patented March 23, 1838
To James Brush & Wife
on Warrant to Accept
dated March 21, 1838
H-39-253.

A CONNECTED DRAFT: of tracts of land situated in Sandy Creek Township, Mercer County. The Warrants, Surveys, and Patents bearing dates respectively set forth, constructed from and compared with the original drafts remaining on file in the Department of Internal Affairs, Harrisburg, Pennsylvania, under the direction of Warren J. Daniel, Director of the Land Office.

IN TESTIMONY WHEREOF: I have hereunto set my hand and caused the Seal of the said Department to be affixed at Harrisburg this eighth day of March A.D. 1946

William S. Livegood
Secretary of Internal Affairs

SANDY CREEK TOWNSHIP
MERCER COUNTY

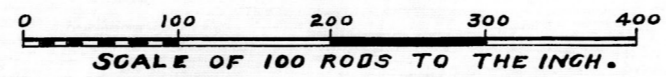

2945