

MIDDLEBURY TWP. CHATHAM TWP. MIDDLEBURY TWP.

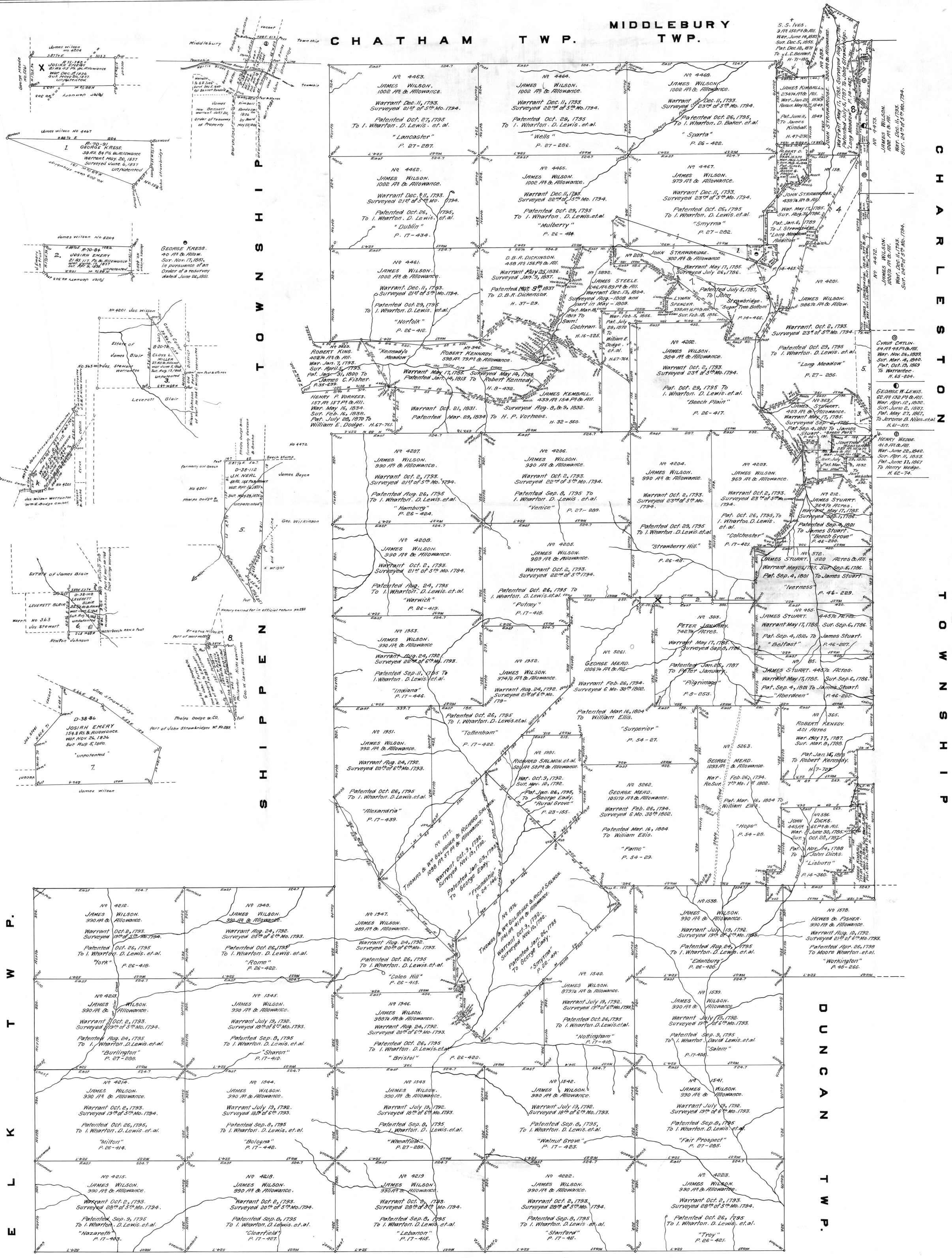

A CONNECTED Draft of all the tracts of Land situated in Delmar Township, Tioga County, the Warrants, Surveys and Patents bearing date respectively as above set forth, Constructed from and compared with the originals remaining on file in the Department of Internal Affairs of Pennsylvania. In TESTIMONY Whereof, I have hereunto set my Hand and caused the Seal of said Department to be affixed at Harrisburg the 1st day of January A.D. 1933.



Philip H. Dury  
Secretary of Internal Affairs.

DELMAR TOWNSHIP

Scale 1" = 100 Rods  
Warrant J. Daniel  
Director Land Office.