

NEW YORK STATE LINE
PENNSYLVANIA STATE LINE

STATE OF NEW YORK

NOTE: REVISED NOVEMBER 9, 1973 (See Trust Numbers 105, 106 and 107)

- 100-58 JOHN W. JAYNE
BY AIDES & ASSOCIATES
SURVEY JUL 2, 1974
PATENT MAR 19, 1981
TO: JOHN W. JAYNE
CONVEYED AT THE DATE
- 100-211 BRADLEY S. JAYNE
BY AIDES & ASSOCIATES
SURVEY JUL 2, 1974
PATENT MAR 19, 1981
TO: BRADLEY S. JAYNE
CONVEYED AT THE DATE
- 100-250 CAROL S. SHIFFRIN
BY AIDES & ASSOCIATES
SURVEY JUL 2, 1974
PATENT MAR 19, 1981
TO: CAROL S. SHIFFRIN
CONVEYED AT THE DATE

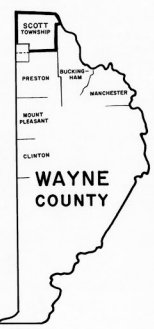
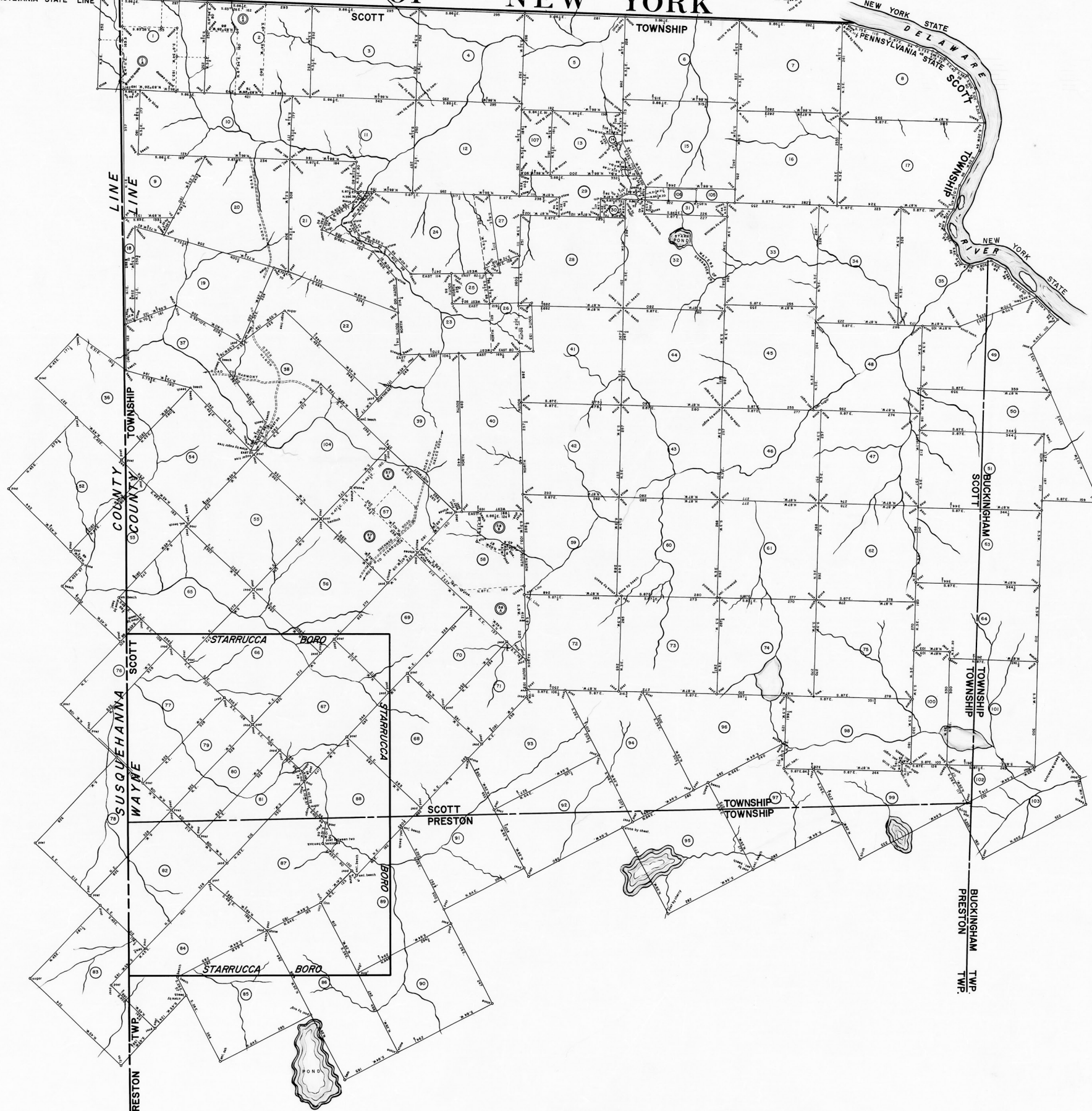

1 ROBERT TRAIL BY AIDES & ASSOCIATES SURVEY JUL 2, 1974 PATENT MAR 19, 1981 TO: ROBERT TRAIL CONVEYED AT THE DATE	12 BENJAMIN G. JAYNE BY AIDES & ASSOCIATES SURVEY JUL 2, 1974 PATENT MAR 19, 1981 TO: BENJAMIN G. JAYNE CONVEYED AT THE DATE	23 BENJAMIN G. JAYNE BY AIDES & ASSOCIATES SURVEY JUL 2, 1974 PATENT MAR 19, 1981 TO: BENJAMIN G. JAYNE CONVEYED AT THE DATE	34 SAMUEL BRINK BY AIDES & ASSOCIATES SURVEY JUL 2, 1974 PATENT MAR 19, 1981 TO: SAMUEL BRINK CONVEYED AT THE DATE	45 ABRAHAM VAUGHAN BY AIDES & ASSOCIATES SURVEY JUL 2, 1974 PATENT MAR 19, 1981 TO: ABRAHAM VAUGHAN CONVEYED AT THE DATE	56 JOHN PALMER BY AIDES & ASSOCIATES SURVEY JUL 2, 1974 PATENT MAR 19, 1981 TO: JOHN PALMER CONVEYED AT THE DATE	67 JOHN PALMER BY AIDES & ASSOCIATES SURVEY JUL 2, 1974 PATENT MAR 19, 1981 TO: JOHN PALMER CONVEYED AT THE DATE	78 JOHN PALMER BY AIDES & ASSOCIATES SURVEY JUL 2, 1974 PATENT MAR 19, 1981 TO: JOHN PALMER CONVEYED AT THE DATE	89 JOHN PALMER BY AIDES & ASSOCIATES SURVEY JUL 2, 1974 PATENT MAR 19, 1981 TO: JOHN PALMER CONVEYED AT THE DATE	90 JOHN PALMER BY AIDES & ASSOCIATES SURVEY JUL 2, 1974 PATENT MAR 19, 1981 TO: JOHN PALMER CONVEYED AT THE DATE	91 JOHN PALMER BY AIDES & ASSOCIATES SURVEY JUL 2, 1974 PATENT MAR 19, 1981 TO: JOHN PALMER CONVEYED AT THE DATE	92 JOHN PALMER BY AIDES & ASSOCIATES SURVEY JUL 2, 1974 PATENT MAR 19, 1981 TO: JOHN PALMER CONVEYED AT THE DATE	93 JOHN PALMER BY AIDES & ASSOCIATES SURVEY JUL 2, 1974 PATENT MAR 19, 1981 TO: JOHN PALMER CONVEYED AT THE DATE	94 JOHN PALMER BY AIDES & ASSOCIATES SURVEY JUL 2, 1974 PATENT MAR 19, 1981 TO: JOHN PALMER CONVEYED AT THE DATE	95 JOHN PALMER BY AIDES & ASSOCIATES SURVEY JUL 2, 1974 PATENT MAR 19, 1981 TO: JOHN PALMER CONVEYED AT THE DATE	96 JOHN PALMER BY AIDES & ASSOCIATES SURVEY JUL 2, 1974 PATENT MAR 19, 1981 TO: JOHN PALMER CONVEYED AT THE DATE	97 JOHN PALMER BY AIDES & ASSOCIATES SURVEY JUL 2, 1974 PATENT MAR 19, 1981 TO: JOHN PALMER CONVEYED AT THE DATE	98 JOHN PALMER BY AIDES & ASSOCIATES SURVEY JUL 2, 1974 PATENT MAR 19, 1981 TO: JOHN PALMER CONVEYED AT THE DATE	99 JOHN PALMER BY AIDES & ASSOCIATES SURVEY JUL 2, 1974 PATENT MAR 19, 1981 TO: JOHN PALMER CONVEYED AT THE DATE	100 JOHN PALMER BY AIDES & ASSOCIATES SURVEY JUL 2, 1974 PATENT MAR 19, 1981 TO: JOHN PALMER CONVEYED AT THE DATE
---	--	--	--	--	--	--	--	--	--	--	--	--	--	--	--	--	--	--	---

A CONNECTED WARRANTEED TOWNSHIP MAP of Scott Township in Wayne County. The warrants, surveys and patents bearing, respectively, the dates as above set forth, are constructed from and have been compared with the original drafts on file in the Bureau of Land Records, Department of Community Affairs, Commonwealth of Pennsylvania, under the direction of Edward D. Price, Director.

IN TESTIMONY WHEREOF: I have hereunto set my hand and caused the seal of the said Department to be affixed at Harrisburg, Pennsylvania, this seventh day of August A. D., one thousand nine hundred and seventy three.

Edward D. Price
Secretary of Community Affairs

NOTE
REVISED NOVEMBER 9, 1973
Listed Herein(3) more towns
Not listed of 107 town lots.