

# POTTER

# PORTAGE AND LUMBER TOWNSHIP

JOHN H. CAMPBELL,  
CHIEFDRAFTSMAN.

# COUNTY

# TOWNSHIP

# SHIPPEN

# GROVE TOWNSHIP

# GIBSON TOWNSHIP

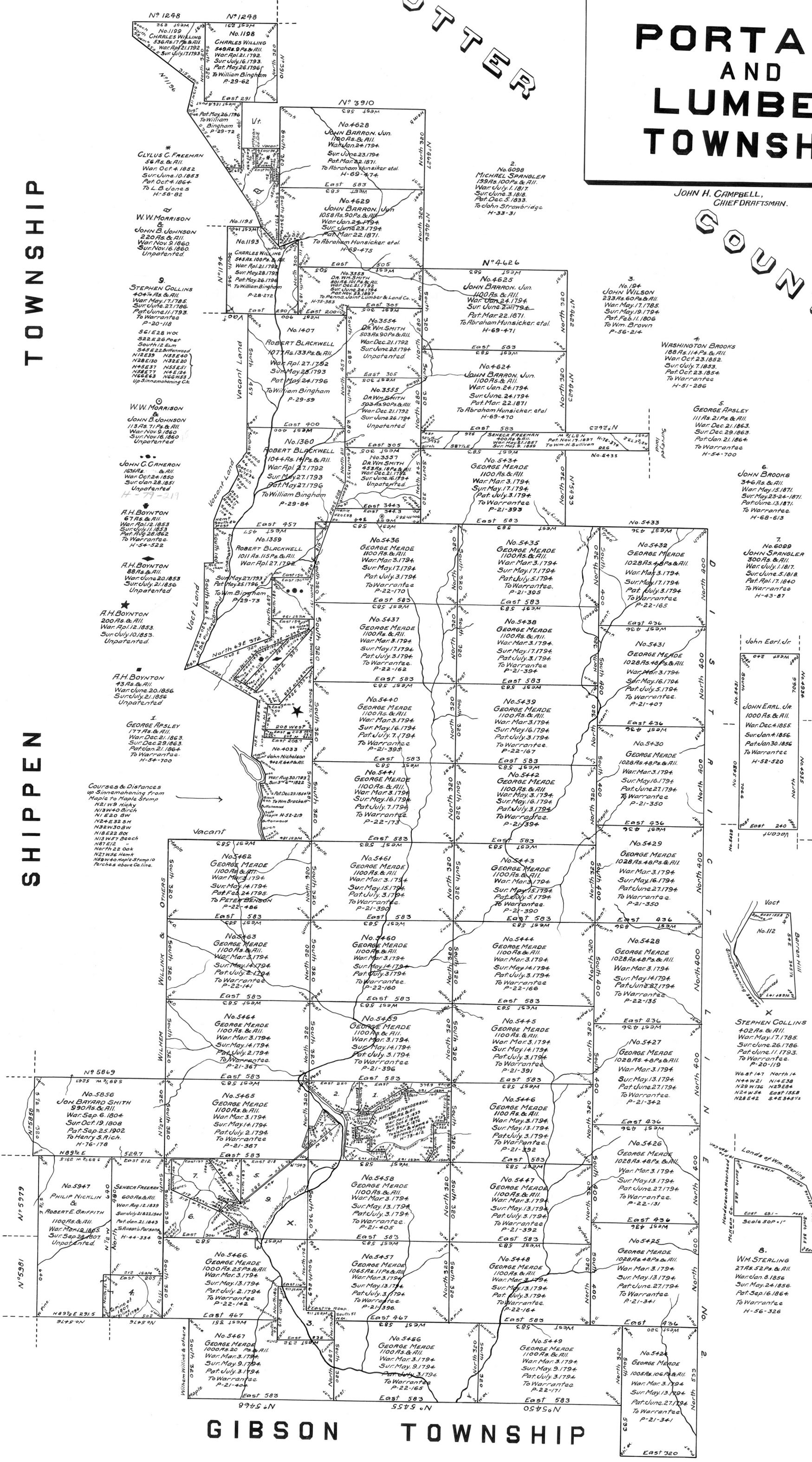

In Testimony, that the above is a connected draft of seventy-eight tracts of land situated in the townships of Portage and Lumber and County of Cameron; that the warrants, surveys and patents bear date respectively as above set forth, and that said draft was constructed from and compared with the original drafts remaining on file in the Department of Internal Affairs of Tennessee, I have hereunto set my hand and caused the Seal of the said Department to be affixed, at Harrisburg, the eighteenth day of April, Anno Domini 1923.

*Jan. F. Woodard*  
Secretary of Internal Affairs