

Scale: 1" = 60 Perches

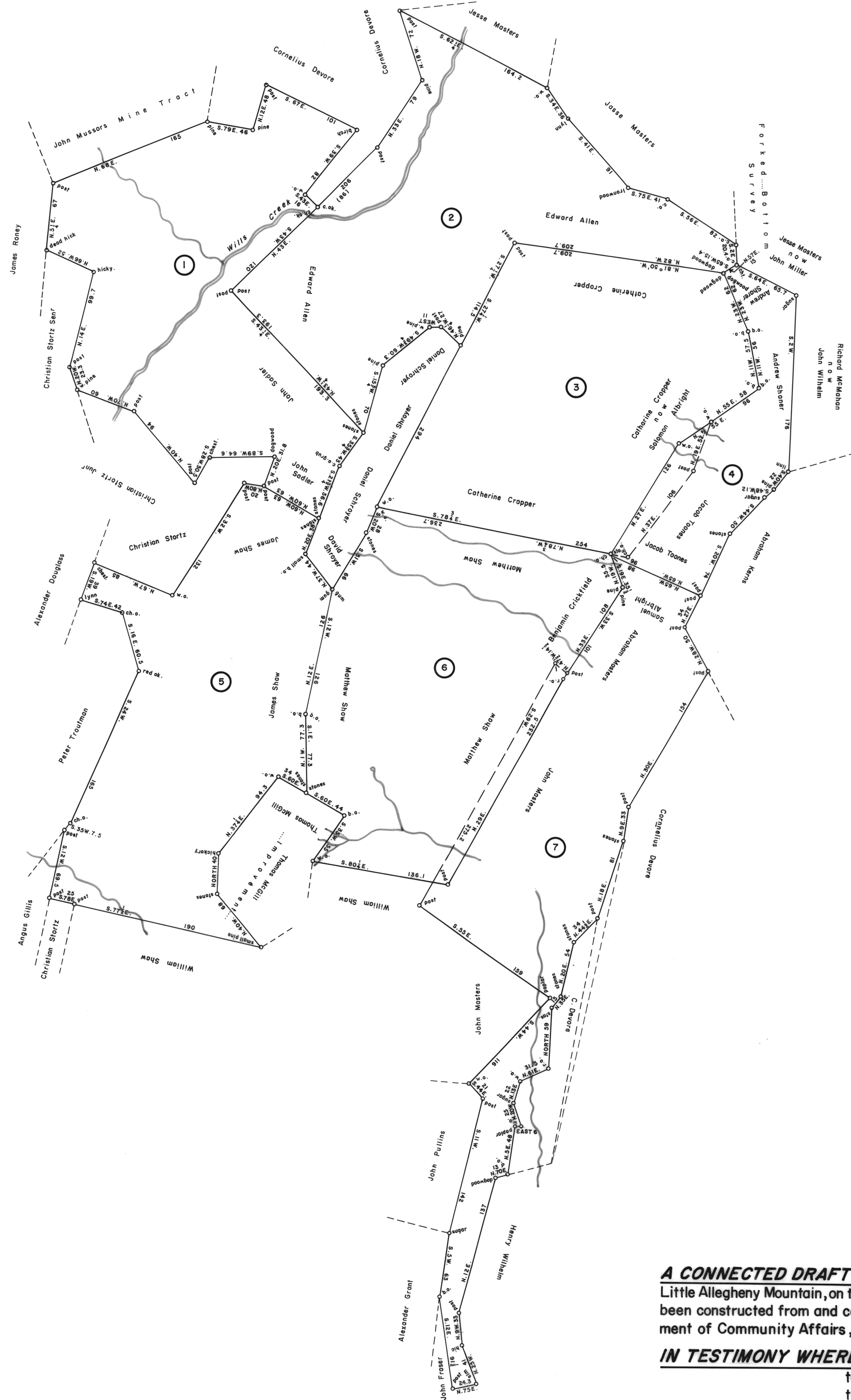

- | | |
|--|---|
| <p>①
T—21
JOHN SADLER
438 ACRES—120 PERCHES & 110 W
WARRANT JUL. 19, 1793
SURVEY JUL. 4, 1795
PATENT APR. 14, 1812
To—William McCulloch
H—7—101
"The Fan"</p> | <p>②
A—10—11
EDWARD ALLEN
464 ACRES & 110 W & 124
WARRANT JUL. 19, 1793
SURVEY JUL. 2, 1795
PATENT APR. 14, 1812
To—William McCulloch
H—7—96
"Hope"</p> |
| <p>③
A—26—179
CATHARINE CROPPER
448 ACRES—120 PERCHES & 110 W
WARRANT JUL. 19, 1793
SURVEY JUL. 2, 1795
PATENT APR. 16, 1807
To—George M. and Clarence Miller
H—77—238</p> | <p>④
C—179—143
ARTHUR MCGAUGHEY
144 ACRES & 110 W & 100
WARRANT MAY 9, 1791
SURVEY (re-survey) SEPT. 10, 1839
PATENT JUN. 14, 1855
To—John Wilhelm
H—52—322</p> |
| <p>⑤
S—245
JAMES SHAW
450 ACRES—80 PERCHES & 110 W
WARRANT JUL. 19, 1793
SURVEY JUL. 1, 1795
PATENT SEPT. 23, 1807
To—David Jourdan
H—61—190
"Rapho"</p> | <p>⑥
C—204—66
MATTHEW SHAW
447 ACRES—80 PERCHES & 110 W
WARRANT JUL. 19, 1793
SURVEY JUL. 2, 1795
PATENT JUL. 2, 1816
To—Benjamin O. Hodges, Adm. (in trust)
H—13—616</p> |
| | <p>⑦
C—56—44
JOHN MABEN (MABIN)
391 ACRES—74 PERCHES & 110 W
WARRANT MAY 20, 1794
SURVEY OCT. 10, 1839
PATENT MAR. 5, 1859
To—Cornelius Devore
H—47—118</p> |

A CONNECTED DRAFT. of seven (7) tracts of land, which when surveyed, were situate on the East Side of the Little Allegheny Mountain, on the Waters of Wills Creek in Londonderry Township, Bedford County. The draft has been constructed from and compared with the original drafts on file in the Bureau of Land Records, Department of Community Affairs, Commonwealth of Pennsylvania, under the direction of Edward Price, Director.

IN TESTIMONY WHEREOF. I have hereunto set my hand and caused the seal of the said Department to be affixed at Harrisburg, Pennsylvania, this sixth day of February A.D., one thousand nine hundred and seventy nine.

Karl C. Smith
KARL C. SMITH, Acting Secretary of Community Affairs