

SCALE: 1" = 60 RODS

①
C — 1 — 274
JOHN R. WEEKS
416 ACRES—29 Perches & All.
WARRANT — JULY 15, 1854
SURVEY—AUG. 2nd, 3rd, 21st, 22nd, 1854
PATENT — OCT. 31, 1864
TO — FREEDOM IRON CO.
H — 58 — 362

②
C — 1 — 272
J. R. WEEKES
429 ACRES—45 Perches & All.
WARRANT — AUG. 11, 1854
SURVEY—AUG. 19th, 21st, 1854
PATENT — OCT. 31, 1864
TO — FREEDOM IRON CO.
H — 60 — 208

③
C — 21 — 91
JOHN R. BRICKER
231 ACRES—68 Perches & All.
WARRANT — DEC. 14, 1882
SURVEY—OCT. 24th, 25th, 1883
PATENT — JAN. 15, 1884
TO — JOHN R. BRICKER
H — 74 — 455

④
D — 33 — 168
GEORGE W. FILSON
105 ACRES—144 Perches & All.
WARRANT — MAY 21, 1856
SURVEY — MAY 21, 1872
PATENT — THIS TRACT OF LAND
WAS TRANSFERRED TO THE PENNA.
STATE FORESTRY RESERVE.

⑤
C — 43 — 242
JOHN EAKENS
364 ACRES—84 Perches & All.
WARRANT — MAY 26, 1813
SURVEY — JUNE 26, 1823
RE-SURVEYED AND CORRECTED ON
AUG. 19th & OCT. 6th & 7th — 1854
AND AUG. 15th — 1856 FOR JOHN
R. WEEKS AND EDMUND L. FAXON.
PATENT — OCT. 31, 1864
TO — FREEDOM IRON CO.
H — 60 — 206

⑥
C — 135 — 48
ISRAEL MUSGRAVE
324 ACRES—120 Perches & All.
WARRANT — FEB. 24, 1774
SURVEY — MAY 17, 1774
PATENT — OCT. 3, 1781
TO — DANIEL WILLIAMS
P — 1 — 80
"Fairland"

⑦
C — 1 — 275
BENJAMIN DAVIS
322 ACRES—162 Perches & All.
WARRANT — FEB. 24, 1774
SURVEY — MAY 17, 1774
PATENT — OCT. 3, 1781
TO — DANIEL WILLIAMS
P — 1 — 77
"Richland"

⑧
D — 47 — 23
MOSES A. SAMPLE
20 ACRES—119 Perches & All.
WARRANT — AUG. 14, 1854
SURVEY — AUG. 22, 1854
UNPATENTED AT THIS DATE

⑫
C — 146 — 111
JOHN Mc CLENAHAN
430 ACRES—125 Perches & All.
WARRANT — JAN. 26, 1815
SURVEY — MAY 2, 1816
RE-SURVEY — MAY 17, 1838
PATENT — APRIL 25, 1839
TO — WILLIAM SNOOK
H — 41 — 30

⑪
C — 203 — 281
JOHN STARRETT
100 ACRES—140 Perches & All.
WARRANT — JUNE 7, 1816
SURVEY — DEC. 1, 1840
PATENT — MARCH 28, 1873
TO — ISAAC PETER
H — 70 — 784

⑩
C — 233 — 89
HUGH SAMPLE
52 ACRES—135 Perches & All.
WARRANT — MARCH 1, 1848
SURVEY — MARCH 20, 1854
PATENT — DEC. 26, 1871
TO — ISAAC PETER
H — 71 — 150

⑨
D — 47 — 82
ISAAC PETER
41 ACRES—59 Perches & All.
WARRANT — MARCH 29, 1881
SURVEY — MAY 5, 1881
UNPATENTED AT THIS DATE

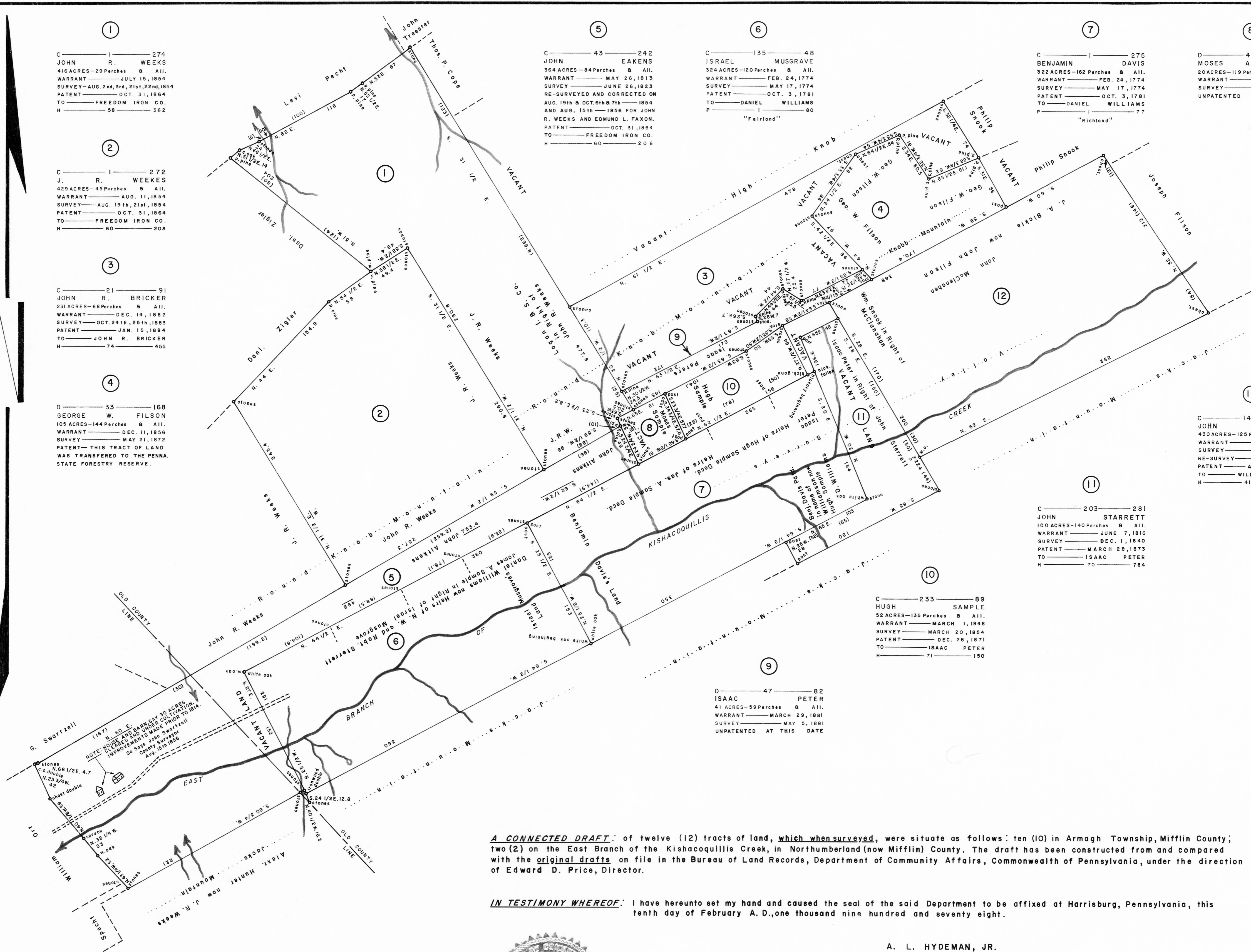

A CONNECTED DRAFT of twelve (12) tracts of land, which when surveyed, were situate as follows: ten (10) in Armagh Township, Mifflin County; two (2) on the East Branch of the Kishacoquillis Creek, in Northumberland (now Mifflin) County. The draft has been constructed from and compared with the original drafts on file in the Bureau of Land Records, Department of Community Affairs, Commonwealth of Pennsylvania, under the direction of Edward D. Price, Director.

IN TESTIMONY WHEREOF: I have hereunto set my hand and caused the seal of the said Department to be affixed at Harrisburg, Pennsylvania, this tenth day of February A. D., one thousand nine hundred and seventy eight.

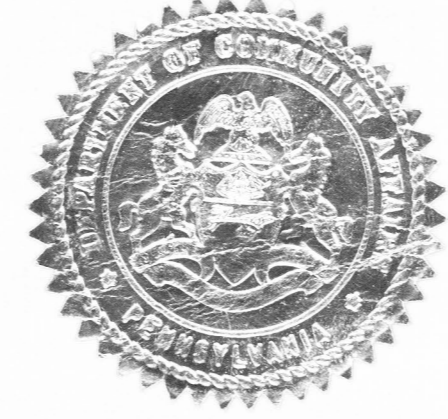

A. L. HYDEMAN, JR.
Secretary of Community Affairs

By: James G. Shultz
James G. Shultz, Executive Deputy Secretary

1606

447