

Scale 1" = 60 Rods

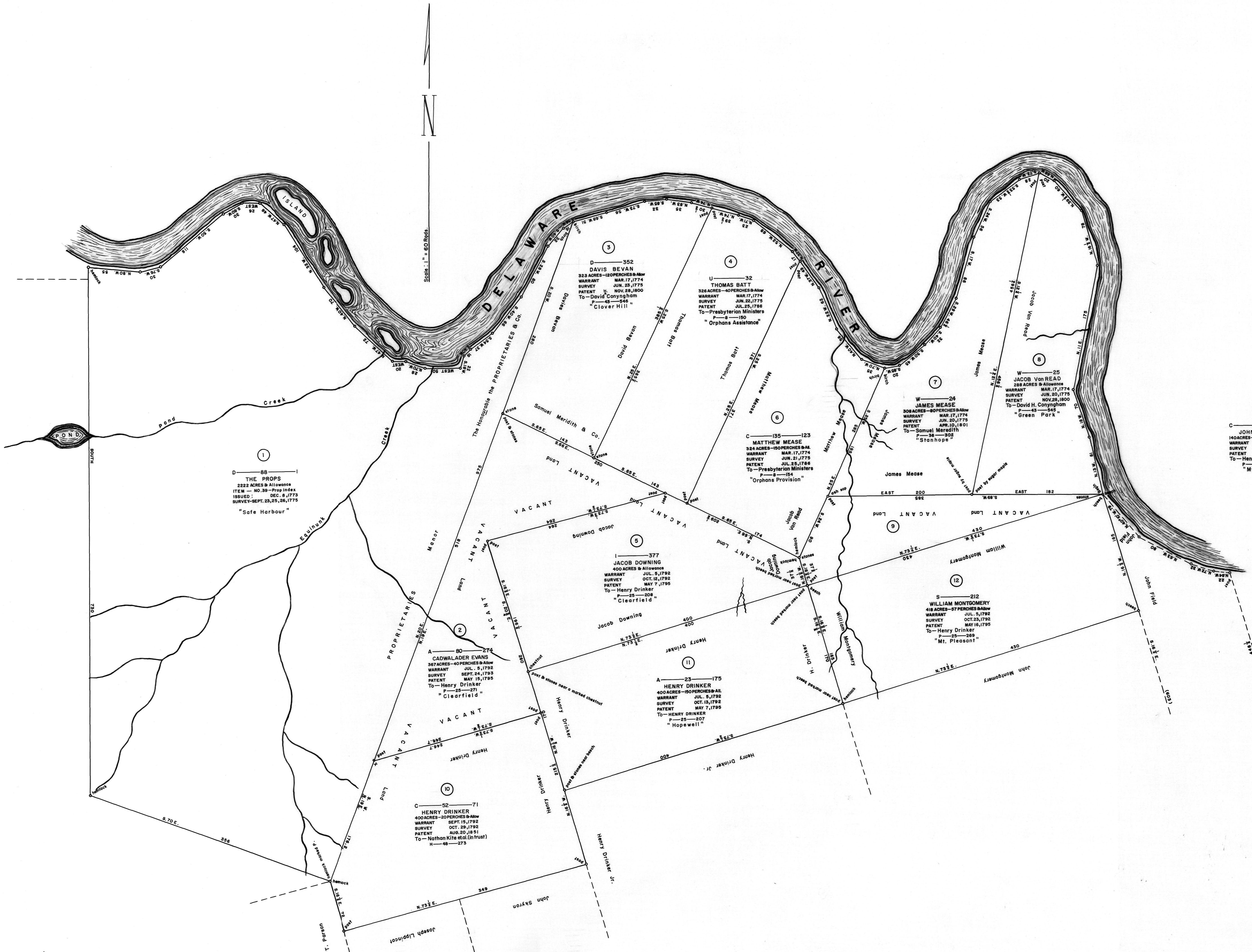

1  
D—88—1  
THE PROPS  
2222 ACRES & Allowance  
ITEM—NO. 39—Prop Index  
ISSUED—SEC. 8, 1775  
SURVEY—SEPT. 23, 25, 26, 1775  
"Safe Harbour"

2  
A—80—274  
CADWALADER EVANS  
367 ACRES—40 PERCHES & Allowance  
WARRANT JUL. 5, 1792  
SURVEY SEPT. 25, 1793  
PATENT MAY 15, 1795  
To—Henry Drinker  
P—25—271  
"Clearfield"

10  
C—52—71  
HENRY DRINKER  
400 ACRES—50 PERCHES & Allowance  
WARRANT SEPT. 15, 1792  
SURVEY OCT. 28, 1792  
PATENT AUG. 20, 1818  
To—Nathaniel Kite and (contract)  
P—25—272

5  
377  
JACOB DOWNING  
400 ACRES & Allowance  
WARRANT JUL. 5, 1792  
SURVEY OCT. 15, 1792  
PATENT MAY 7, 1795  
To—Henry Drinker  
P—25—268  
"Clearfield"

11  
A—25—175  
HENRY DRINKER  
400 ACRES—50 PERCHES & Allowance  
WARRANT JUL. 5, 1792  
SURVEY OCT. 15, 1792  
PATENT MAY 7, 1795  
To—HENRY DRINKER  
P—25—267  
"Clearfield"

3  
D—352  
DAVIS BEVAN  
323 ACRES—50 PERCHES & Allowance  
WARRANT MAR. 17, 1774  
SURVEY JUN. 25, 1775  
PATENT NOV. 28, 1800  
To—David Conyngham  
P—43—346  
"Clover Hill"

4  
U—32  
THOMAS BATT  
326 ACRES—50 PERCHES & Allowance  
WARRANT MAR. 17, 1774  
SURVEY JUN. 25, 1775  
PATENT JUL. 25, 1788  
To—Presbyterian Ministers  
P—2—150  
"Orphans Assistance"

6  
C—135—123  
MATTHEW MEASE  
324 ACRES—50 PERCHES & Allowance  
WARRANT MAR. 17, 1774  
SURVEY JUN. 25, 1775  
PATENT JUL. 25, 1788  
To—Presbyterian Ministers  
P—2—154  
"Orphans Provision"

7  
W—26  
JAMES MEASE  
308 ACRES—50 PERCHES & Allowance  
WARRANT MAR. 17, 1774  
SURVEY JUN. 20, 1775  
PATENT APR. 10, 1801  
To—Samuel Meredith  
P—38—522  
"Stanhope"

8  
W—25  
JACOB VON READ  
288 ACRES & Allowance  
WARRANT MAR. 17, 1774  
SURVEY JUN. 20, 1775  
PATENT NOV. 28, 1800  
To—David H. Conyngham  
P—43—345  
"Green Park"

9  
C—154—239  
JOHN MCCAHAN  
140 ACRES—50 PERCHES & Allowance  
WARRANT DEC. 31, 1792  
SURVEY SEPT. 26, 1793  
PATENT SEPT. 19, 1795  
To—Henry Drinker  
P—25—275  
"Mt. Hope"

A CONNECTED DRAFT of twelve (12) tracts of land, when surveyed, were situate on the West Side of the Delaware River in Manchester Township, Northampton (now Wayne) County. The draft has been constructed from and compared with the original drafts on file in the Bureau of Land Records, Department of Community Affairs, Commonwealth of Pennsylvania, under the direction of Edward D. Price, Director.

IN TESTIMONY WHEREOF: I have hereunto set my hand and caused the seal of the said Department to be affixed at Harrisburg, Pennsylvania this ninth day of March A. D., one thousand nine hundred and seventy two.

WILLIAM H. WILCOX  
Secretary of Community Affairs

By: *A. L. Hydemann, Jr.*  
A. L. HYDEMAN, JR., Executive Deputy Secretary

1721

64.5