

North

nos 18

1.08 1288
 4.00 1288 1/2 E
 7.27 1260 1/2 E
 200 1264 1/2 E
 1.27 1261 1/2 E
 3.00 1279 1/2 E
 5.00 1279 1/2 E
 2.20 1270 1/2 E
 2.15 off road to the right 1280
 5.08 1218 E
 6.00 1218 E
 0.11 1220 E
 5.19 1251 1/2 W off road to the right 1219
 5.19 1218 E
 5.21 1245 1/2 E
 3.00 due to the road 1219
 0.25 1248 1/2 E
 4.00 1271 1/2 E
 7.27 1260 1/2 E
 4.22 1229 1/2 E
 6.27 1250 1/2 E
 2.00 1279 1/2 E
 4.00 1280 1/2 E

920 1268 1/2 W 400 1261 1/2 E
 500 1260 W 400 1261 E
 931 400 1257 1/2 W
 932 400 1254 1/2 W
 933 400 1242 W
 934 400 1237 W
 935 400 1233 W
 200 1230 E
 400 1228 E
 600 1215 E
 936 200 1225 E
 400 1245 E
 937 400 1245 E
 938 200 1245 E
 939 200 1245 E

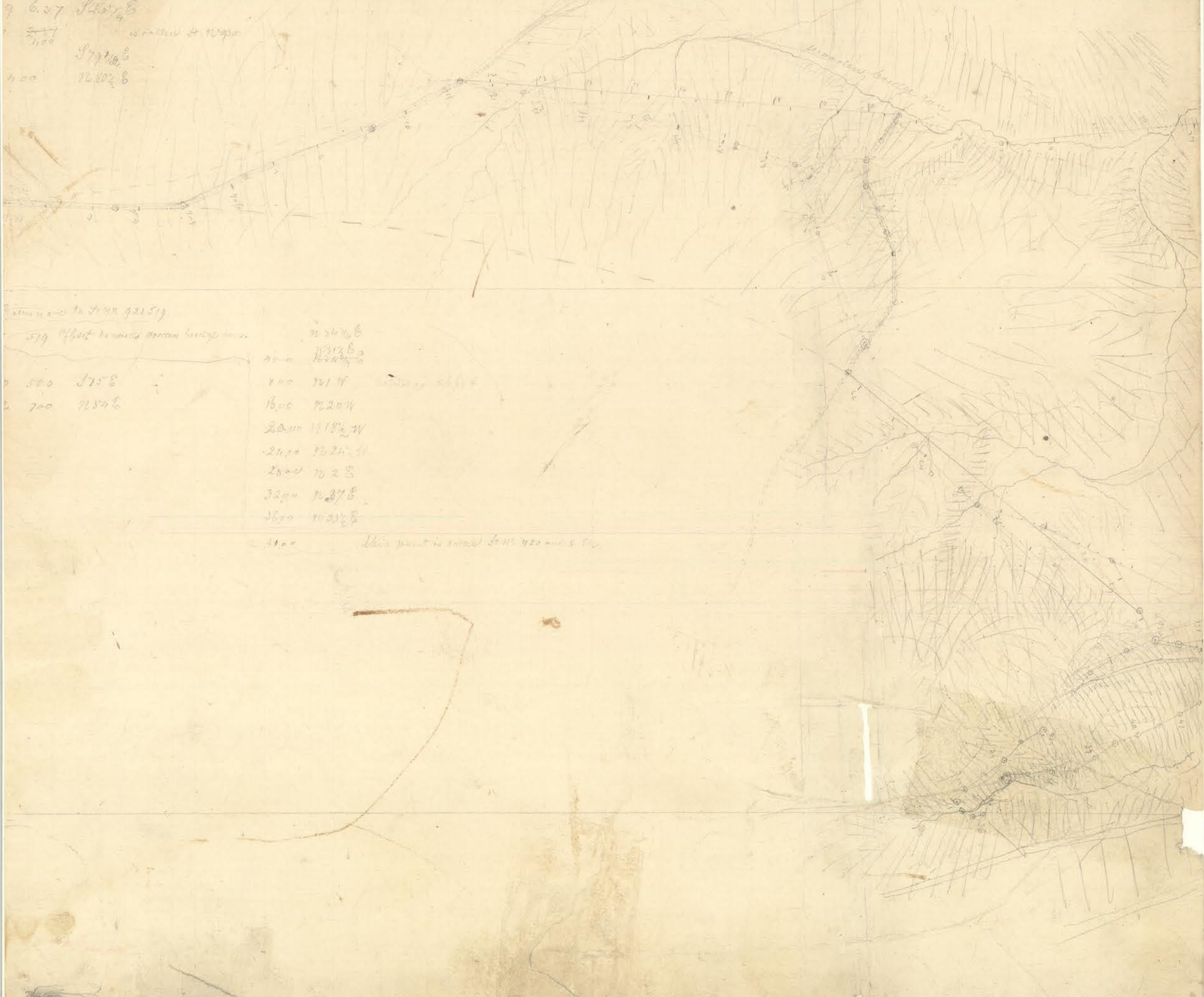

519 off road to the right 1219
 500 1275 E
 700 1254 E
 700 1254 E
 1600 1220 W
 2000 1218 1/2 W
 2500 1224 1/2 W
 2800 1223 E
 3200 1237 E
 3600 1232 E
 4100 this point is shown 1215 1220 and 1219