

16
Stations

Section No 11

Cubic Yards
Exc Emb

No Dist
150 50ft

Am't Brod over

16056.52

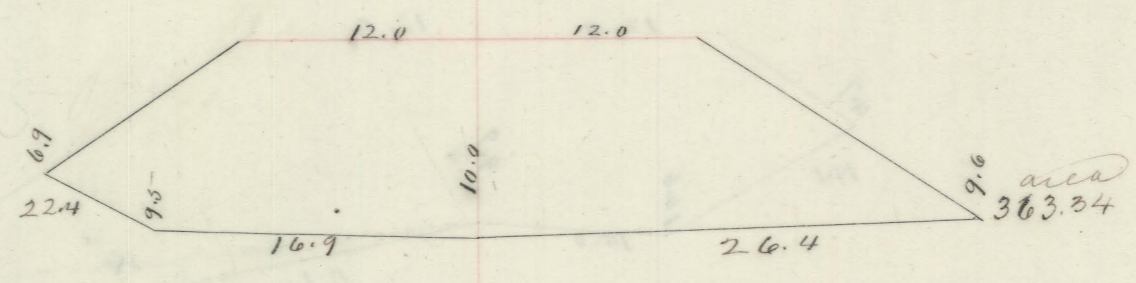

590.56

1/3 50"

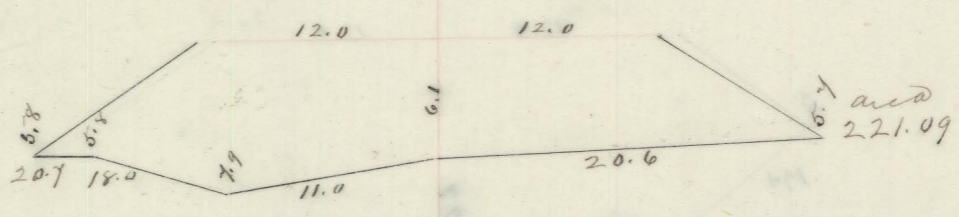

273.30

+30 50"

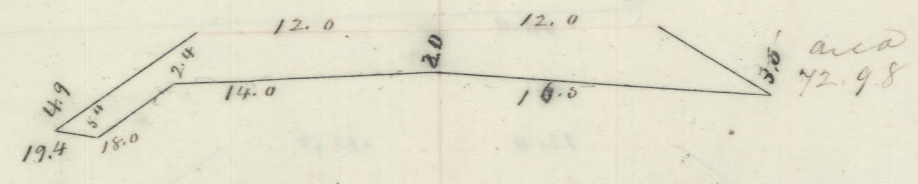

155.26

1/6 50"

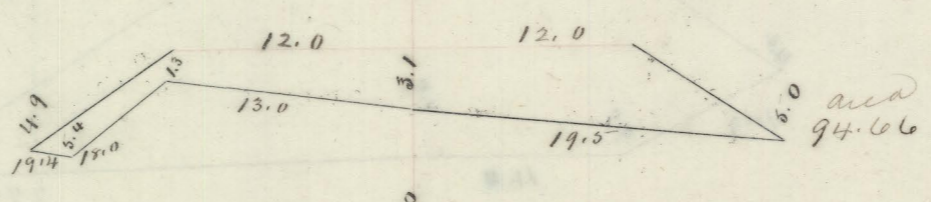

95.98

+30 50"

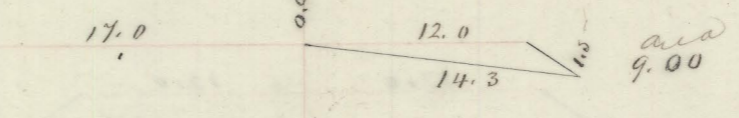

4.93

+74 24"

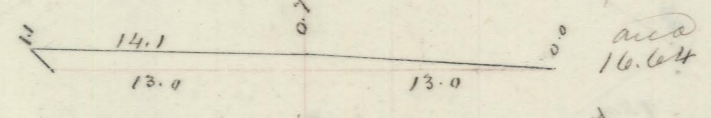

35.99

1/7 20"

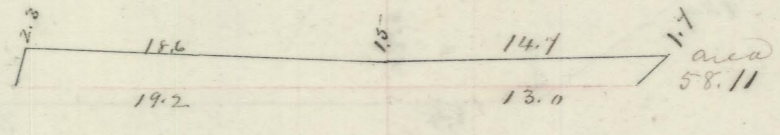

223.19

+30 50"

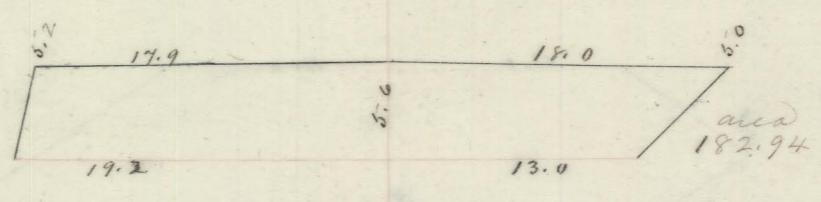

416.84

1/8 50"

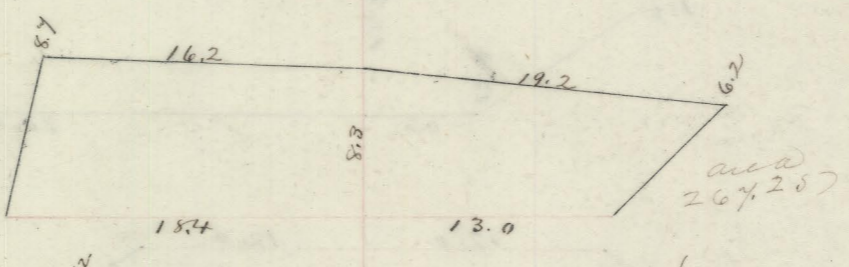

1301.60

1/9 100"

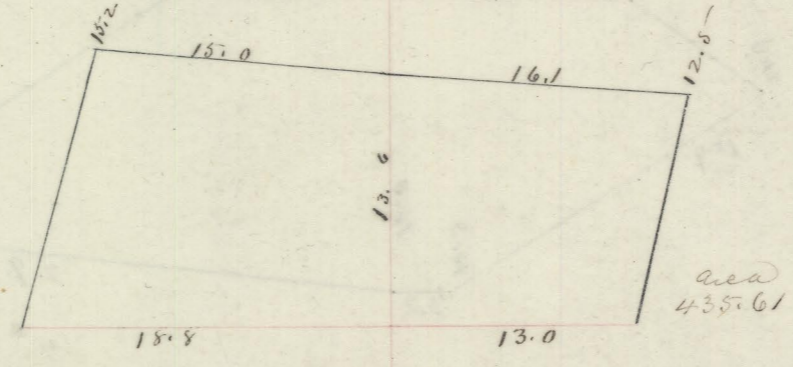

929.06

+30 50"

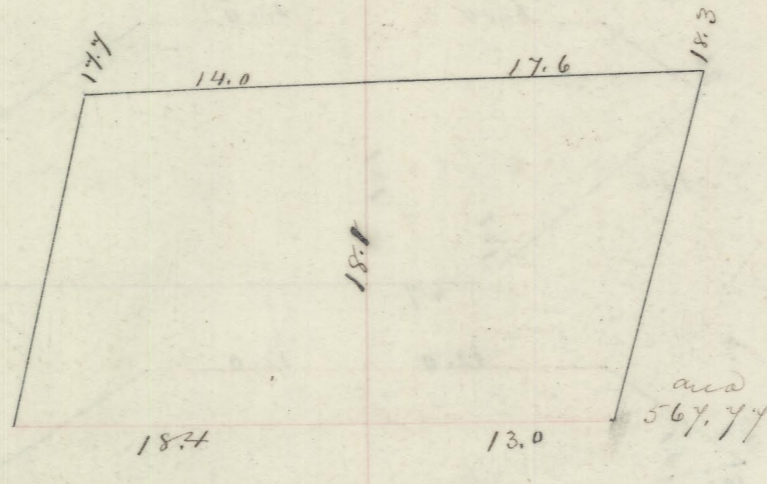

2911.61

Deduct 227.34 by diff. (amb) 227.34
Total Amb 17785.42

18012.76

227.34

17785.42