

Stations
No Dist

Section No 12

25 Cubic Yards
Exc Emb

+50 50 ft

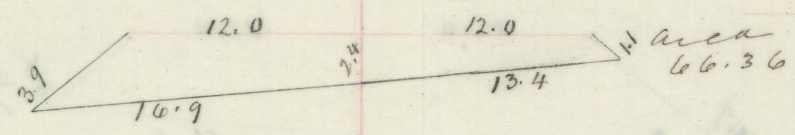

Amb Barb over

6987.45 155.69
93.22
147.27

116 50 "

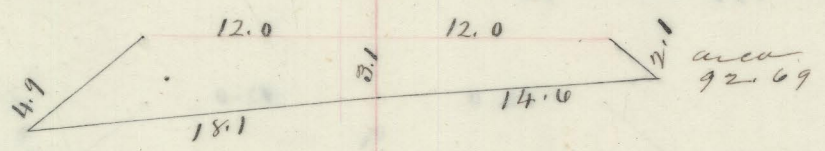

160.05

+50 50 "

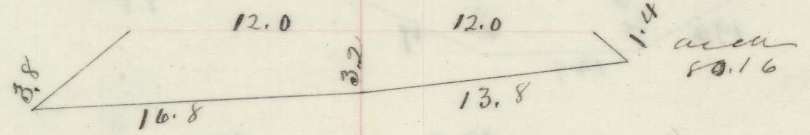

159.53

117 50 "

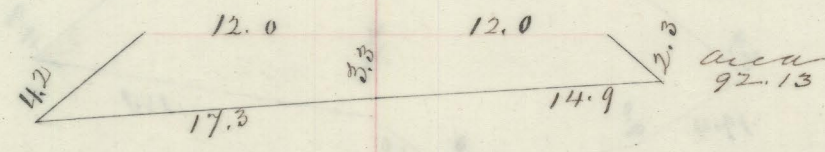

368.28

118 100 "

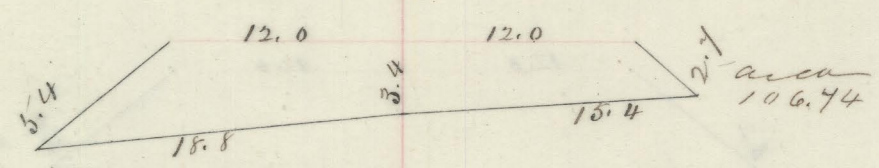

149.30

+50 50 "

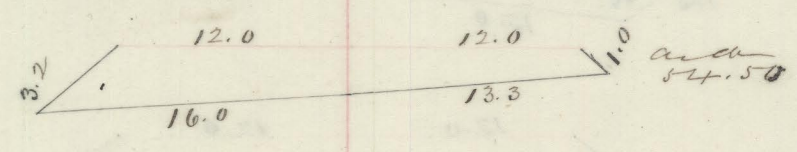

118.96

119 50 "

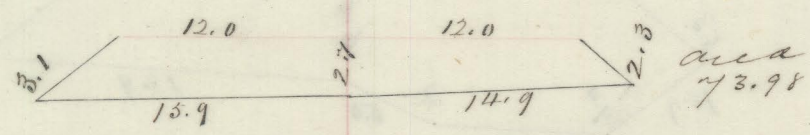

293.63

120 100 "

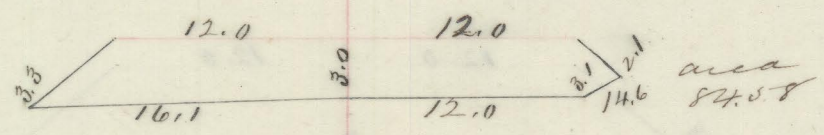

63.61

+20 20 "

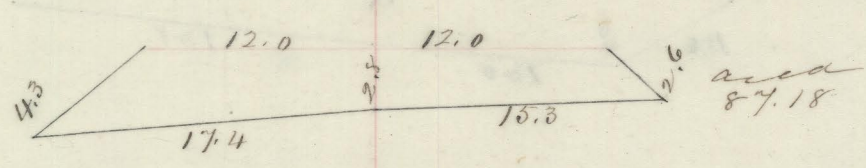

118.85

+45 25 "

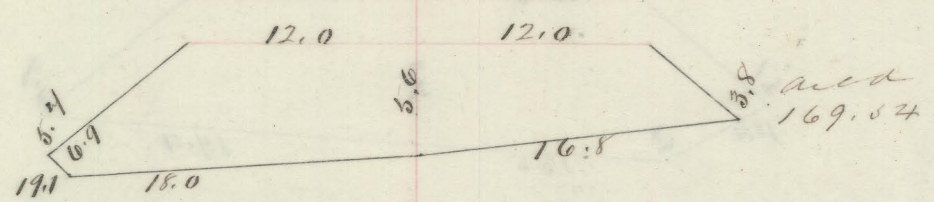

146.82

+70 25 "

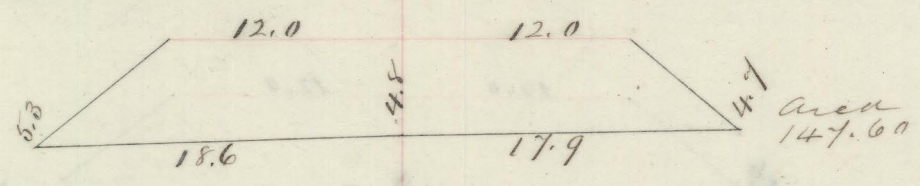

206.15

121 30 "

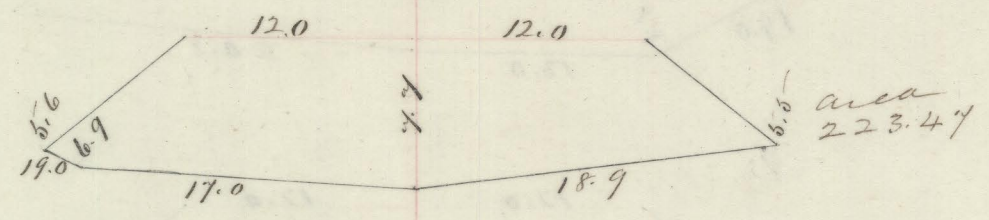

305.40

+50 50 "

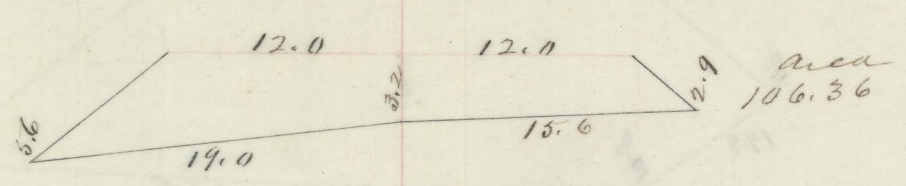

199.45

122 50 "

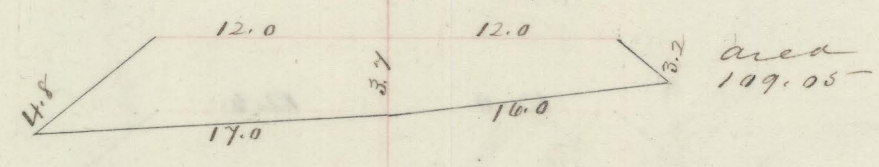

180.91

+32 32 "

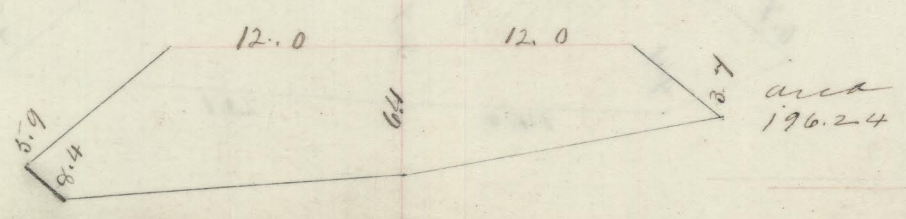

Total Amb

6987.45 2867.12