

Stations No 26
No dish

Section No 12

Cubic Yards
Area Emb

Amh Prob cov

+54 22 ft

123 78"

+20 20"

+40 20"

+72 32"

124 38"

+50 50"

125 50"

+31 31"

+70 39"

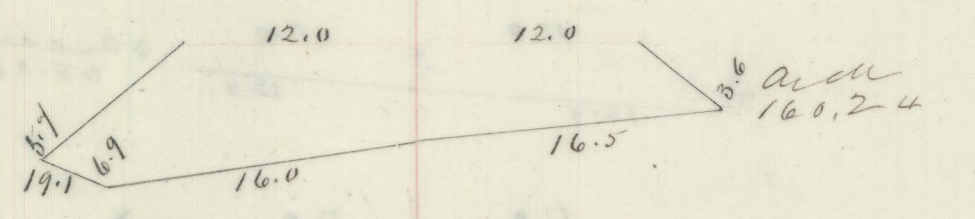

6987.45 2867.12
145.23

311.75

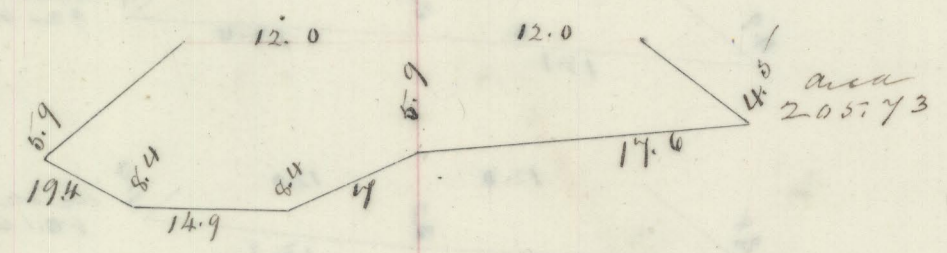

169.85

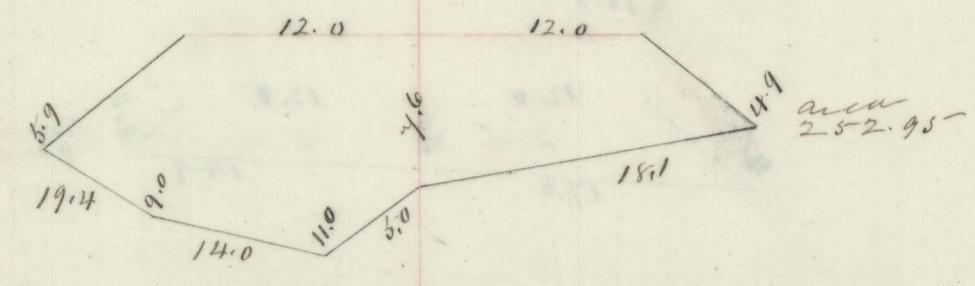

163.37

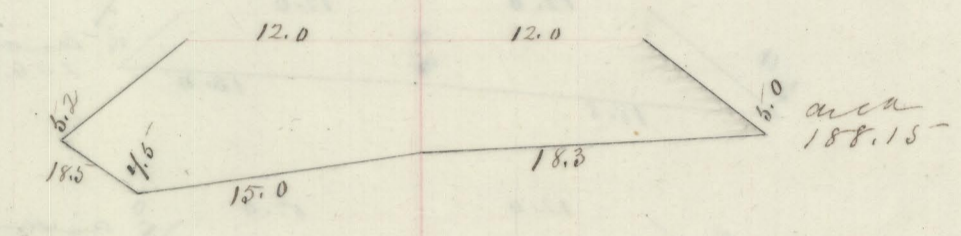

246.86

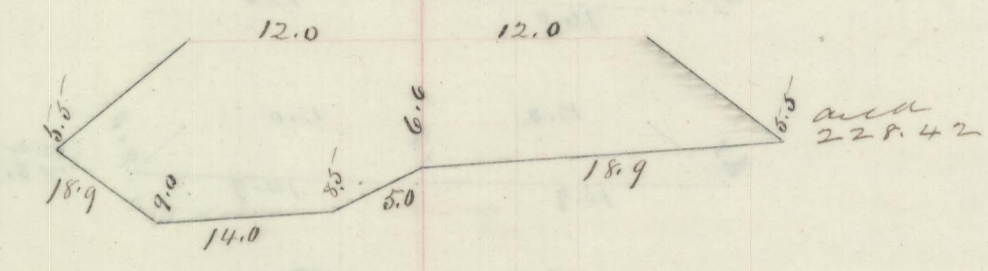

236.69

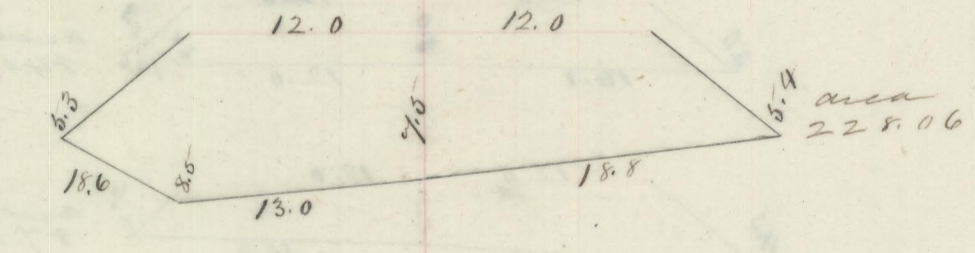

419.75

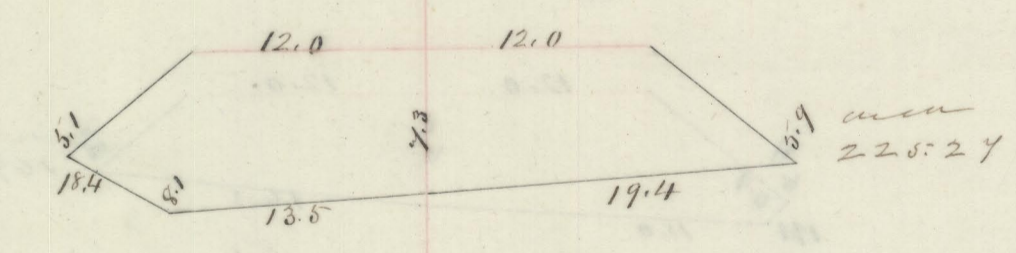

453.73

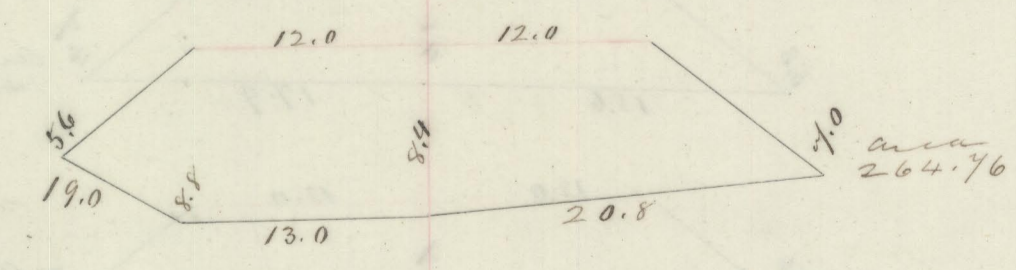

363.68

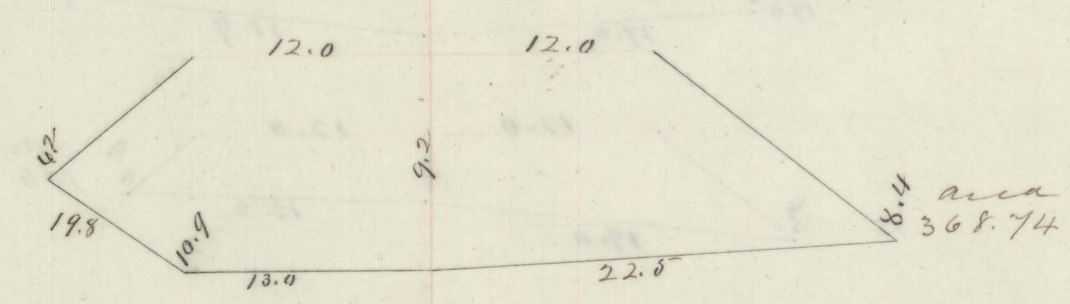

470.36

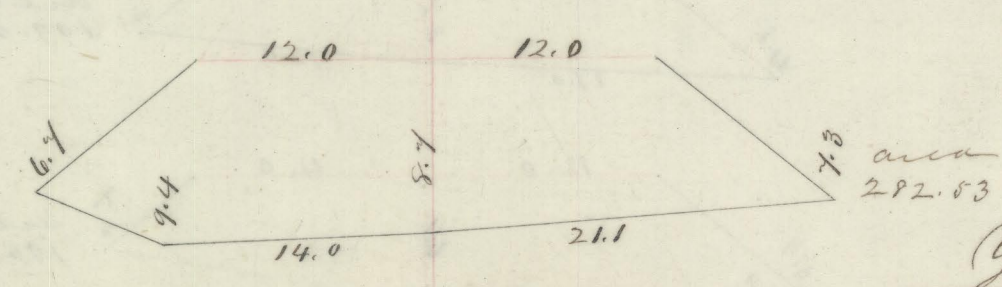

Total Amh

6.987.45 5.848.42