

Stations
No. dist
124 61ft

Section No 12

27 cubic Yards

Amb Prot view

Exc	Emb
6987.45	5848.42

+30 30"

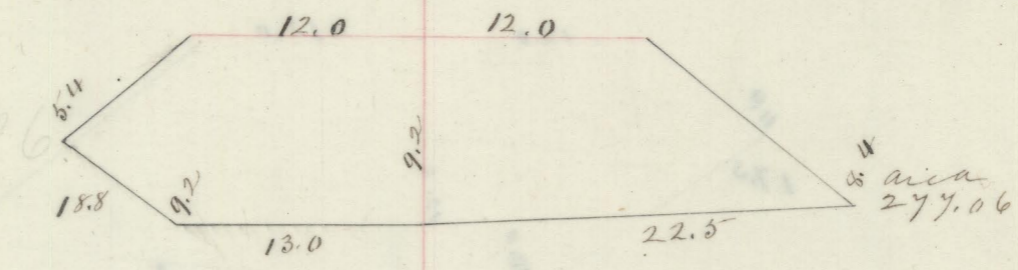

321.99

+60 30"

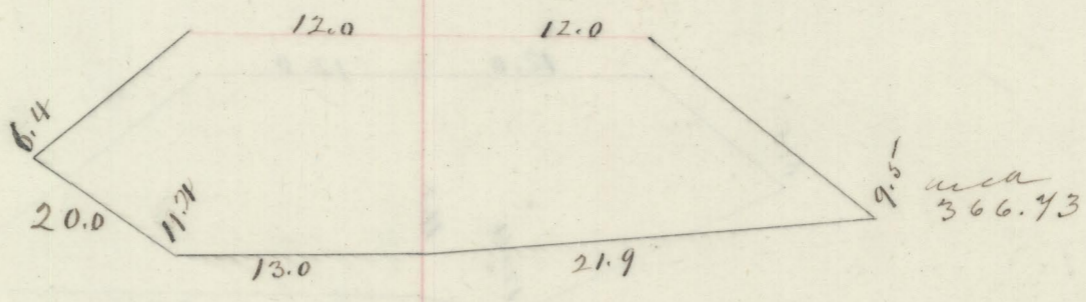

368.77

127 40"

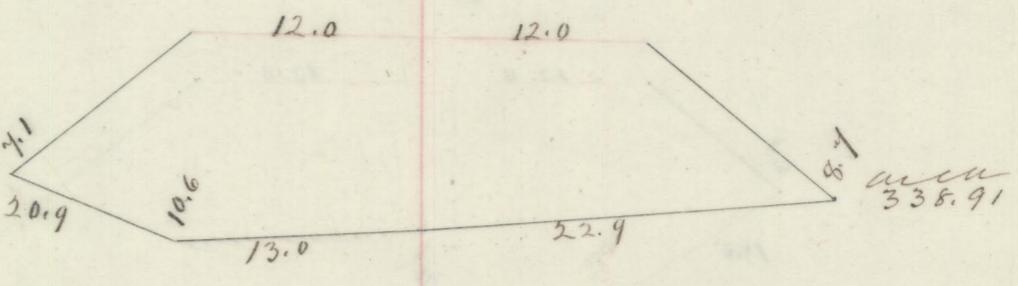

392.02

+50 50"

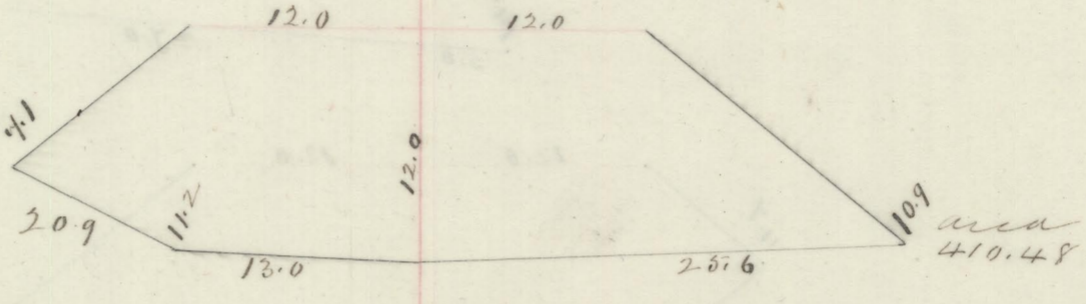

555.10

128 50"

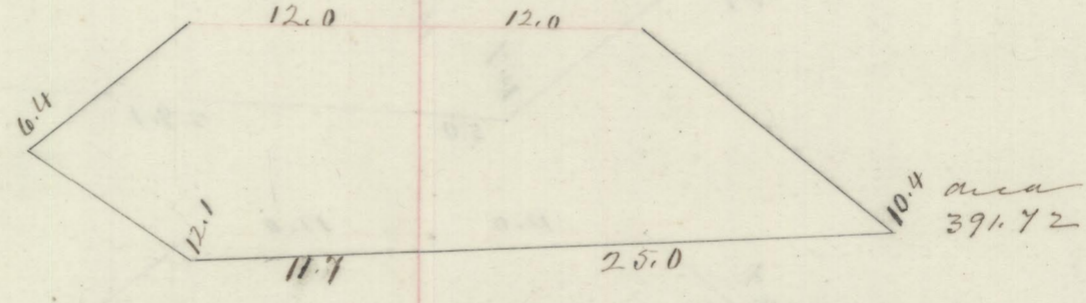

742.78

+50 50"

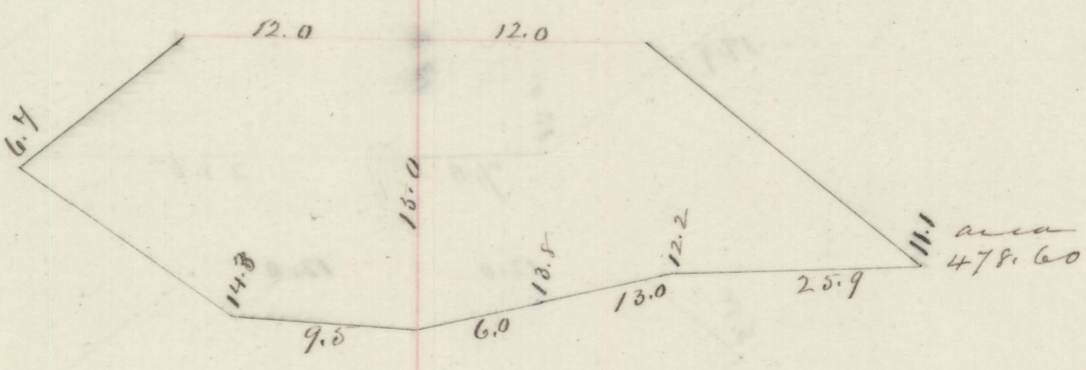

805.85

129 50"

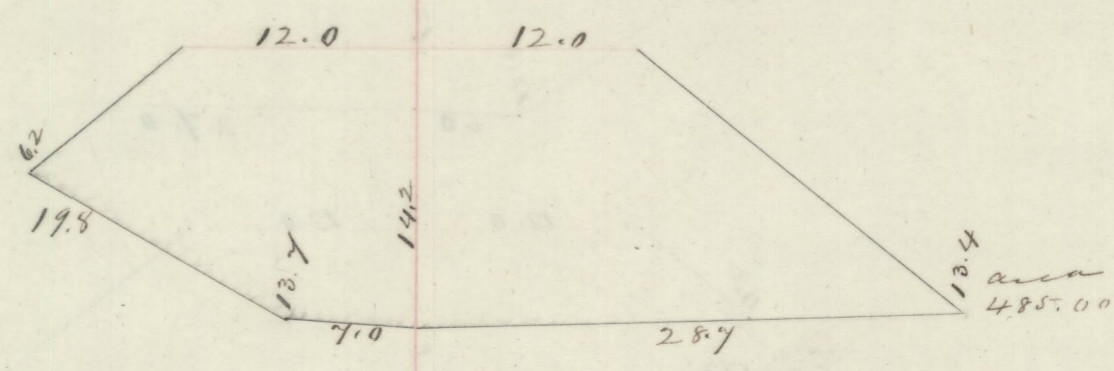

892.22

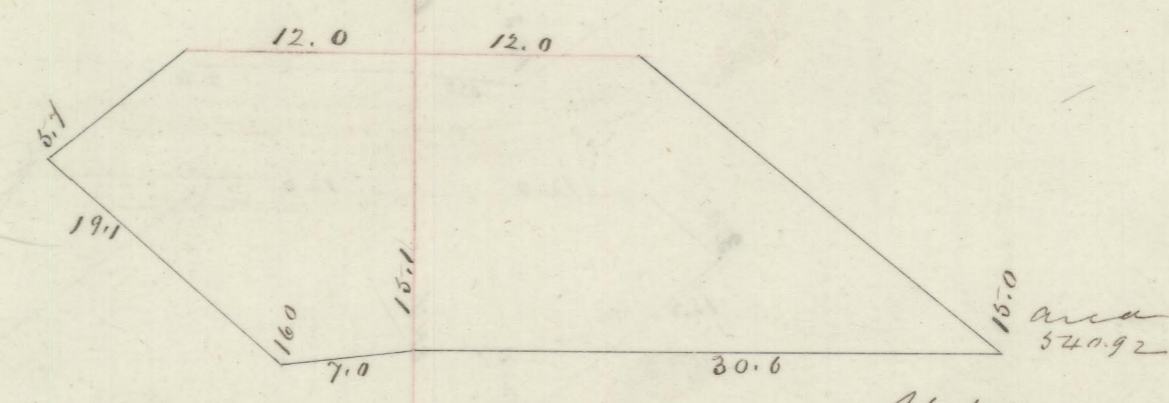

949.92

Total Amb.

6987.45	10875.07
---------	----------