

Stations  
No Dist

Section 10 13

35 Cubic Yards  
Exc Emb

+50 50ft

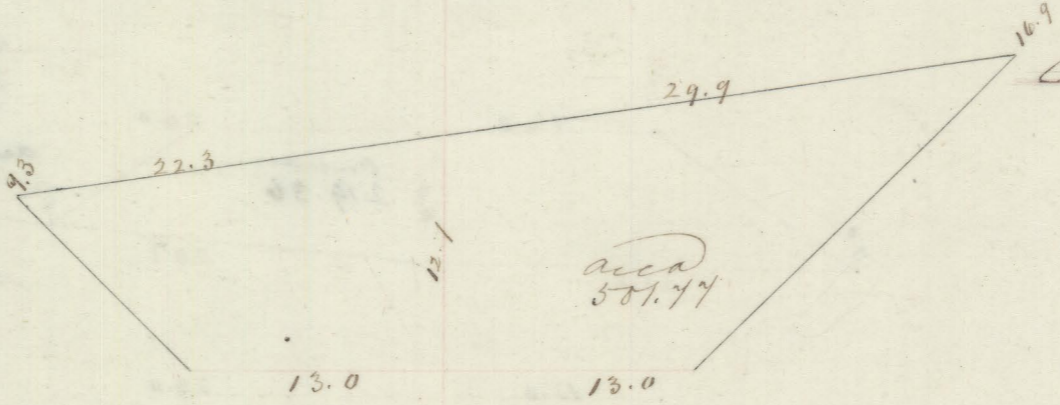

Amb Dist over 7.842.18  
991.69

155 50"

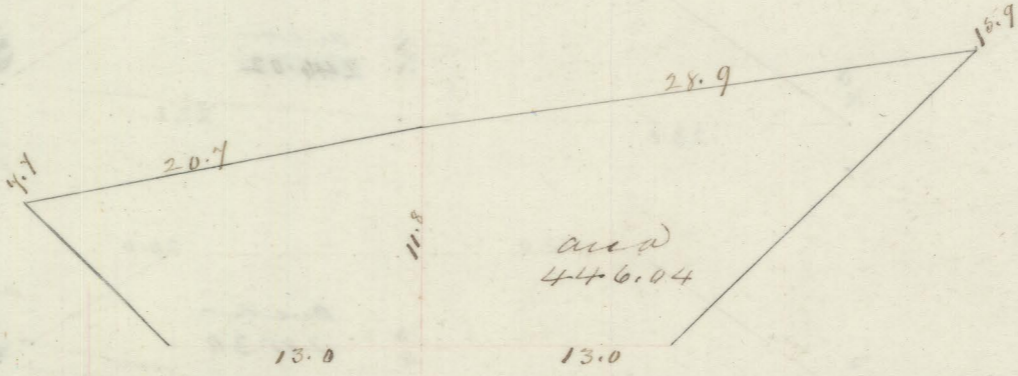

877.60

+50 50"

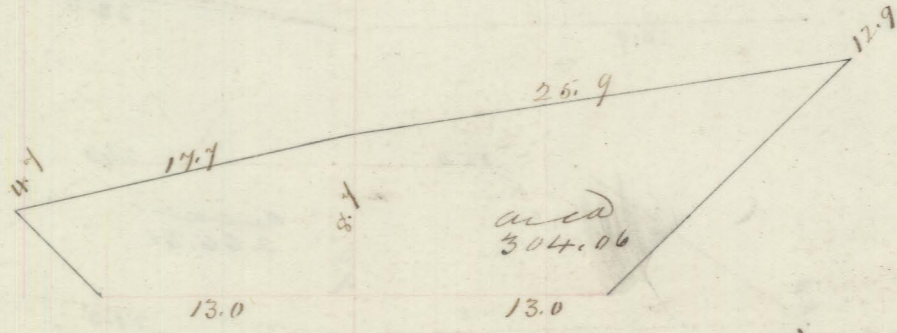

694.54

156 50"

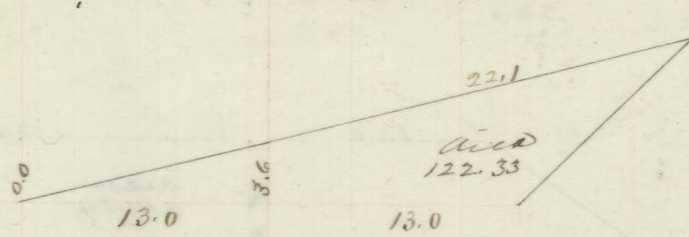

394.80

+25 25"



69.24

+46 31"



40.79

+50 4"

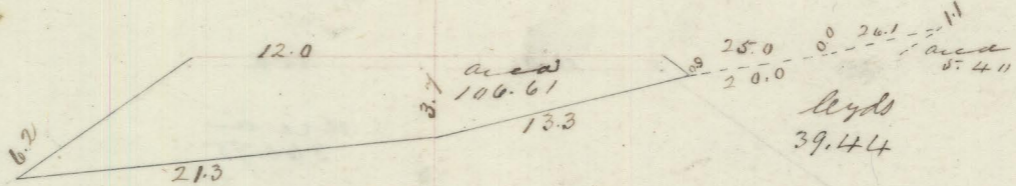

74.29

157 50"

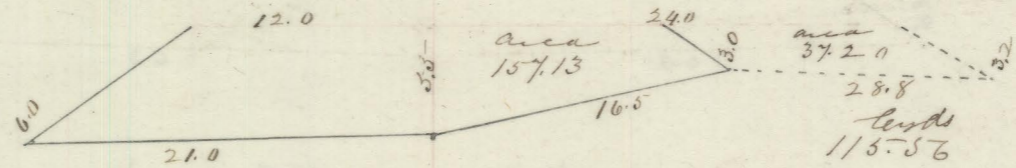

244.20

158 100

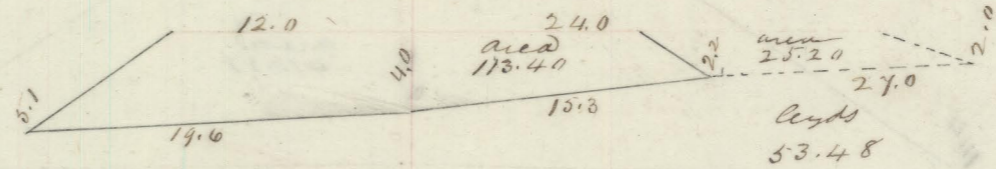

500.98

+50 50

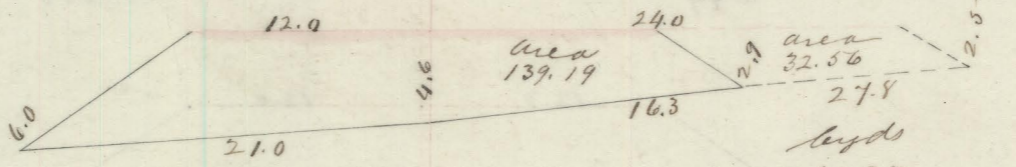

233.88

159 50"

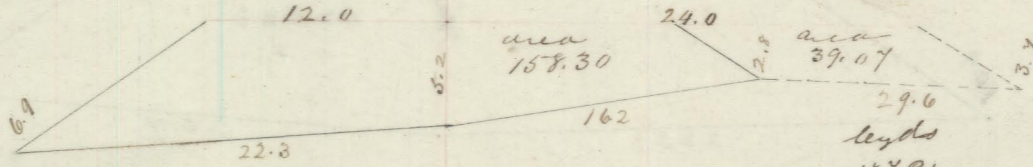

275.45

160 100"

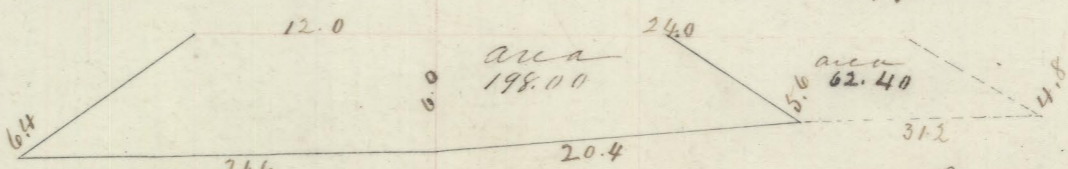

659.81

Total Amb

10870.08 2.029.40