

Stations
No Dist

Section 1013

37
Cubic Yards
Exc Emb

+50 50ft

Ant Prob over 10.870.08 7739.89
722.38

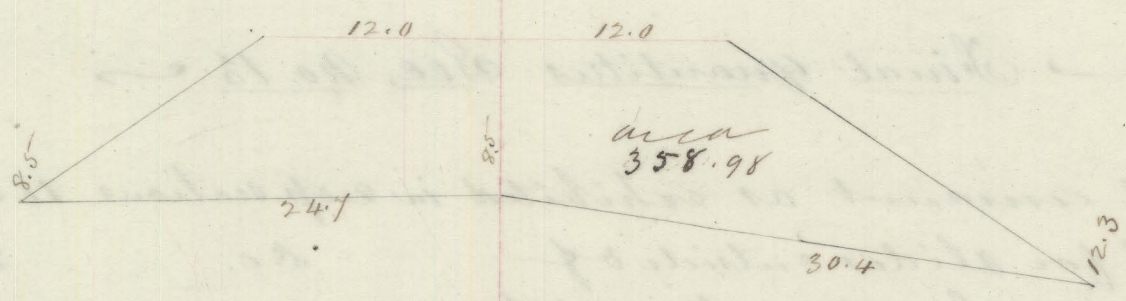

166 50ft

558.96

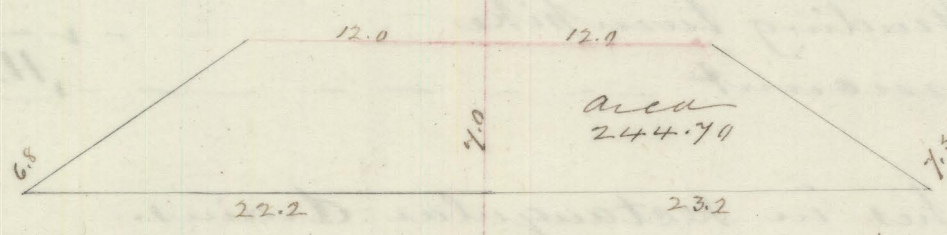

167 100"

731.94

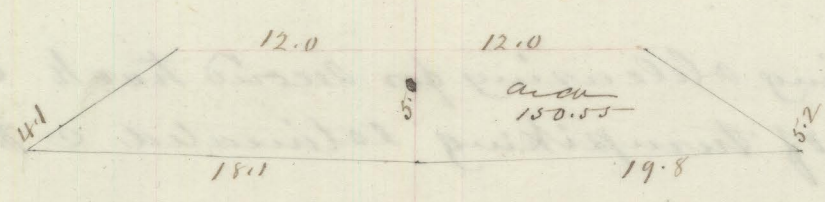

168 100"

438.52

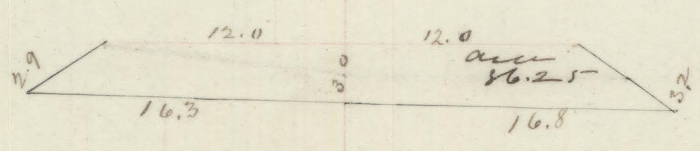

169 100"

213.09

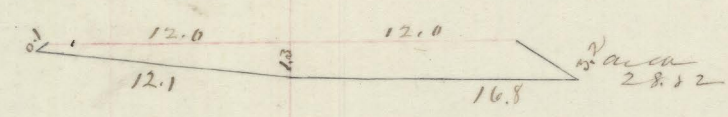

170 100"

84.65

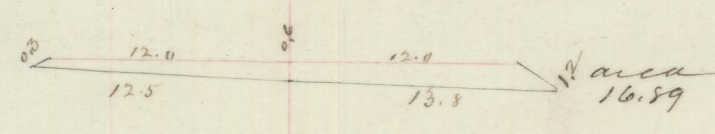

+50 50"

24.11



+75 25"

4.34



171 25"

6.31



172 100"

257.87



173 100"

73.89

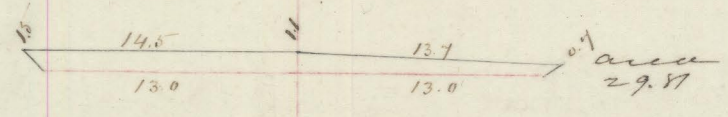

174 100"

64.83

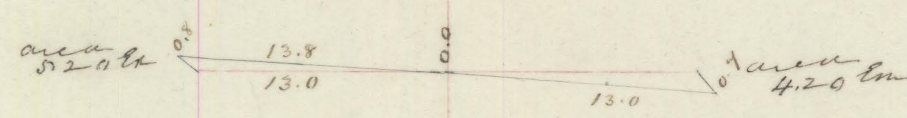

175 100"

20.34

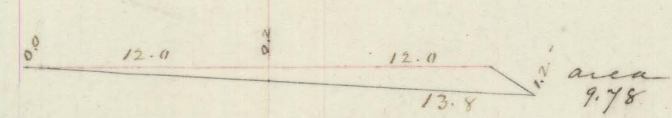

176 100"

56.31

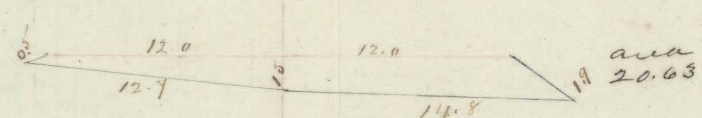

Grand Amb 11.040.98 10534.53