

Stations
No Dist

Section No 14

41 Cubic Yards

Amb Prot-ccc

Exc	Emb
2277.01	3678.75

+41 16ft

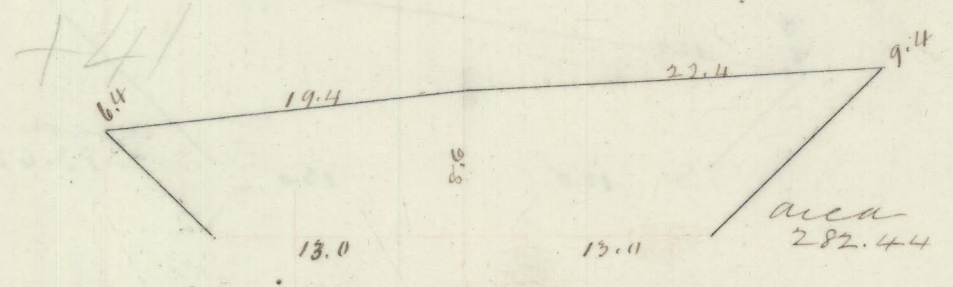

165.21

+52 11"

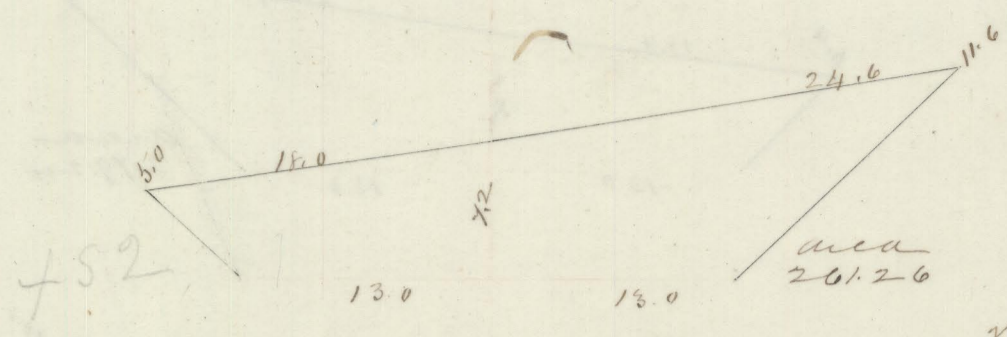

110.75

+62 10"

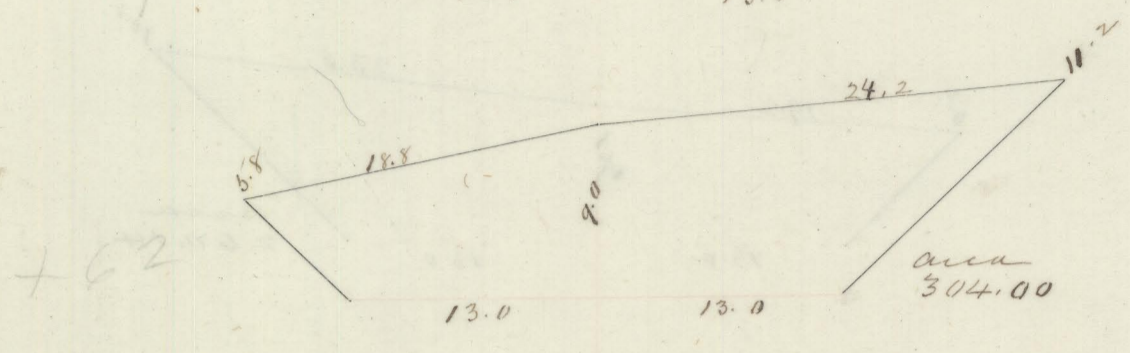

104.68

193 38"

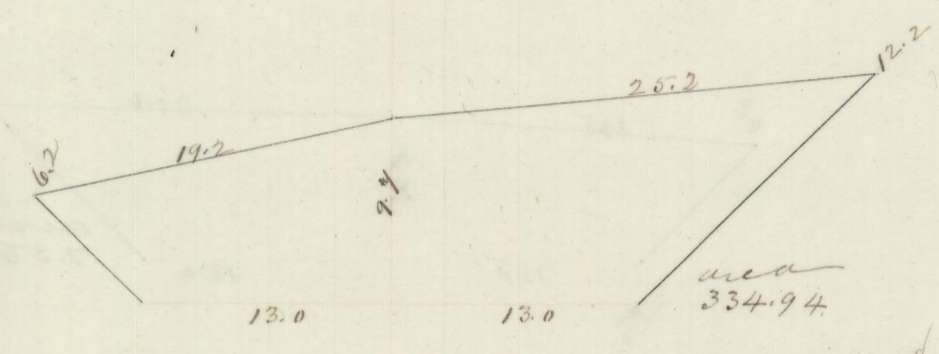

1449.62

+50 50"

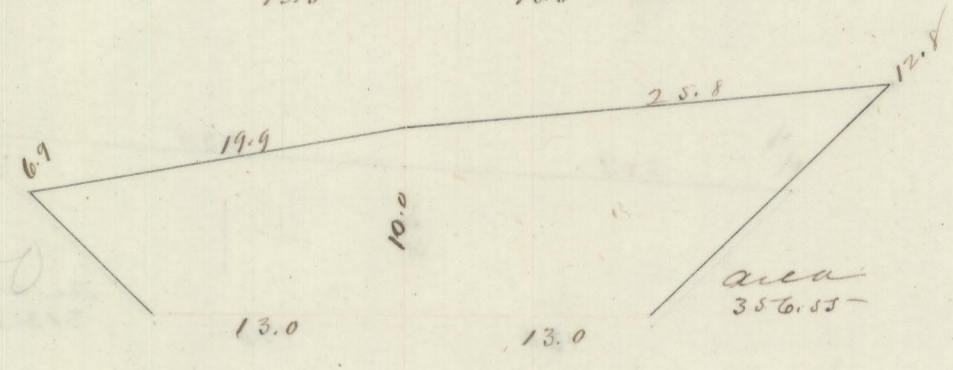

640.27

194 50"

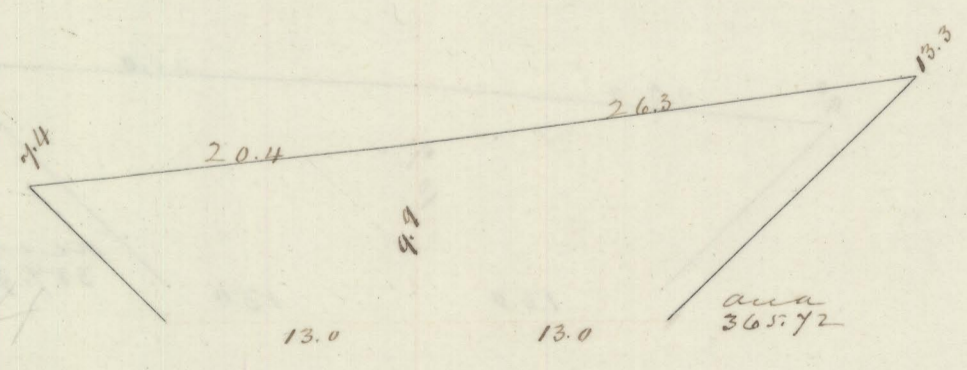

668.77

195 100"

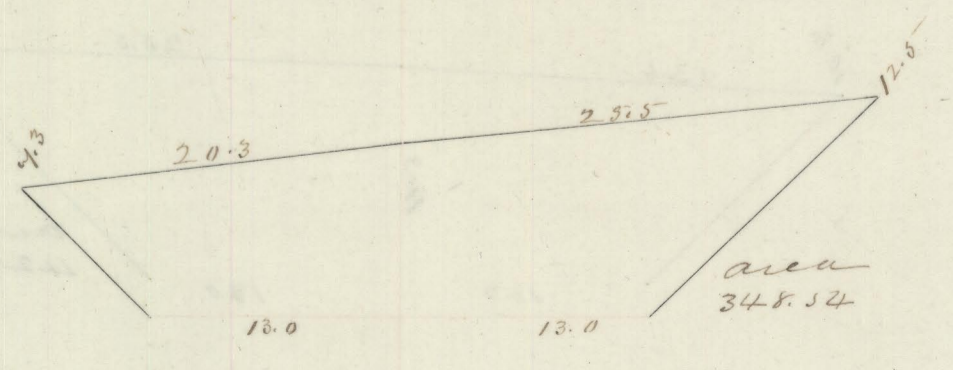

1322.70

196 100

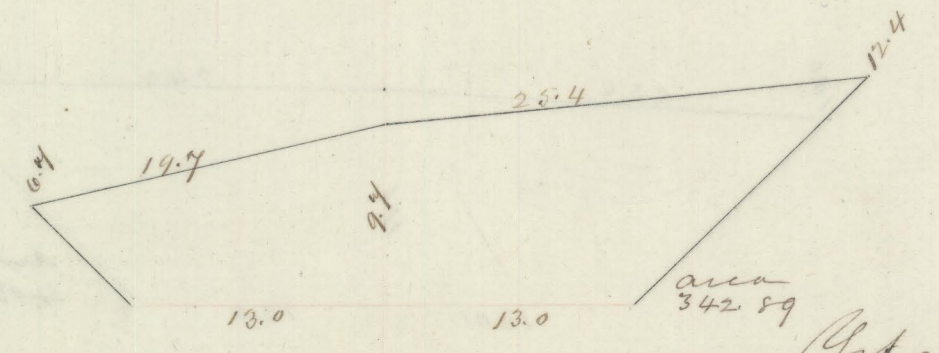

1280.42

Total Amb

4019.43	3678.75
---------	---------