

Stations \downarrow
to Dist

Section No 14

Cubic Yards
Cese Comb

197 100ft

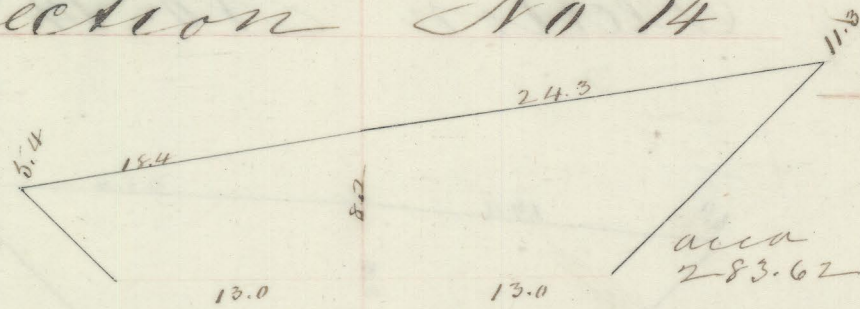

Ambs Port over

7019.43 3678.75
1160.20

+50 50"

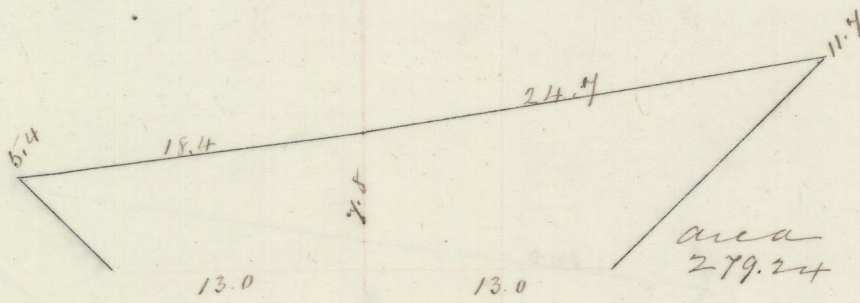

521.17

198 50"

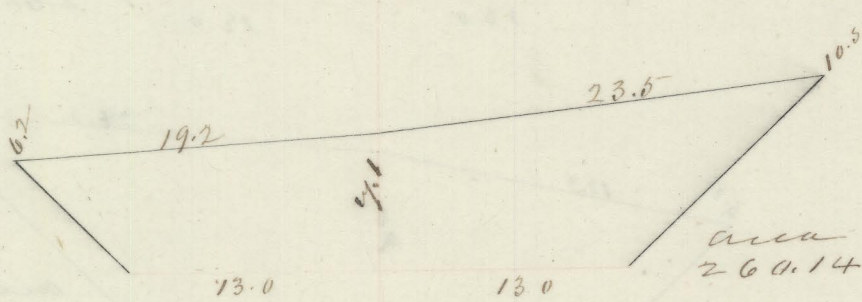

478.27

+50 50"



527.99

199 50"

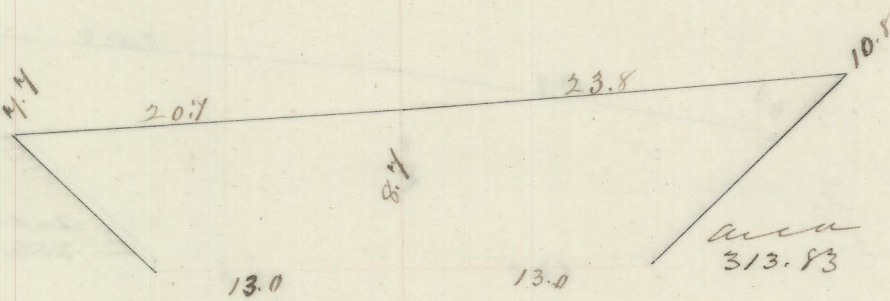

649.80

+50 50"

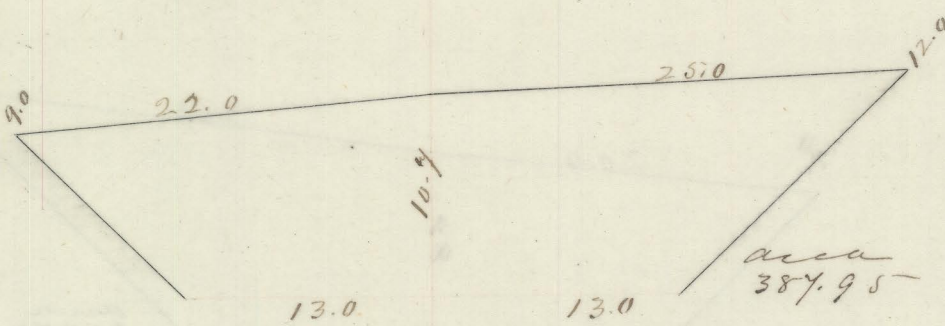

755.11

200 50"

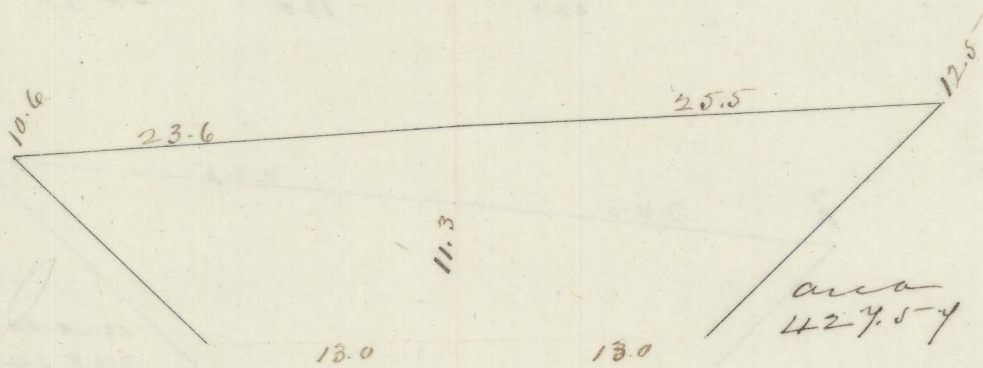

1549.94

201 50"

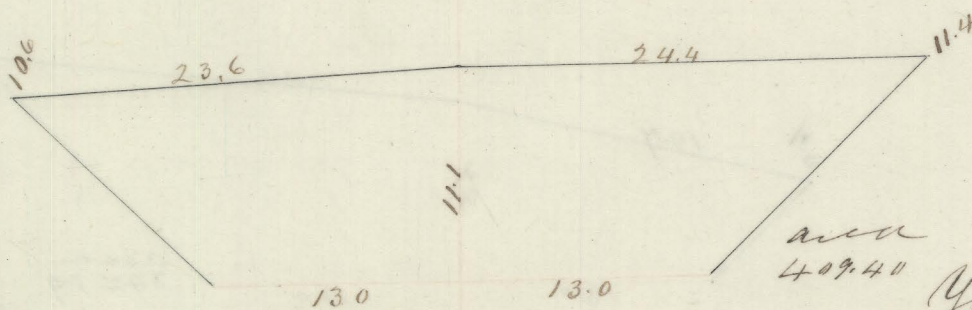

Total Amts

13161.34 3678.75