

Stations 52
No fish

Section No 10

Cubic Yards
Exc Emb

239 100ft

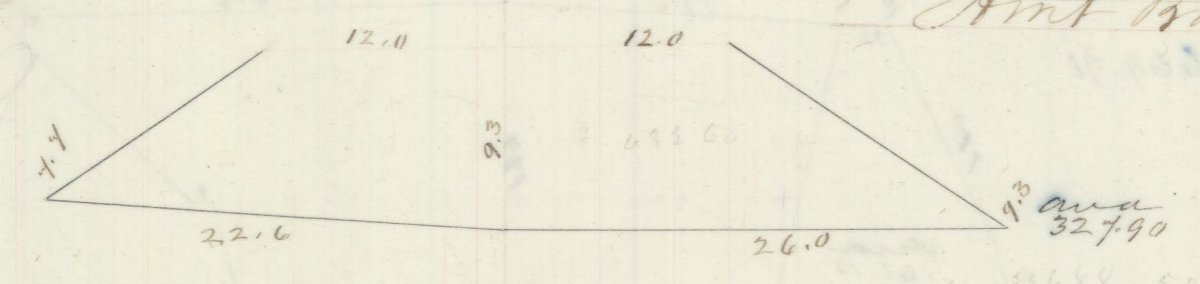

Ant Pit wa

9808.49 5138
705.70

240 100"

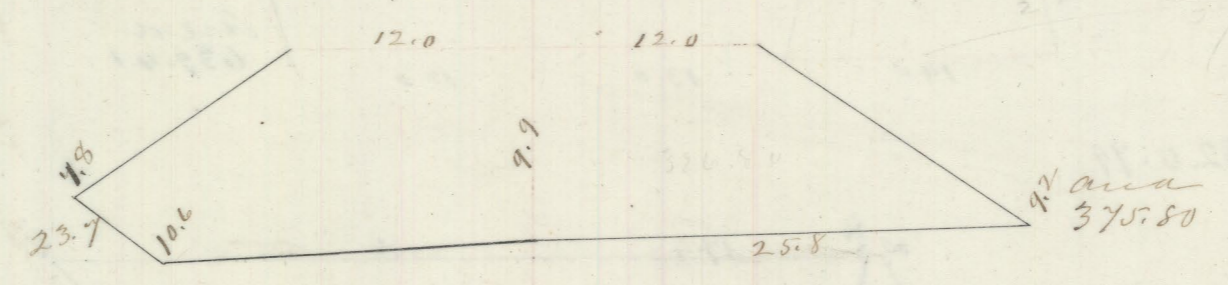

1303.31

241 100"

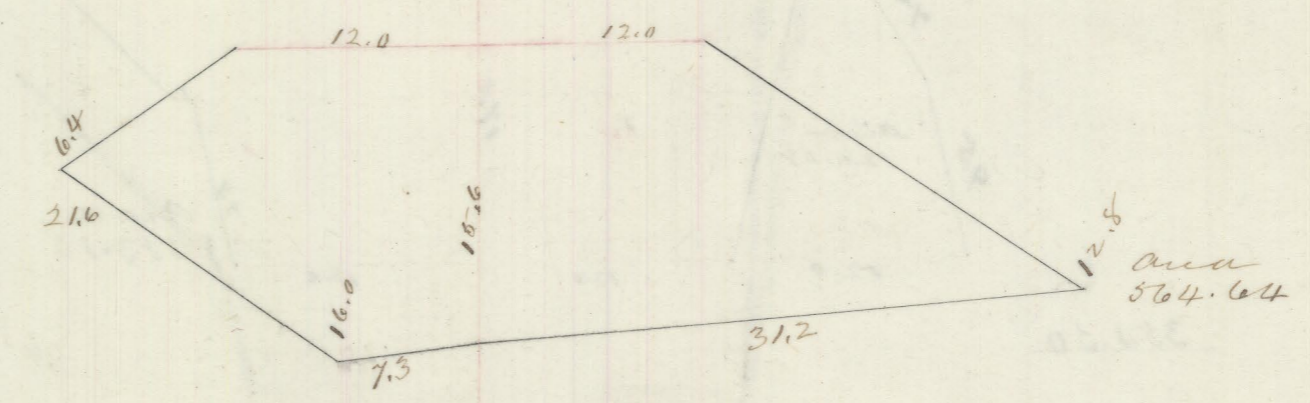

1741.56

+50 50"

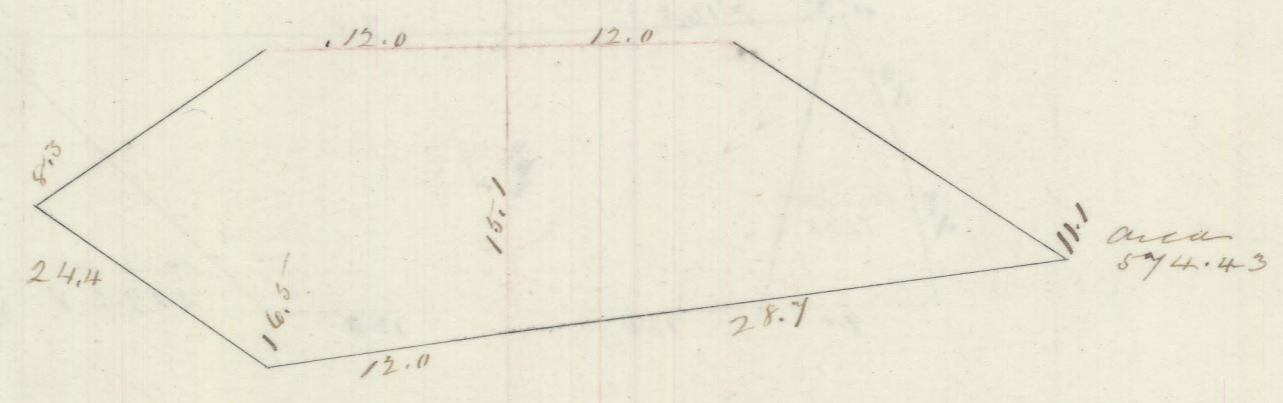

1054.69

242 50"

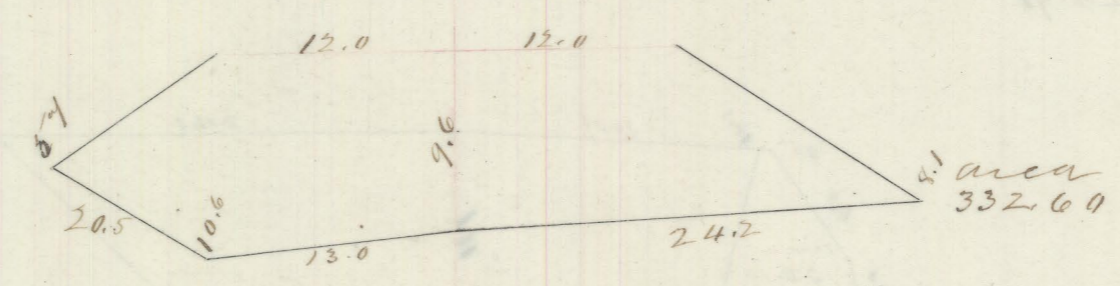

839.84

243 100"

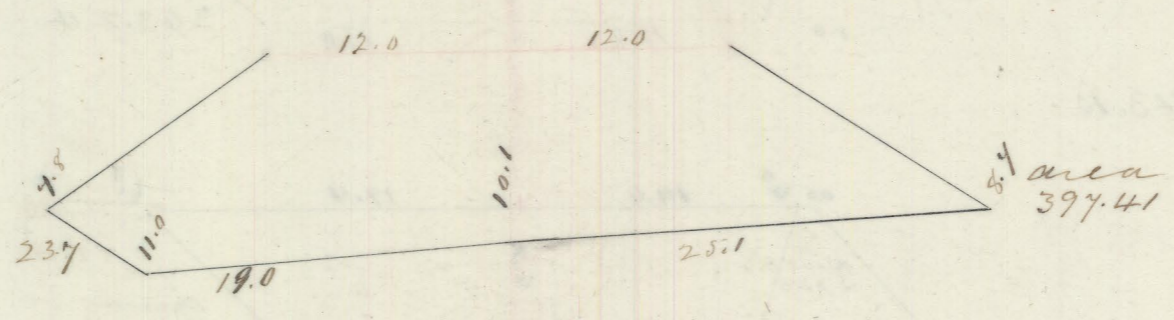

1357.87

244 100"

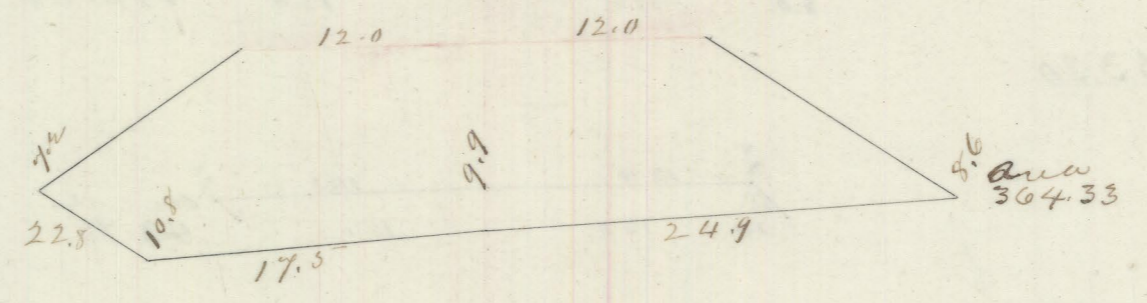

1239.37

245 100"

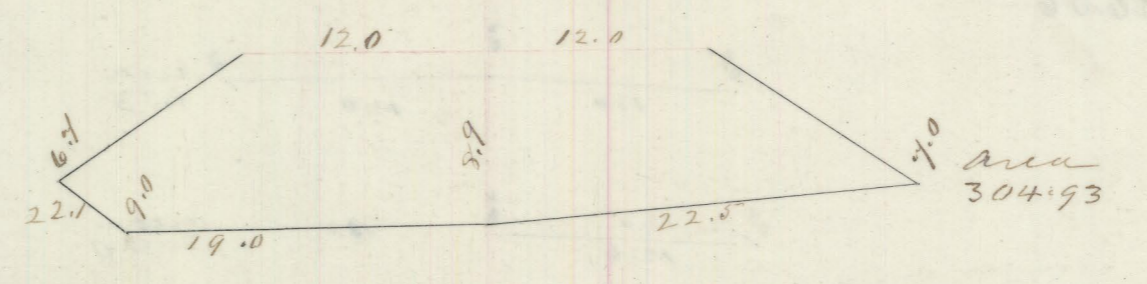

929.13

246 100"

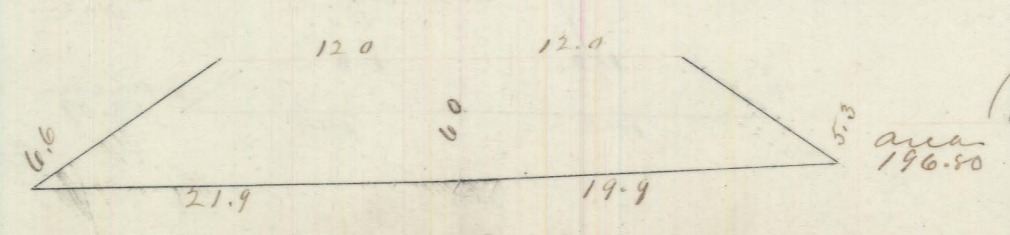

Total Amb

9808.49 10627.48