

Section No. 20.

Stations	Areas	Ex. Em.	
No. Dist.	Ex. Em.		
+47 7	"	10.2	
+62 10	29.5	"	
" 331 38	125.7	"	
+25 25	128.0	"	
+50 25	116.7	"	
" 322 50	93.9	"	
+20 20	79.8	"	
+12 22	68.7	"	
+50 8	"	54.1	
+75 25	"	11.1	
" 323 25	81.2	"	
+50 50	74.3	"	
" 324 50	179.2	"	

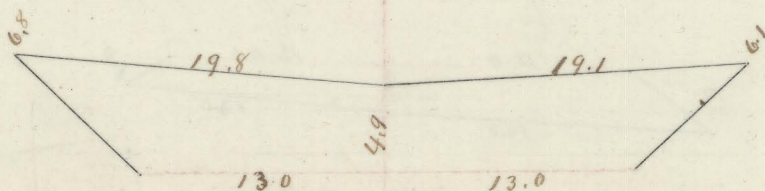
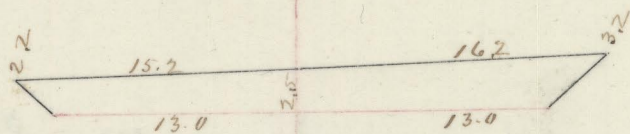
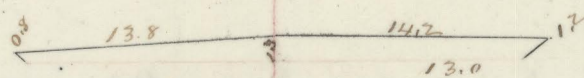
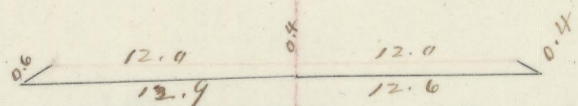
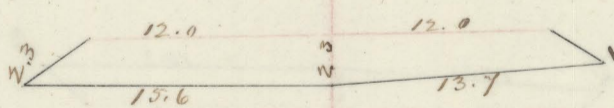
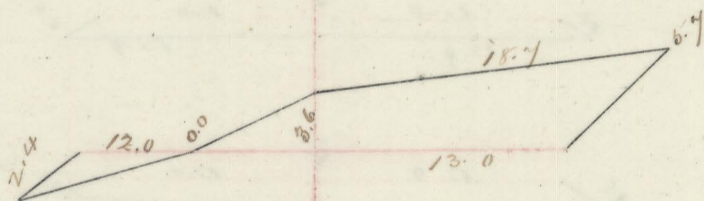
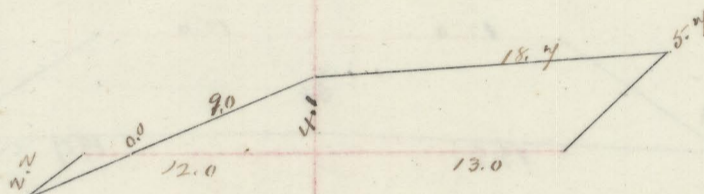
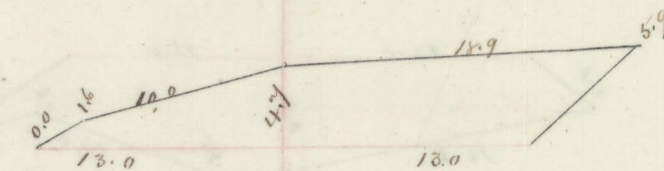
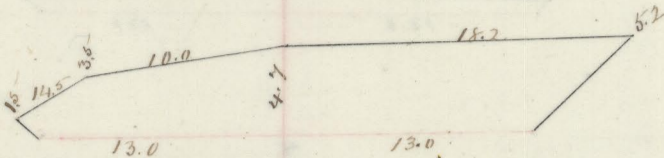
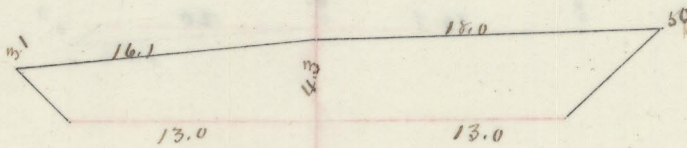

Cubic Yards	Ex. Em.
5.5	0.9
109.2	"
117.4	"
116.2	"
195.0	"
64.3	"
60.5	"
6.8	"
"	"
9.3	"
97.7	"
Total 1 st Pit = 1515.7	
234.7	"
264.2	"