

Course & Distance around the whole Tract
Beginning at a pt. on the line of John Eberleys
Land.

Stations	Course	Distance
1.	S. 19. E.	45.7 pt.
2.	N. 71. E.	11.7 pt.
3.	N. 24 1/4 W.	46 pt.
4.	N. 74. E.	8.5 B.K.
5.	S. 24 1/4 E.	66.1 pt.
6.	S. 71. W.	26 pt.
7.	N. 19. W.	20.5 pt.
8.	S. 71. W.	4 pt.
9.	S. 19. E.	20.5 pt.
10.	S. 71. W.	3 pt.
11.	N. 19. W.	20.5 pt.
12.	S. 71. W.	8 pt.
13.	S. 19. E.	20.5 pt.
14.	S. 71. W.	4 pt.
15.	N. 19. W.	20.5 pt.
16.	S. 71. W.	17 pt.
17.	N. 19. W.	20.5 pt.
18.	S. 71. W.	9 pt.
19.	S. 19. E.	20.5 pt.
20.	S. 71. W.	12.5 pt.
21.	N. 19. W.	20.5 pt.
22.	S. 71. W.	5.5 pt.
23.	N. 24. W.	29 pt.
24.	N. 74. E.	69.7 pt. Cont ^d 23acs. 65ps. & allow ^d .

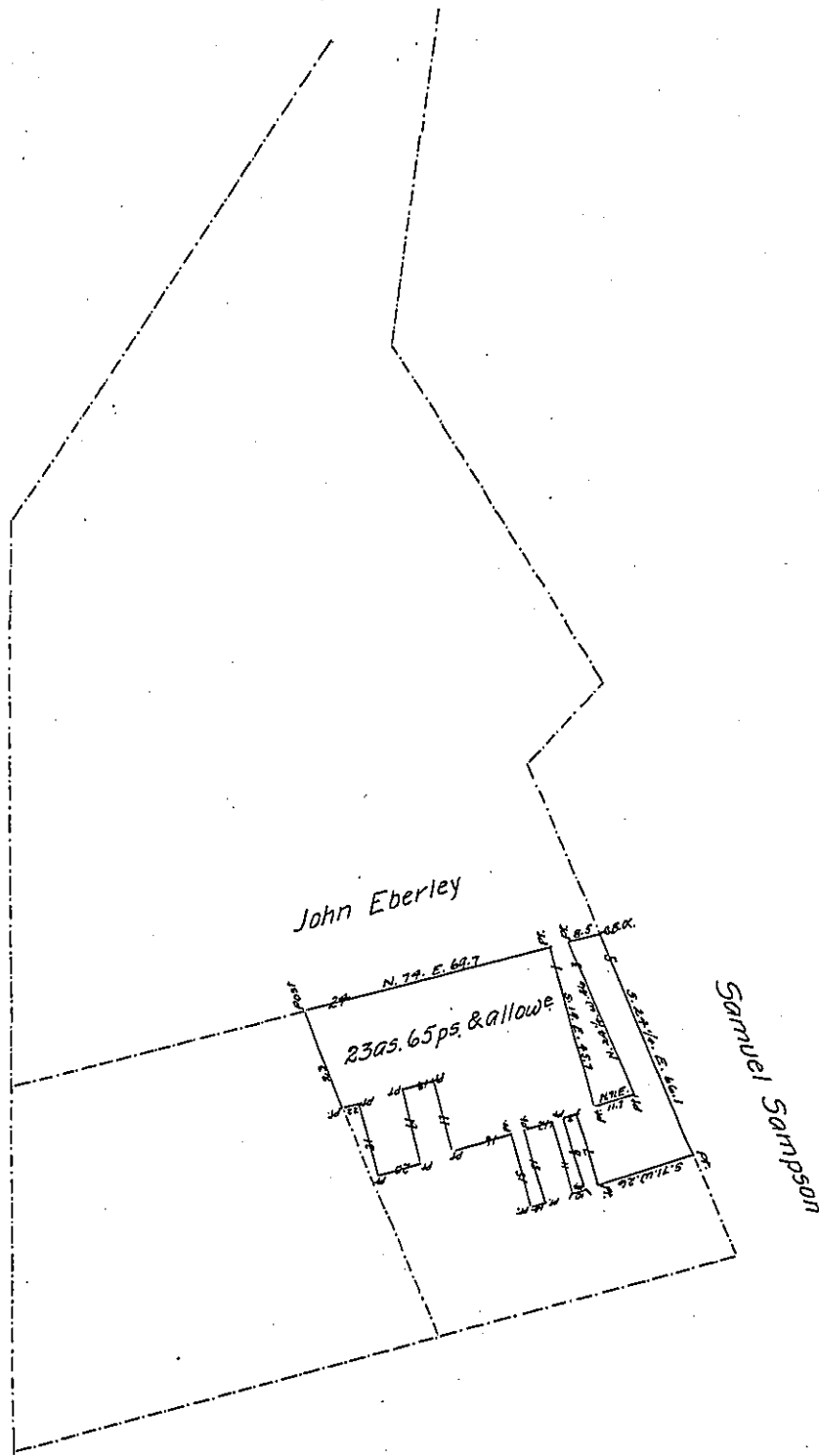

Draught of a Tract of Land situate in East pennsboro Township Cumberland County Containing Twenty three Acres & sixty five
perches & Allowance of six pr. ct. for roads &c. It being part of 267acs 114ps & Allowance which was Survd In pursuance of
Application datd. the 8th Day of October Anno Domini 1766 No. 1442 Granted to Joseph Haynes, Survey^r & Divided March the
9th Anno Domini 1824.

Saml Ruby D.S.

To Samuel Cochran Esquire
Surveyor General

IN TESTIMONY that the above is a copy of the original remaining on file in the Department of
Internal Affairs of Pennsylvania, made conformably to an Act of Assembly
approved the 16th day of February, 1833, I have hereunto set my Hand
and caused the Seal of said Department to be affixed at Harrisburg, this
third day of November 1905.

George S. [Signature]
Secretary of Internal Affairs.