

John McClelland

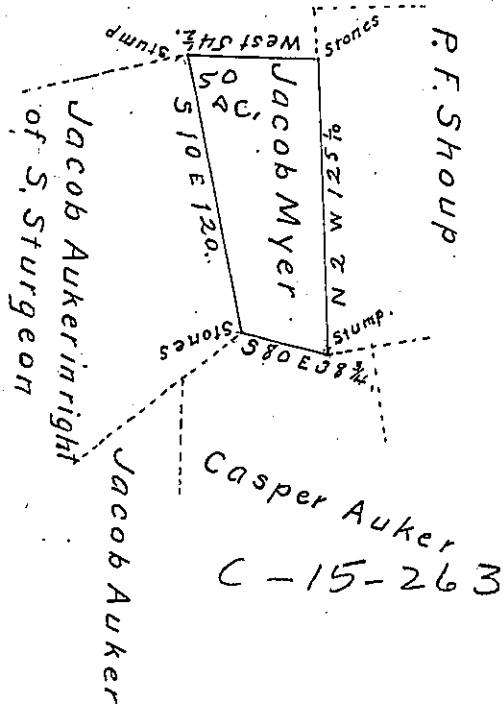

A Draught of thirty two acres and one hundred and forty nine perches of land with six per Cent for roads, situate in Greenwood township in Mifflin county which appears by Official papers remaining in the Deputy Surveyors Office in Mifflin town in and for said county, to have been surveyed 3<sup>d</sup> & 4<sup>th</sup> December 1792 in pursuance of a Warrant to Jacob Myer for 50<sup>a</sup> dated 17<sup>th</sup> April 1775 - Examined 28<sup>th</sup> January 1811.

And, an Order of the Board, dated 5<sup>th</sup> Novem<sup>r</sup> 1792.

Michael M Monahan D<sup>o</sup> S

To Andrew Porter Esquire }  
 Surveyor General of Pennsylvania }

IN TESTIMONY that the above is a copy of the original remaining on file in the Department of Internal Affairs of Pennsylvania, made conformably to an Act of Assembly approved the 16th day of February, 1833, I have hereunto set my Hand and caused the Seal of said Department to be affixed at Harrisburg, this first day of September 1903.

Isaac B Brown  
 Secretary of Internal Affairs.