

Courses & Distances
from post. to Biko.

- N. 54. W. 25.
- N. 65. W. 19½.
- N. 77. W. 37½.
- S. 83. W. 12.
- N. 3. E. 9¾.
- S. 86. W. 12½.
- N. 40. W. 13.
- N. 67. E. 9

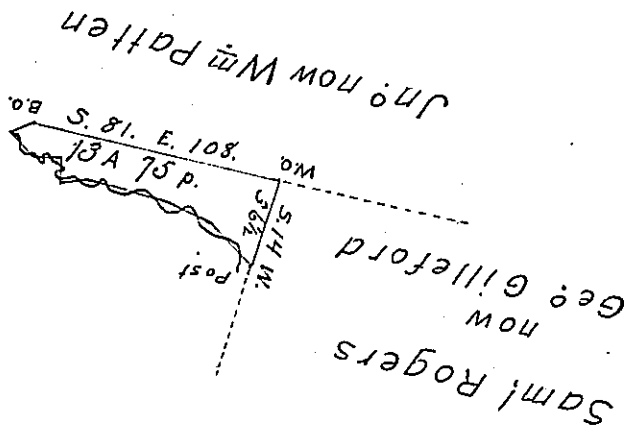

Thirteen acres and Seventy five perches of Land with Six Per Cent for Roads, Situate in Millford township Mifflin County, part of a tract said to contain 419¼ acres, Surveyed in pursuance of two ^{warrants} to Wm Graham dated Sept^r 20th 1762 and one to Geo Armstrong dated 3^d Feby 1755. The above part appears now the property of Geo Gilleford & Jean Kerr, and was Surveyed 10th Jan^y 1818 by Tho. Mathers D.S. as appears from the official Draught remaining in my Office, examined — April 1818, and found correct.

Jacob H. Stewart D.S.

To Jacob Spangler Esqr
S. G. of Pennsylvania

IN TESTIMONY that the above is a copy of the original remaining on file in the Department of Internal Affairs of Pennsylvania, made conformably to an Act of Assembly approved the 16th day of February, 1833, I have hereunto set my Hand and caused the Seal of said Department to be affixed at Harrisburg, this fourteenth day of September 1903.

Isaac R. Bacon
Secretary of Internal Affairs.