

1 Courses Distances down French Creek beginning at an Ash.c

- S 47 1/2° E 80
- S 40° E 22
- S 56 1/2° E 34.6
- S 9° W 9
- S 88 1/2° W 63.9
- S 69° W 66.5
- S 10° E 25.5
- S 63 1/2° E 15.8

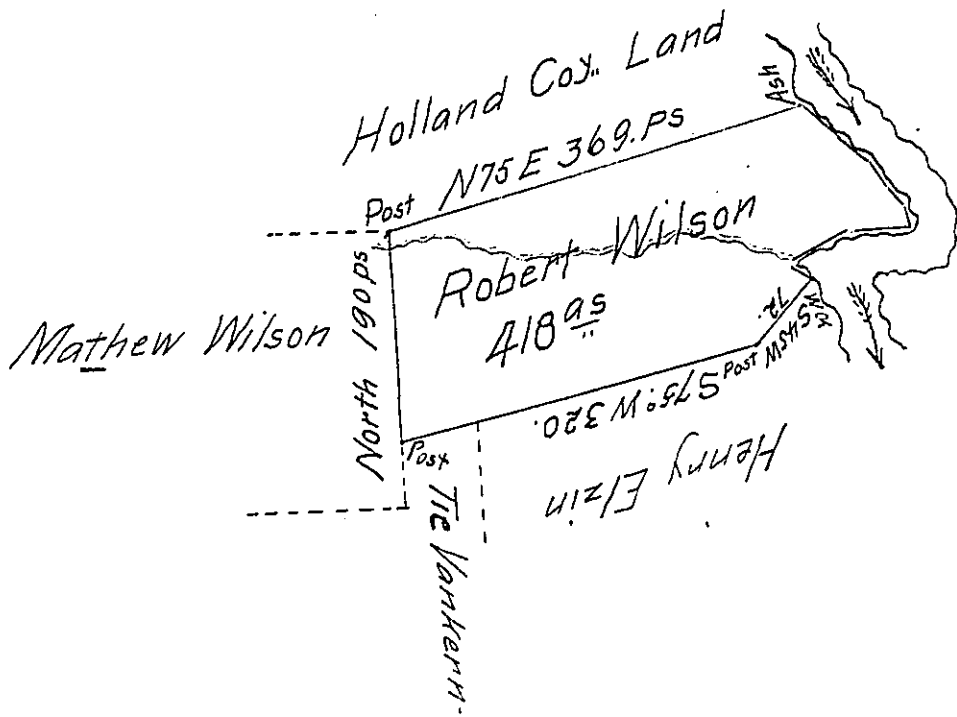

In pursuance of a Warrant for 400^{as} of land dated the 5th day of April 1805. was surveyed October the 22nd 1805. for Robert Wilson the above described Tract of land Containing 418 Acres and allowance of Six per Cent for Roads &c Situate in Fairfield Township in the County of Crawford

William McArthur D.Sr

Samuel Cochran Esquire
Surveyor General

IN TESTIMONY that the above is a copy of the original remaining on file in the Department of Internal Affairs of Pennsylvania, made conformably to an Act of Assembly approved the 16th day of February, 1833, I have hereunto set my Hand and caused the Seal of said Department to be affixed at Harrisburg, this 17th day of October 1907

Henry Howard

Secretary of Internal Affairs.