

144 Tracts. Rev. 1-25-37. Revised to Sep. 17, 1948. WKJ

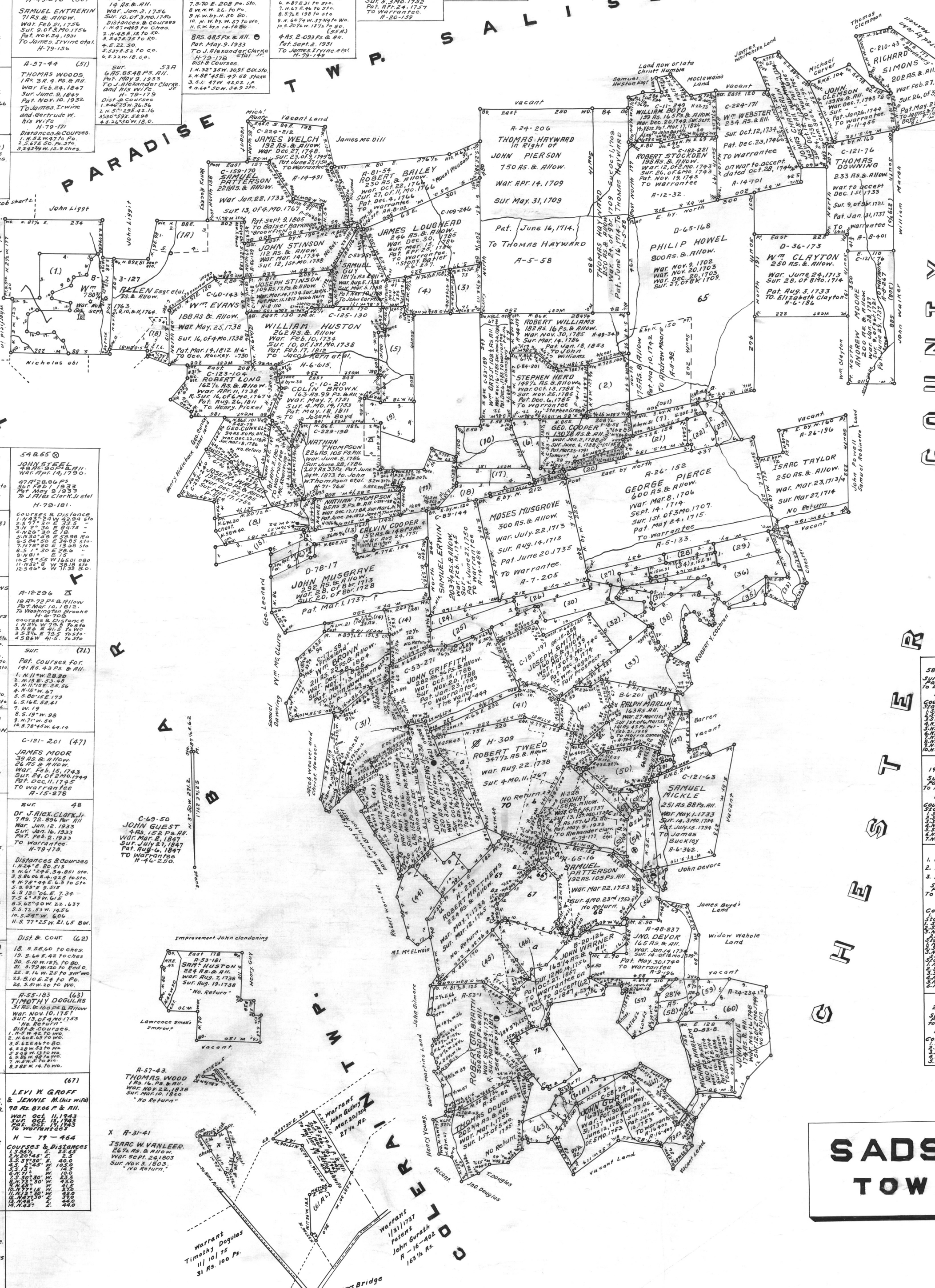

SADSBURY TOWNSHIP

WARREN J. DANIEL
Director of Land Bureau.

A CONNECTED DRAFT OF Tracts of Land situated in Sadsbury Township Lancaster County. The Applications, Warrants, Surveys and Patents bearing date respect fully as above set forth, constructed from and compared with the original drafts remaining on file in the Department of Internal Affairs of Pennsylvania, under the direction of Warren J. Daniel, Director of Land Office Bureau.

IN TESTIMONY WHEREOF, I have hereunto set my hand and caused the seal of the said department to be affixed at Harrisburg, this Twentieth Day of August, AD 1938.

Thomas L. Logue
Secretary of Internal Affairs.

144 Tracts. Rev. 1-25-37. Revised to Sep. 17, 1948. WKJ

144 Tracts. Rev. 1-25-37. Revised to Sep. 17, 1948. WKJ