

WESTMORELAND COUNTY

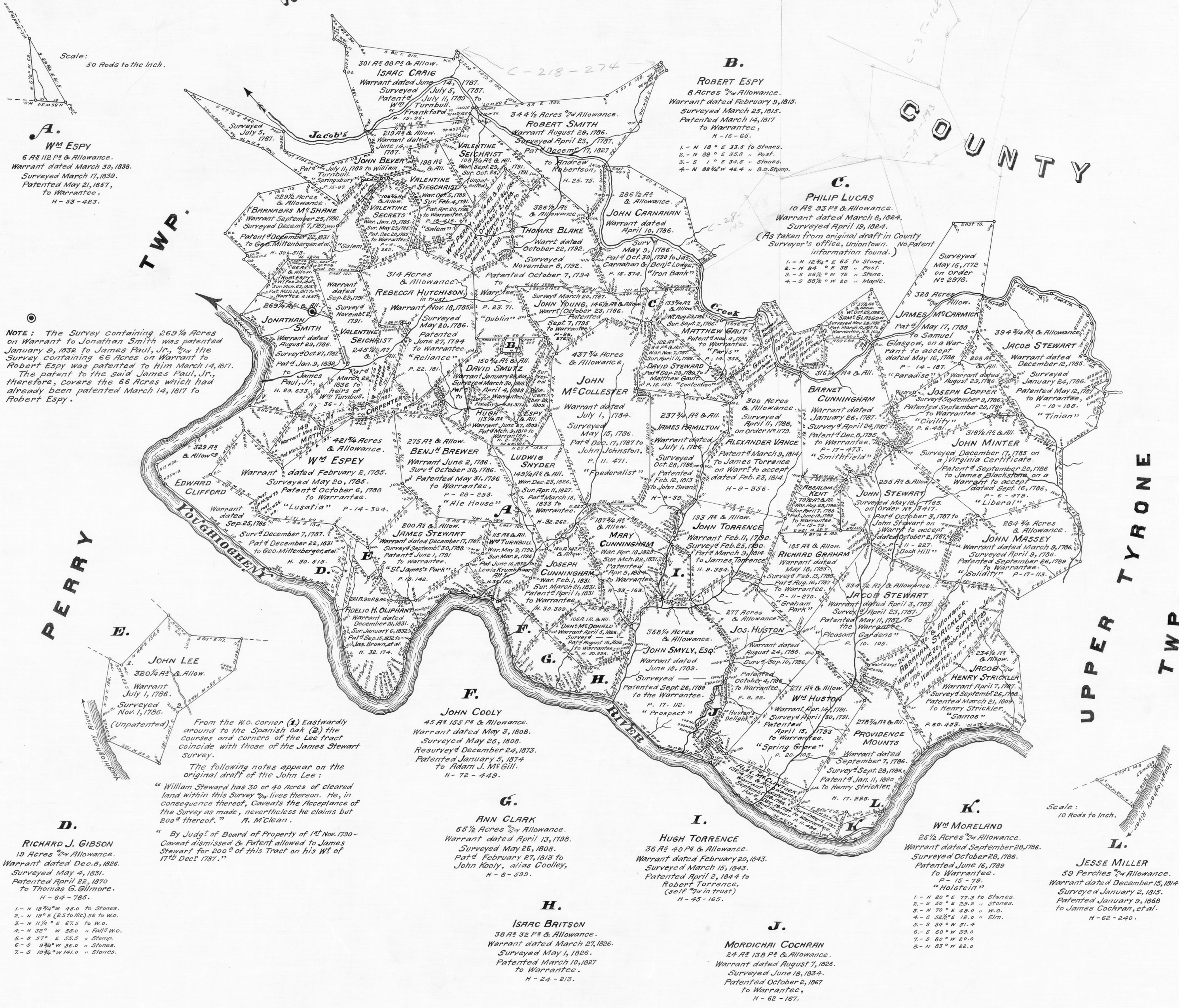

A.
WM ESPY
 6 AS 112 PS & Allowance.
 Warrant dated March 30, 1838.
 Surveyed March 17, 1839.
 Patented May 21, 1857,
 To Warrantee,
 H - 53 - 423.

NOTE: The Survey containing 269 1/4 Acres on Warrant to Jonathan Smith was patented January 9, 1832 to James Paul, Jr. The Survey containing 66 Acres on Warrant to Robert Espy was patented to him March 14, 1817. The patent to the said James Paul, Jr., therefore, covers the 66 Acres which had already been patented March 14, 1817 to Robert Espy.

D.
RICHARD J. GIBSON
 19 Acres 3/4 Allowance.
 Warrant dated Dec. 6, 1826.
 Surveyed May 4, 1831.
 Patented April 22, 1870
 to Thomas G. Gilmore.
 H - 64 - 785.

D.
RICHARD J. GIBSON
 19 Acres 3/4 Allowance.
 Warrant dated Dec. 6, 1826.
 Surveyed May 4, 1831.
 Patented April 22, 1870
 to Thomas G. Gilmore.
 H - 64 - 785.

From the W.O. corner (1) Eastwardly around to the Spanish oak (2) the courses and corners of the Lee tract coincide with those of the James Stewart Survey.
 The following notes appear on the original draft of the John Lee:
 "William Steward has 30 or 40 Acres of cleared land within this Survey 1/2 lives thereon. He, in consequence thereof, Caveats the Acceptance of the Survey as made, nevertheless he claims but 200⁰ thereof." A. McClean.
 "By Judge of Board of Property of 1st Nov. 1790 - Caveat dismissed & Patent allowed to James Stewart for 200⁰ of this Tract on his W¹ of 17th Dec^r 1787."

F.
JOHN COOLY
 45 AS 155 PS & Allowance.
 Warrant dated May 3, 1808.
 Surveyed May 26, 1808.
 Resurveyed December 24, 1813.
 Patented January 5, 1874
 to Adam J. Mc Gill.
 H - 72 - 449.

G.
ANN CLARK
 66 1/2 Acres 3/4 Allowance.
 Warrant dated April 13, 1798.
 Surveyed May 26, 1808.
 Pat^d February 27, 1813 to
 John Kooly, alias Cooley,
 H - 8 - 599.

H.
ISAAC BRITSON
 38 AS 32 PS & Allowance.
 Warrant dated March 27, 1826.
 Surveyed May 1, 1826.
 Patented March 10, 1827
 To Warrantee.
 H - 24 - 213.

I.
HUGH TORRENCE
 36 AS 40 PS & Allowance.
 Warrant dated February 20, 1843.
 Surveyed March 15, 1843.
 Patented April 2, 1844 to
 Robert Torrence,
 (Self "in trust")
 H - 45 - 165.

J.
MORDICHAJ COCHRAN
 24 AS 138 PS & Allowance.
 Warrant dated August 7, 1824.
 Surveyed June 18, 1834.
 Patented October 2, 1867
 To Warrantee,
 H - 62 - 167.

K.
WM MORELAND
 25 1/2 Acres 3/4 Allowance.
 Warrant dated September 28, 1786.
 Surveyed October 28, 1786.
 Patented June 16, 1789
 To Warrantee.
 P - 15 - 79.
 "Holstein"
 1 - N 20° E 77.3 To Stones.
 2 - S 50° E 23.2 " Stones.
 3 - N 70° E 43.0 " W.O.
 4 - S 52° E 12.0 " Elm.
 5 - S 34° W 51.4
 6 - S 60° W 35.0
 7 - S 60° W 25.0
 8 - N 85° W 22.0

L.
JESSE MILLER
 59 Perches 3/4 Allowance.
 Warrant dated December 15, 1814.
 Surveyed January 9, 1815.
 Patented January 9, 1868
 to James Cochran, et al.
 H - 62 - 240.

LOWER TYRONE TOWNSHIP

SCALE OF 100 RODS TO THE INCH.
 JOHN H. CAMPBELL,
 Chief Draftsman.

In Testimony, that the above is a connected draft of all the tracts of land situated in the township of Lower Tyrone and County of Fayette; the warrants, surveys and patents bearing date respectively as above set forth, and constructed from and compared with the original drafts remaining on file in the Department of Internal Affairs of Pennsylvania, I have hereunto set my hand and caused the Seal of said Department to be affixed, at Harrisburg, the twenty-second day of June, Anno Domini 1920.

James F. Woodward
 Secretary of Internal Affairs