

SPRINGFIELD TWP.

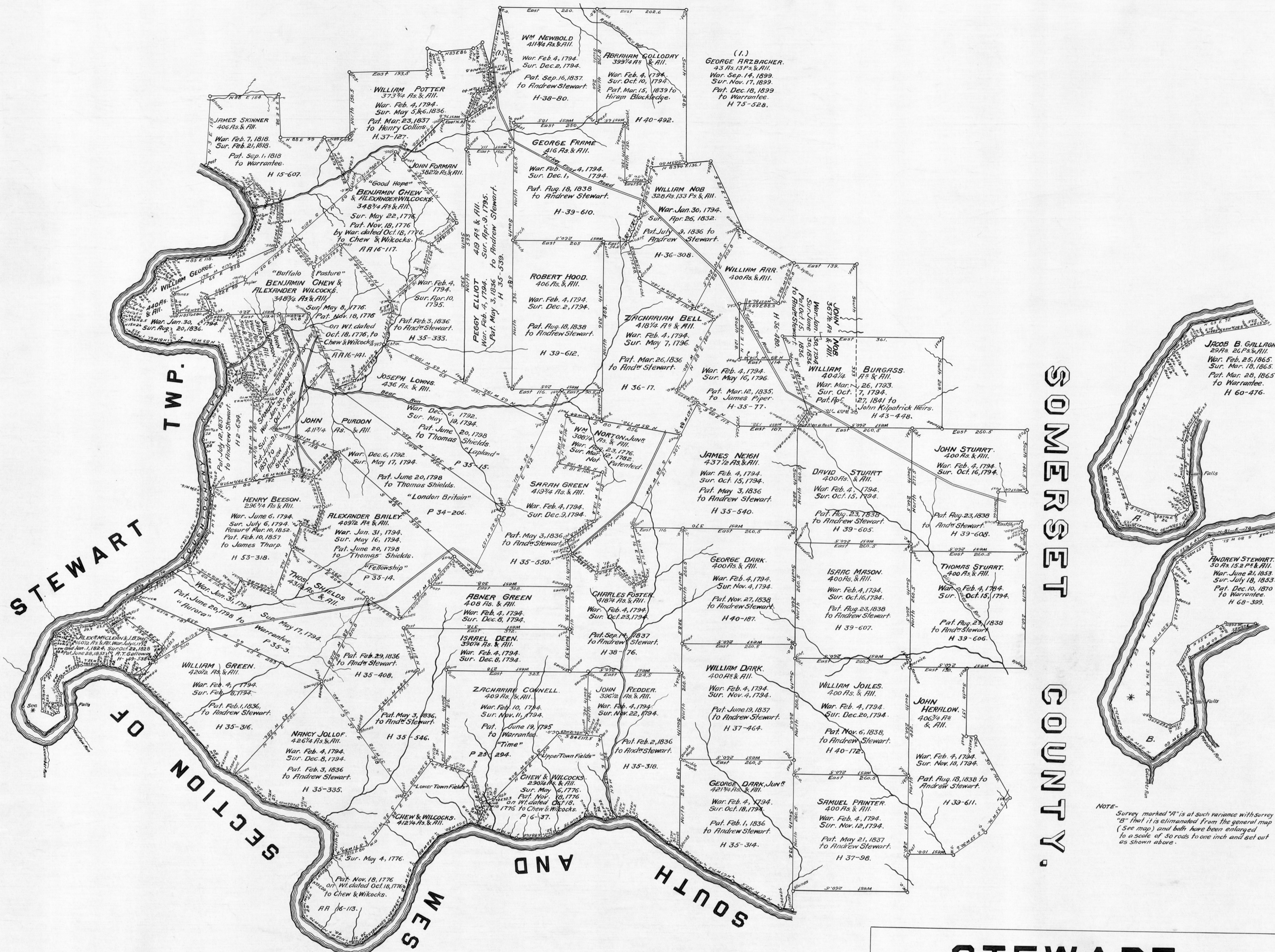

SOMERSET COUNTY.

STEWART TOWNSHIP.
NORTH AND EAST OF THE RIVER.

JOHN H. CAMPBELL,
Chief Draftsman.

In Testimony, That the above is a corrected draft of all the tracts of land situated in that part of Stewart township, Sayette county, lying north and east of the Yonghiochony river, that the warrants, surveys and patents bear date respectively as a have set forth and that said draft was constructed from and compared with the original drafts remaining on file in the Department of Internal Affairs of Pennsylvania, I have hereunto set my hand and caused the Seal of the said Department to be affixed, at Harrisburg, the third day of October, Anno Domini 1922.

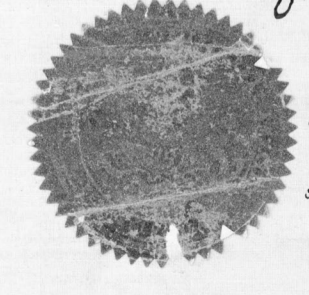

Geo. F. Woodward
Secretary of Internal Affairs.