

C R A W F O R D C O U N T Y

D E E R C R E E K T W P .

V E N A N G O C O U N T Y

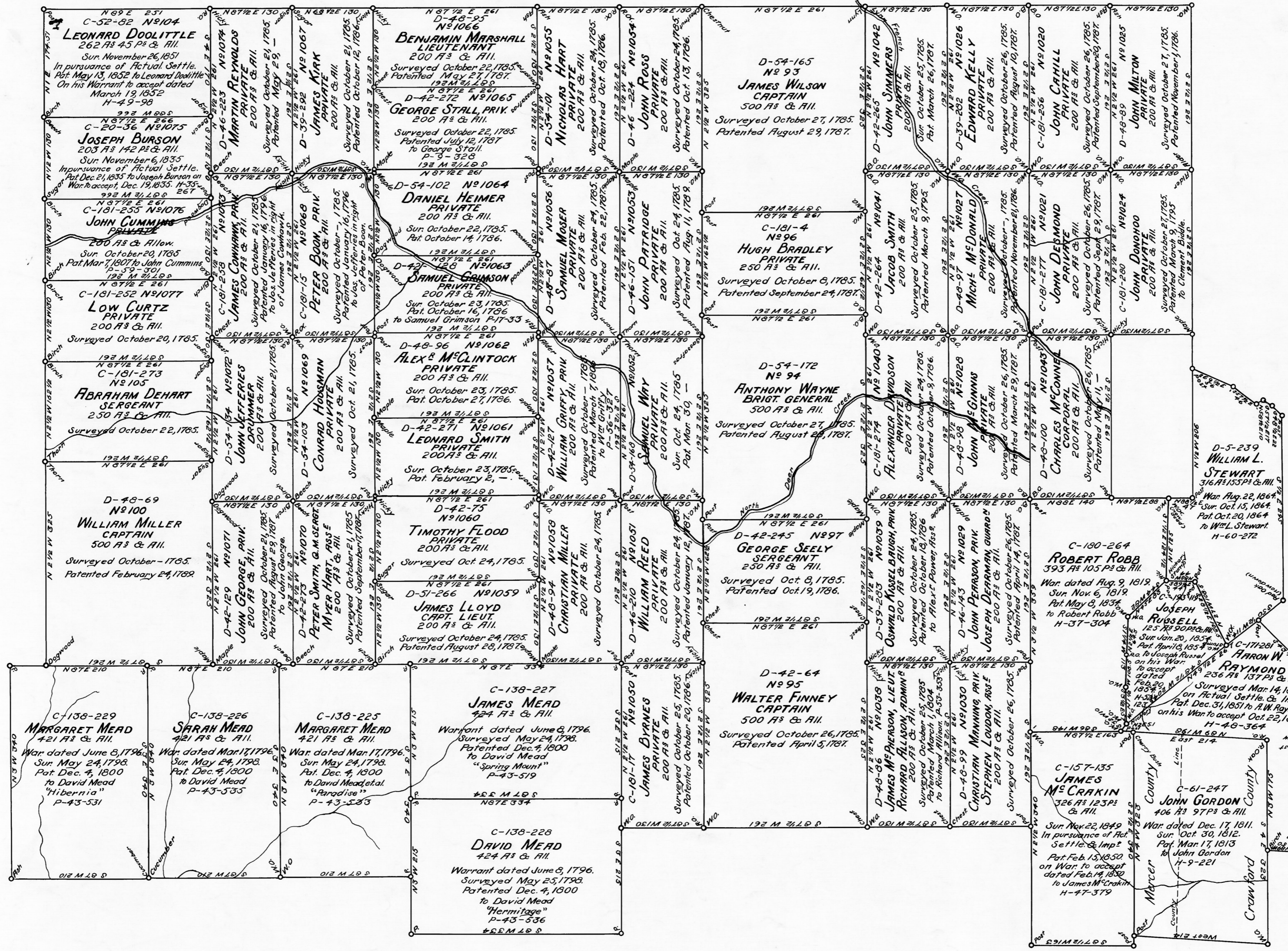

M I L L C R E E K T W P .

A Connected Draft of the tracts of land situated in French Creek Township, Mercer County. The Warrants, Surveys, and Patents bearing dates respectively as above set forth, constructed from and compared with the original drafts remaining on file in the Department of Internal Affairs of Pennsylvania, under the Direction of Warren J. Daniel, Director of the Land Office. In Testimony Whereof, I have hereunto set my hand and caused the Seal of the said Department to be affixed at Harrisburg, Pennsylvania, this twenty-second day of January, A.D. 1942.

FRENCH CREEK TOWNSHIP

William J. Daniel
Secretary of Internal Affairs