

POTTER COUNTY

LUMBER TWP.

GIBSON TWP.

GLINTON

GROVE TOWNSHIP

JOHN H. CAMPBELL,
CHIEF DRAFTSMAN.

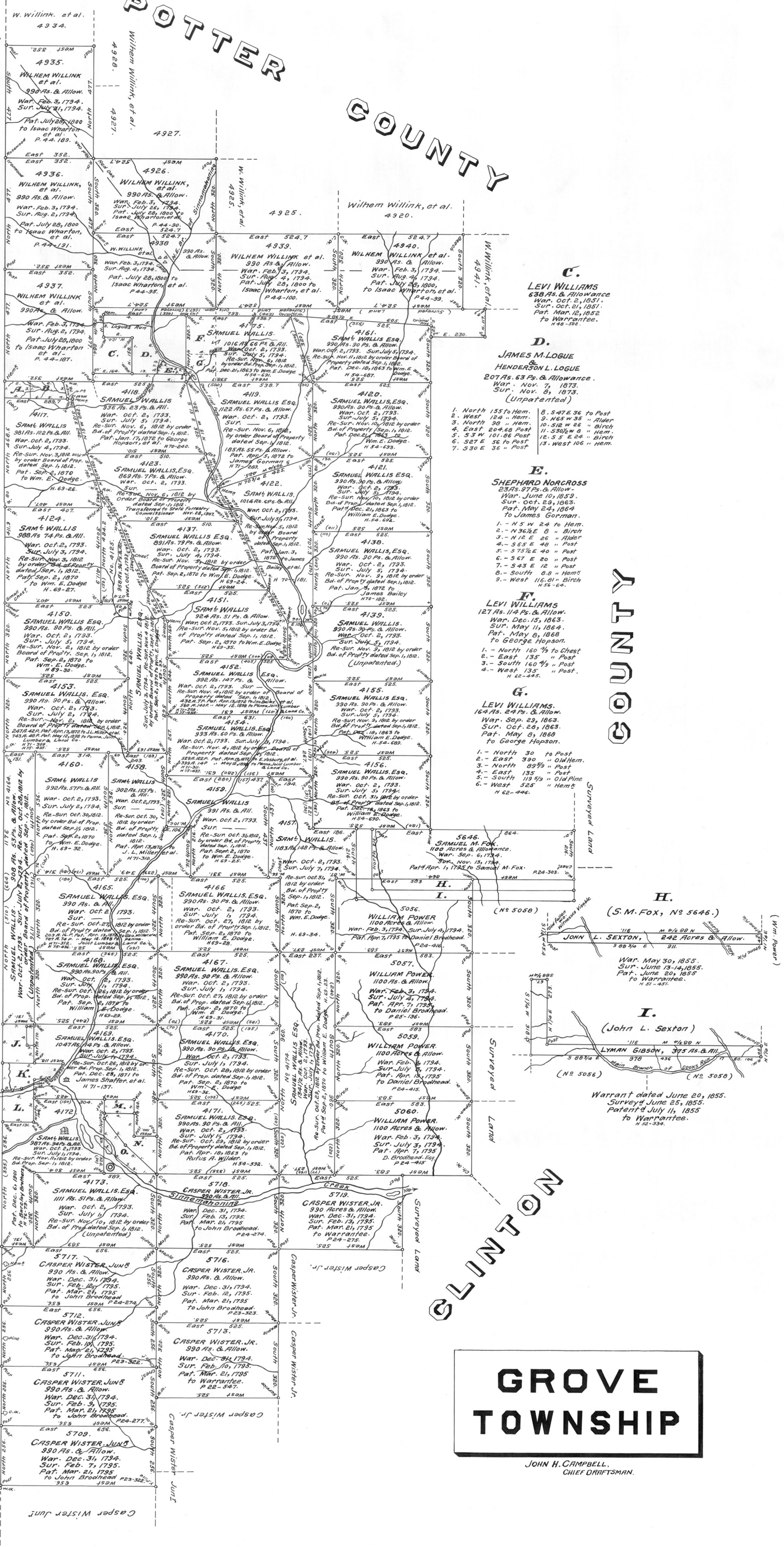

N 2 4937.
 Memlock east part of small No.
 Levi Williams
 BENJ & JAS. SHAFER
 50 Acres & Allowance
 War. May 5, 1853.
 Sur. June 9, 1854.
 Pat. Nov. 14, 1871.
 To Jas. Shaffer, Jr.
 H 10-10.
 Vac.
 Vac.
 BENJ & JAS. SHAFER, JR.
 50 Acres & Allowance.
 War. Aug. 17, 1840.
 Sur. Nov. 5, 1840.
 Pat. Nov. 14, 1871.
 To Jas. Shaffer, Jr.
 H 10-9.
 NOTE: This Survey
 appears to be
 located about
 E. & G.
 Old Line
 Submergence
 JAMES BISS.
 201 As. 84 Ps. & Allow.
 War. July 29, 1836.
 Sur. Aug. 14, 1836.
 (Unpatented).
 1 - East 1/2 Memlock.
 2 - North 1/2 " Pine
 3 - N 1/2 E 1/2 " Birch
 4 - N 20 W 40 " "
 5 - N 30 W 30 " "
 6 - West 1/2 " Pine
 7 - South 1/2 " Hemlock
 8 - N 55 W 13 " Post
 9 - S 40 W 12 " "
 10 - S 40 E 37 " Hemlock
 A.
 JACOB D. SMITH.
 54 As. 114 Ps. & All.
 War. Oct. 23, 1853.
 Sur. Nov. 13, 1853.
 (Unpatented).
 1 - North 77 to Ham's
 2 - East 100-58 Post
 3 - South 77 Post
 4 - West 100-58 Post
 B.
 JACOB D. SMITH.
 108 As. 82 Ps. & All.
 War. Nov. 4, 1863.
 Sur. Nov. 13, 1863.
 (Unpatented).
 1 - North 77 to Post
 2 - East 231-48 Ham's
 3 - S 1/2 E 77 Birch
 4 - South 77 Post
 5 - South E 6 Post
 6 - West 77-41 Post
 J.
 JAMES SHAFER, JR.
 16 As. 54 Ps. & All.
 War. Oct. 23, 1852.
 Sur. Nov. 29, 1852.
 Pat. July 23, 1853.
 To Warrantee.
 1 - East 131 Stones.
 2 - North 79 Post
 3 - West 38 Post
 4 - North 81 Post
 5 - East 32 Post
 6 - North 10 Pine
 7 - West 101 Post
 8 - South 170 Stones.
 H 49-373.
 K.
 JOHN HOUSTON.
 150 As. & Allow.
 War. May 17, 1785.
 Sur. June 23, 1855.
 Pat. May 6, 1855.
 To Warrantee.
 1 - North 118 Post near w.o.
 2 - East 305 Hickory
 3 - S 75 W 30 " "
 4 - N 72 W 29 " "
 5 - S 96 W 20 " "
 6 - S 70 W 136 " "
 7 - S 81 W 39 " "
 8 - West 40 W.O.
 H 35-387.
 L.
 HENRY SHAFER.
 77 As. & Allow.
 War. Mar. 6, 1855.
 Sur. June 23, 1855.
 Pat. Dec. 21, 1855.
 To Warrantee.
 1 - North 76 1/2 Stone Pine
 2 - N 73 E 146.0 Post. by Butterbur
 3 - S 75 W 101.1 Post.
 4 - West 136.0 Post.
 H 32-434.
 M.
 Wm. E. DODGE
 39 As. 127 Ps. & Allowance.
 War. Sep. 2, 1852.
 Sur. Sep. 6, 1852.
 Pat. Sep. 15, 1852.
 To Warrantee.
 1 - North 63 Chest.
 2 - East 107 1/4 Maple.
 3 - South 109.1 Post.
 4 - West 107.14 Post.
 H 54-383.
 N.
 D.K. JACKMAN
 137 As. & Allow.
 War. Dec. 29, 1854.
 Sur. May 26, 1852.
 Pat. Nov. 13, 1837.
 To Pennington Lumber
 & Lard Co.
 1 - N 42 3/4 W 185 Butterbur.
 2 - N 34 1/2 W 144 W.O.
 3 - North 62 47 Post.
 4 - East 107 1/4 Post.
 5 - South 37 Post.
 6 - East 109 Oak.
 7 - South 100 Stone Pine.
 H 75-304.
 O.
 JOHN CAMPBELL
 & ISAC RAMAGE.
 135 As. & Allowance.
 War. Nov. 30, 1839.
 Sur. Mar. 10, 1839.
 Pat. Aug. 21, 1854.
 To John Campbell.
 1 - N 65 W 85 Chest
 2 - N 67 W 39 Post.
 3 - N 47 W 76 Oak.
 4 - N 49 W 80 W.O.
 5 - N 25 W 27 W.O.
 6 - North 149 W.O.
 7 - S 34 E 139 Birch
 8 - S 42 1/2 E 139 W.O.
 H 51-385.
 P.
 WM FLOYD, JR.
 400 Acres & Allow.
 War. dated June 15, 1837
 Patented Aug. 24, 1837.
 1 - S 66 E 29 to Pine.
 2 - East 29 (of 17 Run).
 3 - S 74 E 28 Hickory.
 4 - S 54 E 146 " "
 5 - S 31 E 44 Pine.
 6 - S 31 E 120 (of 30 & 57 Runs) Pine.
 7 - S 71 E 32 Hemlock.
 8 - S 20 W 44 Hemlock.
 9 - S 42 W 209 Cowcumber.
 10 - N 17 W 226 Post.
 11 - N 58 W 160 Hem-Sapling.
 12 - N 46 W 104 W.Pine.
 13 - N 63 E 60 Hickory.
 14 - N 23 E 63 W.Pine.
 H 33-325.

In Testimony, that the above is a connected draft of seventy-four tracts of land situated in the township of Grove and county of Cameron, that the warrants, surveys and patents bear date respectively as above set forth, and that said draft was constructed from and compared with the original drafts remaining on file in the Department of Internal Affairs of Pennsylvania, I have hereunto set my hand and caused the Seal of said Department to be affixed, at Harrisburg, the eleventh day of April, Anno Domini 1923.

J. F. Woodward
Secretary of Internal Affairs.

29-2-1.