

Scale 1" = 50 Acres

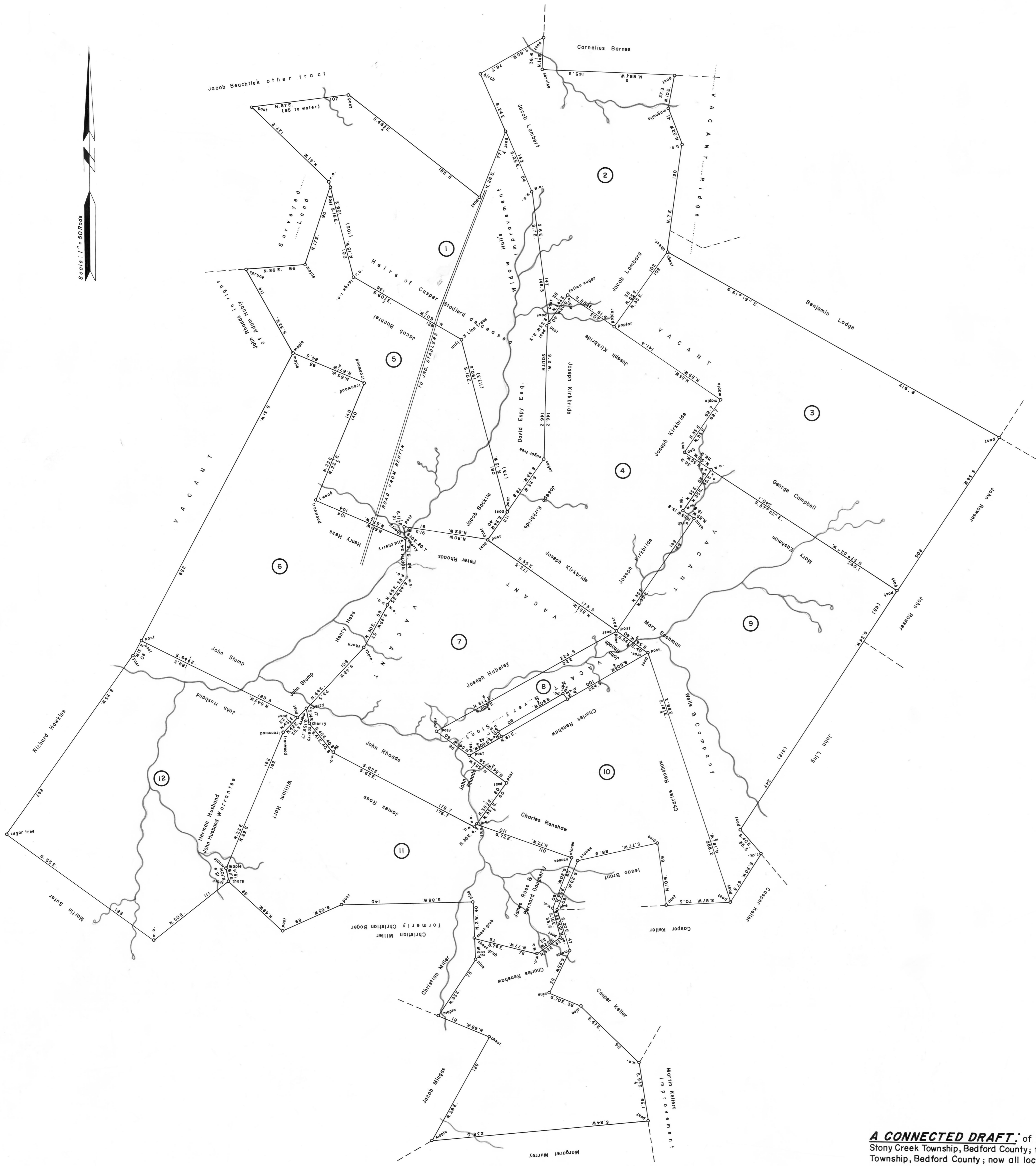

- |   |   |
|---|---|
| <p>1<br/>A—27—225<br/>CASPER STOTLER<br/>329 ACRES &amp; Allowances<br/>WARRANT JAN. 6, 1794<br/>SURVEY OCT. 10, 1793<br/>PATENT JAN. 8, 1815<br/>To—Eleanor Shell (late Stotler)<br/>H—12—55</p>             | <p>2<br/>C—10—63<br/>JACOB LAMBAR<br/>248 ACRES &amp; Allowances<br/>WARRANT AUG. 22, 1784<br/>SURVEY OCT. 2, 1784<br/>PATENT FEB. 8, 1839<br/>To—John Stotler Jr.<br/>H—40—326</p>   |
| <p>3<br/>C—34—255<br/>GEORGE CAMPBELL<br/>410 ACRES &amp; Allowances<br/>WARRANT FEB. 4, 1794<br/>SURVEY JUL. 21, 1793<br/>PATENT FEB. 12, 1870<br/>To—Philip Schrock &amp; Co.<br/>H—65—401</p>              | <p>4<br/>C—102—299<br/>JOSEPH KIRKBRIDE<br/>304 ACRES—80 PERCHES &amp; Allowances<br/>WARRANT SEPT. 3, 1774<br/>SURVEY MAY 28, 1775<br/>PATENT OCT. 5, 1776<br/>To—Michael Hillgoos<br/>COMM. BK. A—4—236<br/>"Donns"</p>   |
| <p>5<br/>C—9—158<br/>JACOB BACKTLE<br/>278 ACRES—80 PERCHES &amp; Allowances<br/>WARRANT FEB. 22, 1805<br/>SURVEY FEB. 3, 1808<br/>PATENT MAR. 29, 1809<br/>To—JACOB BACKTLE<br/>P—60—272<br/>"Stonehill"</p> | <p>6<br/>C—192—27<br/>JOHN STUMP<br/>343 ACRES—80 PERCHES &amp; Allowances<br/>WARRANT MAY 9, 1774<br/>SURVEY MAR. 18, 1775<br/>PATENT JAN. 31, 1786<br/>To—Hermon Husband<br/>H—4—354<br/>"Stumps Retreat"</p>             |
| <p>7<br/>C—84—65<br/>JOSEPH HUBELY<br/>302 ACRES &amp; Allowances<br/>WARRANT SEPT. 22, 1784<br/>SURVEY NOV. 1, 1784<br/>PATENT JAN. 23, 1787<br/>To—John Rhoads<br/>H—12—235<br/>"Mill Seat"</p>             | <p>8<br/>C—35—57<br/>JACOB BECTHEL<br/>84 ACRES &amp; Allowances<br/>WARRANT DEC. 31, 1814<br/>SURVEY MAR. 16, 1815<br/>PATENT APR. 26, 1815<br/>To—JACOB BECTHEL<br/>H—12—235<br/>"Culbridge"</p>                          |
| <p>9<br/>C—42—260<br/>MARY EASHMAN<br/>280 ACRES &amp; Allowances<br/>WARRANT FEB. 4, 1794<br/>SURVEY JUL. 21, 1793<br/>PATENT MAY 22, 1831<br/>To—Solomon Engle<br/>H—60—182</p>                             | <p>10<br/>C—227—26<br/>CHARLES RENSHAW<br/>633 ACRES &amp; Allowances<br/>WARRANT JUL. 18, 1793<br/>SURVEY JUL. 21, 1793<br/>PATENT AUG. 23, 1798<br/>To—John Wells &amp; Joseph Kirkbride<br/>H—29—284<br/>"Propriety"</p> |
| <p>11<br/>C—45—80<br/>BERNARD DOUGHERTY &amp; JAMES ROSS<br/>295 ACRES &amp; Allowances<br/>WARRANT OCT. 20, 1784<br/>SURVEY JUL. 22, 1795<br/>PATENT MAR. 22, 1831<br/>To—Christian Spyer<br/>H—30—229</p>   | <p>12<br/>C—84—150<br/>JOHN HUSBAND<br/>240 ACRES &amp; Allowances<br/>WARRANT SEPT. 28, 1774<br/>SURVEY MAR. 18, 1775<br/>PATENT JUN. 1, 1785<br/>To—JOHN HUSBAND<br/>H—30—229<br/>"Johnsburg"</p>                         |

**A CONNECTED DRAFT:** of twelve (12) tracts of land, which when surveyed, were situate as follows: seven (7) in Stony Creek Township, Bedford County; four (4) in Quemahoning Township, Bedford County; and one (1) in Brothers Valley Township, Bedford County; now all located in Stonycreek and Allegheny Townships, Somerset County. The draft has been constructed from and compared with original drafts on file in the Bureau of Land Records, Department of Community Affairs, Commonwealth of Pennsylvania, under the direction of Edward Price, Director.

**IN TESTIMONY WHEREOF:** I have hereunto set my hand and caused the seal of the said Department to be affixed at Harrisburg, Pennsylvania, this twenty second day of February A.D., one thousand nine hundred and eighty.



*Shirley M. Dennis*  
SHIRLEY M. DENNIS, Secretary of Community Affairs

1696