

SCALE: 1" = 100 RODS

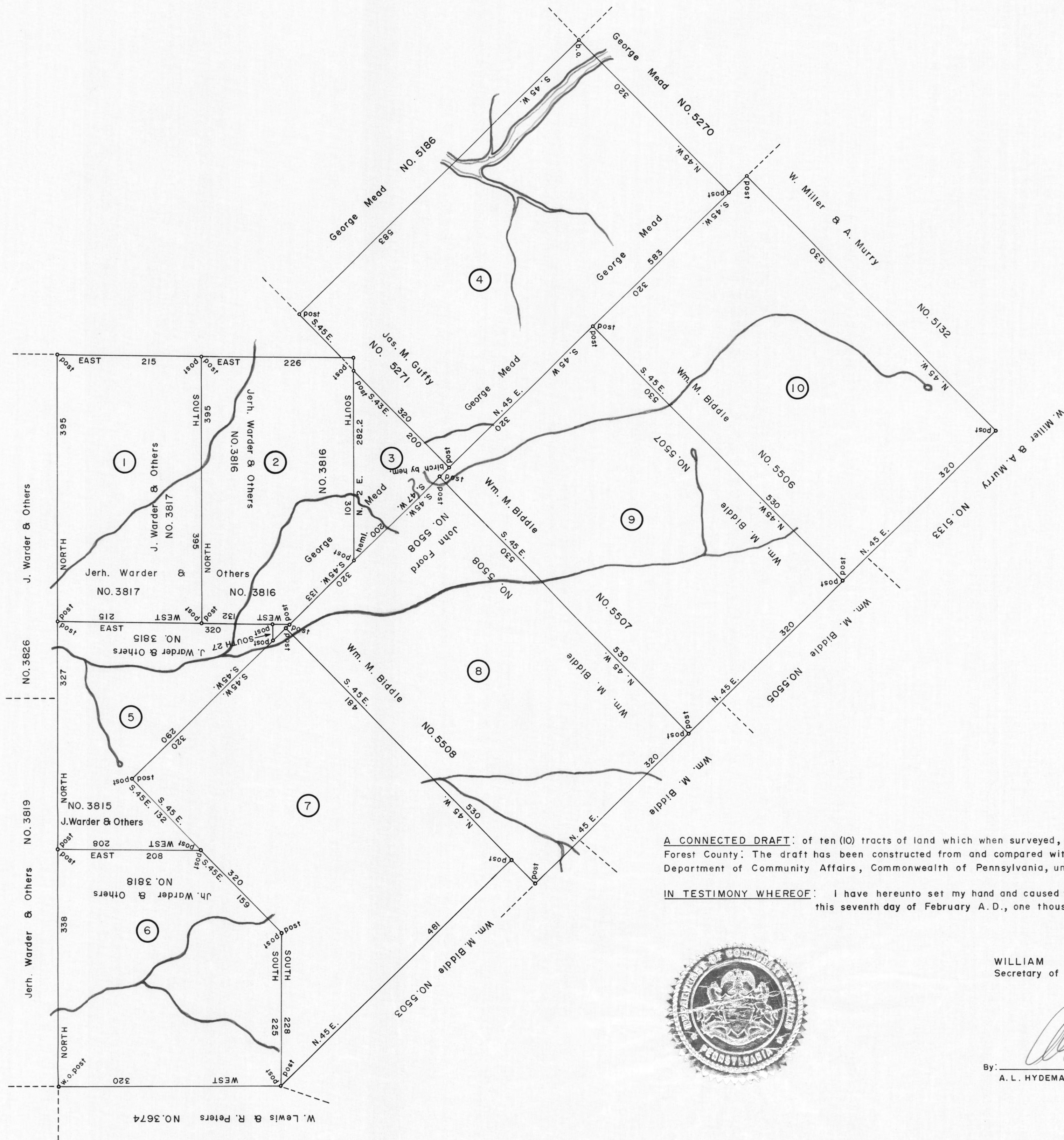

①  
 A — 78 — 82  
 JEREMIAH WARDER ET. AL.  
 500 ACRES & Allowance  
 WARRANT — APRIL 18, 1793  
 TRACT NO. 3817 — L. P. — DIST. NO. 6  
 SURVEY — JULY 27, 1793  
 PATENT — OCT. 25, 1806  
 TO — WILLIAM OGDEN  
 P — 59 — 104  
 "Emsworth"

⑥  
 A — 78 — 83  
 JEREMIAH WARDER ET. AL.  
 600 ACRES & Allowance  
 WARRANT — APRIL 18, 1793  
 TRACT NO. 3818 — L. P. — DIST. NO. 6  
 SURVEY — JULY 27, 1793  
 PATENT — OCT. 25, 1806  
 TO — WILLIAM OGDEN  
 P — 59 — 105  
 "Landsdown"

②  
 A — 78 — 84  
 JEREMIAH WARDER ET. AL.  
 500 ACRES & Allowance  
 WARRANT — APRIL 18, 1793  
 TRACT NO. 3816 — L. P. — DIST. NO. 6  
 SURVEY — JULY 27, 1793  
 PATENT — OCT. 25, 1806  
 TO — WILLIAM OGDEN  
 P — 59 — 107  
 "Entertainment"

⑦  
 C — 8 — 271  
 Wm. M. BIDDLE  
 984 ACRES & Allowance  
 WARRANT — MARCH 5, 1794  
 TRACT NO. 5509 — L. P. — DIST. NO. 6  
 SURVEY — APRIL 29, 1794  
 PATENT — FEB. 14, 1795  
 TO — CLEMENT BIDDLE  
 P — 22 — 478  
 "Langland"

③  
 C — 112 — 34  
 Wm. HILANDS  
 118 ACRES & Allowance  
 WARRANT — FEB. 26, 1848  
 SURVEY — JUNE 19, 1848  
 PATENT — JUNE 28, 1848  
 TO — WILLIAM HILANDS  
 H — 46 — 536

⑧  
 C — 8 — 273  
 Wm. M. BIDDLE  
 1000 ACRES & Allowance  
 WARRANT — MARCH 5, 1794  
 TRACT NO. 5508 — L. P. — DIST. NO. 6  
 SURVEY — APRIL 29, 1794  
 PATENT — FEB. 14, 1795  
 TO — CLEMENT BIDDLE  
 P — 23 — 244  
 "Friesland"

④  
 C — 137 — 69  
 GEORGE MEAD  
 110 ACRES & Allowance  
 WARRANT — FEB. 26, 1794  
 TRACT NO. 5271 — L. P. — DIST. NO. 6  
 SURVEY — APRIL 26, 1794  
 PATENT — JUNE 4, 1798  
 TO — JAMES YARD  
 P — 34 — 90  
 "Troy"

⑨  
 K — 501  
 Wm. M. BIDDLE  
 1000 ACRES & Allowance  
 WARRANT — MARCH 5, 1794  
 TRACT NO. 5507 — L. P. — DIST. NO. 6  
 SURVEY — APRIL 29, 1794  
 PATENT — FEB. 14, 1795  
 TO — CLEMENT BIDDLE  
 P — 24 — 216  
 "Fridland"

⑤  
 A — 78 — 81  
 JEREMIAH WARDER ET. AL.  
 400 ACRES & Allowance  
 WARRANT — APRIL 18, 1793  
 TRACT NO. 3815 — L. P. — DIST. NO. 6  
 SURVEY — JULY 27, 1793  
 PATENT — OCT. 25, 1806  
 TO — WILLIAM OGDEN  
 P — 59 — 106  
 "Manchester"

⑩  
 C — 8 — 268  
 Wm. M. BIDDLE  
 1000 ACRES & Allowance  
 WARRANT — MARCH 5, 1794  
 TRACT NO. 5506 — L. P. — DIST. NO. 6  
 SURVEY — APRIL 29, 1794  
 PATENT — FEB. 14, 1795  
 TO — CLEMENT BIDDLE  
 P — 23 — 244  
 "Kingston"

A CONNECTED DRAFT: of ten (10) tracts of land which when surveyed, were situate as follows: ten (10) in District No. 6 Last Purchase, now Forest County: The draft has been constructed from and compared with the original drafts on file in the Bureau of Land Records, Department of Community Affairs, Commonwealth of Pennsylvania, under the direction of Edward D. Price, Director.

IN TESTIMONY WHEREOF: I have hereunto set my hand and caused the seal of the said Department to be affixed at Harrisburg, Pennsylvania, this seventh day of February A. D., one thousand nine hundred and seventy three.

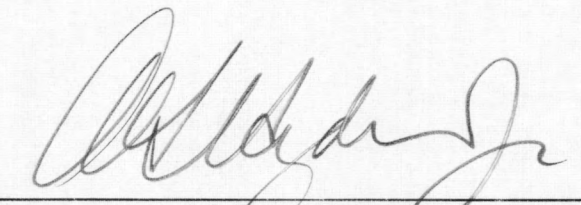

WILLIAM H. WILCOX  
 Secretary of Community Affairs

By:   
 A. L. HYDEMAN JR., Executive Deputy Secretary