

Abbreviated Historic Resource Survey Form Pennsylvania Historical Museum Commission

IDENTIFICATION AND LOCATION

ER #: 02-8006-081
Survey Code: ADM No. 065 Tax Parcel: Various
County: Lycoming Municipality: Platt Township
Address: 1335, 1331, 1269 Youngs Road
Historic/Other Name: Youngs Road Ranch Grouping
Owner Name/Address: Various

Owner Category: Private
USGS Quad: Linden
UTM Zone: 18 N: 4564476 E: 316616
PHYSICAL DESCRIPTION
Resource Classification: District # Resources: 3
Historic Property Type: Domestic, Single Dwelling
Current Property Type: Domestic, Single Dwelling

Year Built: 1945-1958
Architectural Style: Minimal Traditional
Structural System: Wood: Timber -- light frame
Materials: Foundation: Concrete
Walls: Vinyl
Roof: Asphalt
Width in Bays: 3 bays Stories: 1-1.5 Stories

NATIONAL REGISTER DETERMINATION

Justification: Lacks historic significance and architectural integrity. Alterations include encasement of walls in vinyl siding and replacement windows.

SURVEYOR INFORMATION

Name: Barbara Copp and Travis Beckwith Date: August, 2003
Project Name: S.R. 0200, Section 077, Susquehanna Beltway
Organization: A.D. Marble & Company
Location: 3913 Hartzdale Drive, Suite 1302
Camp Hill, PA 17011-7845
Previous Survey:

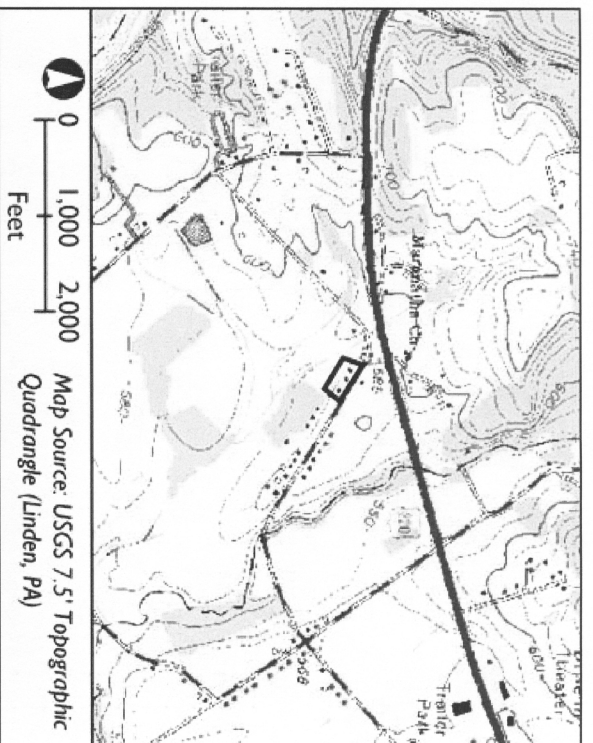

Abbreviated Historic Resource Survey Form Pennsylvania Historical Museum Commission

IDENTIFICATION AND LOCATION

File # 127298

ER #: 02-8006-081
Survey Code: ADM No. 065
County: Lycoming
Address: 1335, 1331, 1269 Youngs Road
Historic/Other Name: Youngs Road Ranch Grouping
Owner Name/Address: Various

Owner Category: Private
USGS Quad: Linden
UTM Zone: 18 N: 4564476 E: 316616
PHYSICAL DESCRIPTION

Resource Classification: District
Historic Property Type: Domestic, Single Dwelling
Current Property Type: Domestic, Single Dwelling
Year Built: 1945-1958

Architectural Style: Minimal Traditional
Structural System: Wood: Timber -- light frame
Materials: Foundation: Concrete
Walls: Vinyl
Roof: Asphalt
Width in Bays: 3 bays Stories: 1-1.5 Stories

NATIONAL REGISTER DETERMINATION

Justification: Lacks historic significance and architectural integrity. Alterations include encasement of walls in vinyl siding and replacement windows.

SURVEYOR INFORMATION

Name: Barbara Copp and Travis Beckwith Date: August, 2003
Project Name: S.R. 0200, Section 077, Susquehanna Beltway
Organization: A.D. Marble & Company
Location: 3913 Hartzdale Drive, Suite 1302
Camp Hill, PA 17011-7845
Previous Survey:

