

150037 – Towamensing Elementary School

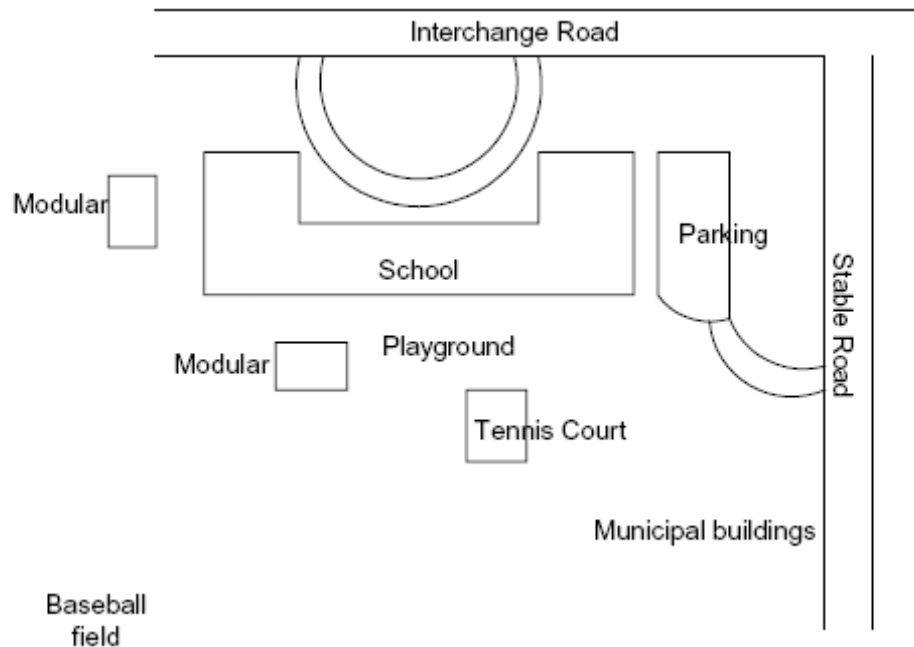

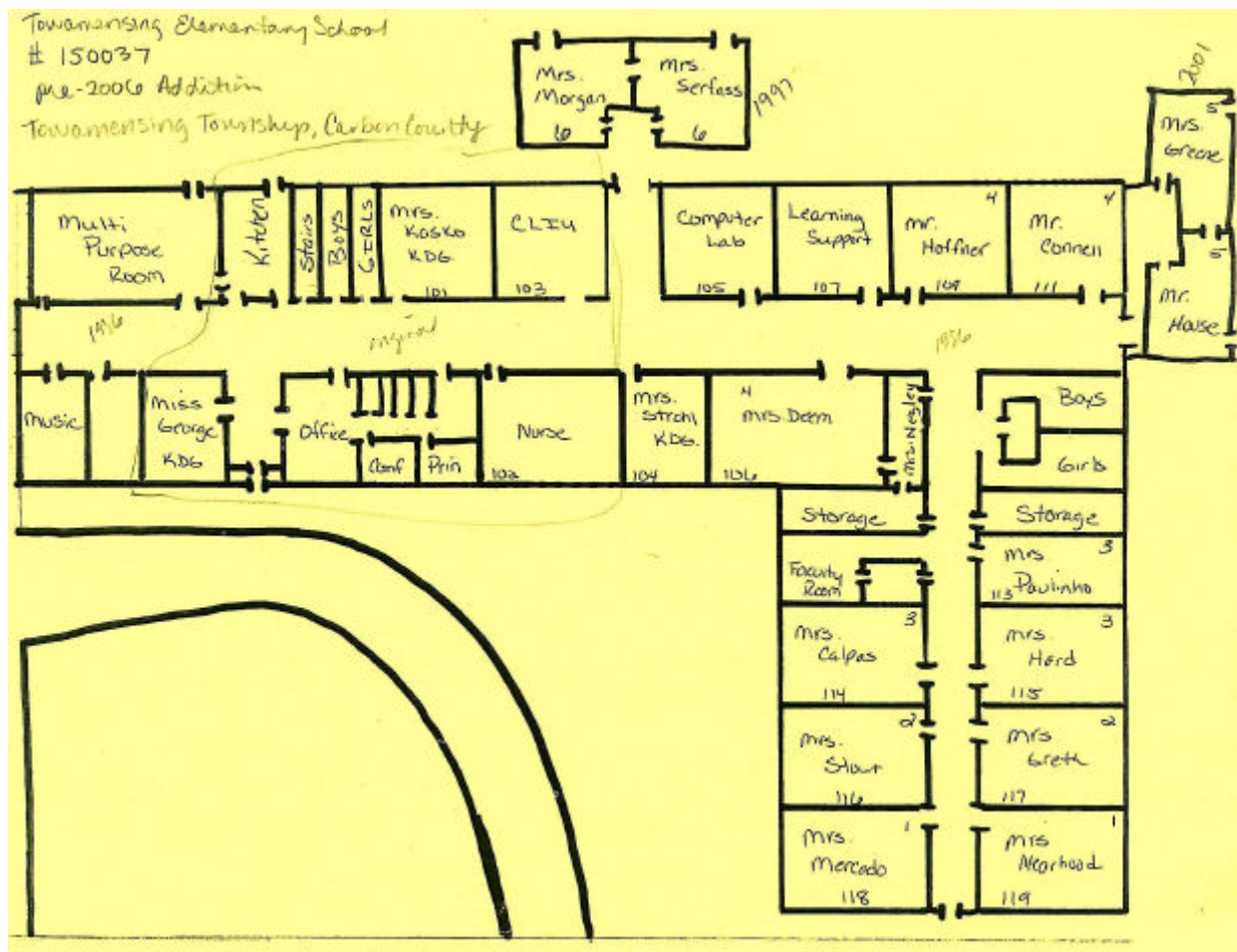

Site Plan of Towamensing Elementary School



Floor Plan for Towamensing Elementary School

150037; Towamensing Elementary School. This school is located at 7920 Interchange Road, Leighton, Pennsylvania in Towamensing Township, Carbon County. It is part of the Palmerton Area School District. The 1955 school building is set back from the roadway behind a circular driveway and lawn with scattered trees and a school sign. A paved parking area on the east side of the school is accessed from a driveway off of Stable Road due to current construction. Open fields abut a tree farm at the rear of the property, and the Towamensing Township municipal building and lot at the eastern corner. A baseball diamond is located at the rear of the school fields. Modern playground equipment and a fenced-in tennis court (currently used for storage) are also located at the rear of the school, closer to the building. A flagpole is located in front of the school. Modular classrooms are located on the southwest and southeast sides of the school building.

The core of the school is a one-story rectangular building, completed in 1955. An L-plan wing of classrooms, a music room, and a multi-purpose room were added to the original structure in 1986. Construction on an additional wing was on-going in 2006, transforming the building into a U-plan structure. Interior linear hallways are flanked by classrooms and other-use spaces. Interior spaces were also remodeled in 2006. The core of the school is a steel-reinforced brick structure set on a concrete-block foundation. Decorative elements include the application of PermaStone surrounding the main entrance. Rubber membrane covers the flat roof. The building has a brick chimney dating to 2006. Metal-frame glass doors with transoms were installed in the main entryway in 2006. A flat-roof overhang shelters the entrance. It is clad in metal siding and supported by metal posts. Windows in the school were replaced in 2006 with modern picture and awning windows.

The 1986 construction project included a one-story L-plan classroom wing on the southwest end of the core and a music room and all-purpose room on the northeast end of the core. The addition included a library, which has since been converted to classroom use. An art room is also used as a classroom. The 2006 construction project includes a one-story wing set perpendicular to the northeast end of the school. It includes a gymnasium and classrooms. Remodeling in 2006 includes the expansion of the front office, the conversion of the nurse's office to the principal's office, and the creation of a new nurse's suite. The additions are brick structures, set on concrete slab foundations. Two sets of modular classrooms are located on the property. A set dating to 1997 at the rear of the school is accessed via a temporary covered roof. A set dating to 2001 at the southwest side of the school is accessed via an enclosed hallway. Both are side-gabled frame one-story structures with wood decks.

Hallways feature vinyl floor tiles, acoustic ceiling tiles, fluorescent lights, painted plaster walls, bulletin boards, and metal classroom doors. Classrooms feature vinyl floor tile or carpeting, acoustic ceiling tiles, and fluorescent lights. The "cafegymatorium" located at the northeast end of the school dates to 1986. It features vinyl floor tiles, acoustic ceiling tiles, fluorescent lights, suspended basketball hoops, concrete-block walls, and fold-out tables and chairs. Although a space designated for cafeteria use wasn't built until 1986, the 1955 kitchen in the school is original to the building.

One-room schools in rural Towamensing Township were graded in 1948. In the 1950s, school district consolidation occurred, one-room schools were closed, and the Lower

Carbon Elementary Jointure was formed. Construction commenced on the consolidated Towamensing Elementary School in 1954. Development and increased population necessitated expansions in 1986 and 2006.

Lower Carbon Elementary Jointure, Board of School Directors and School Authority

1955 *Program of Dedication and Open House by the Board of School Directors and School Authority* provided by Towamensing Elementary School.

United States Department of Agriculture

1959 Aerial Photograph AQT-3W-63. Created on May 9, 1959. On file at the Pennsylvania Geological Survey Library, Middletown, Pennsylvania.

United States Geological Survey

1999 *Palmerton NW, PA Aerial Photograph*. USGS Reference Number a 40075-G5-01-PHT. Created on April 13, 1999.

1999 *Palmerton, PA Quadrangle*. Topography compiled 1951. Planimetry derived from imagery taken 1982 and other sources. Photoinspected using imagery dated 1997. Survey control current as of 1960. Boundaries, other than corporate, revised 1999. Denver, CO.



Aerial View of Towamensing Elementary School

More Photos of Towamensing Elementary School

