

150005 – Marion Elementary School

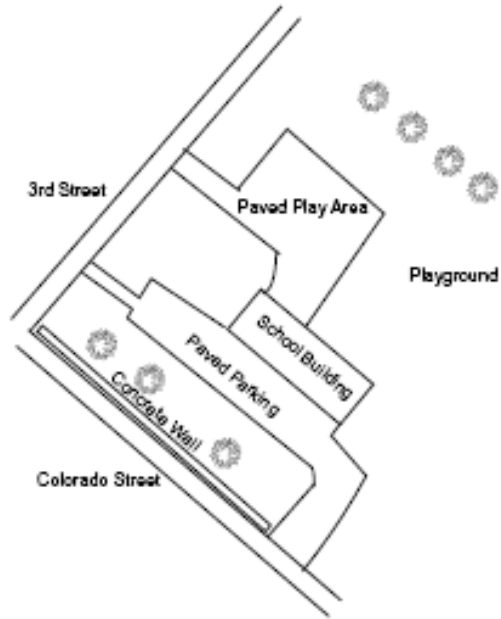

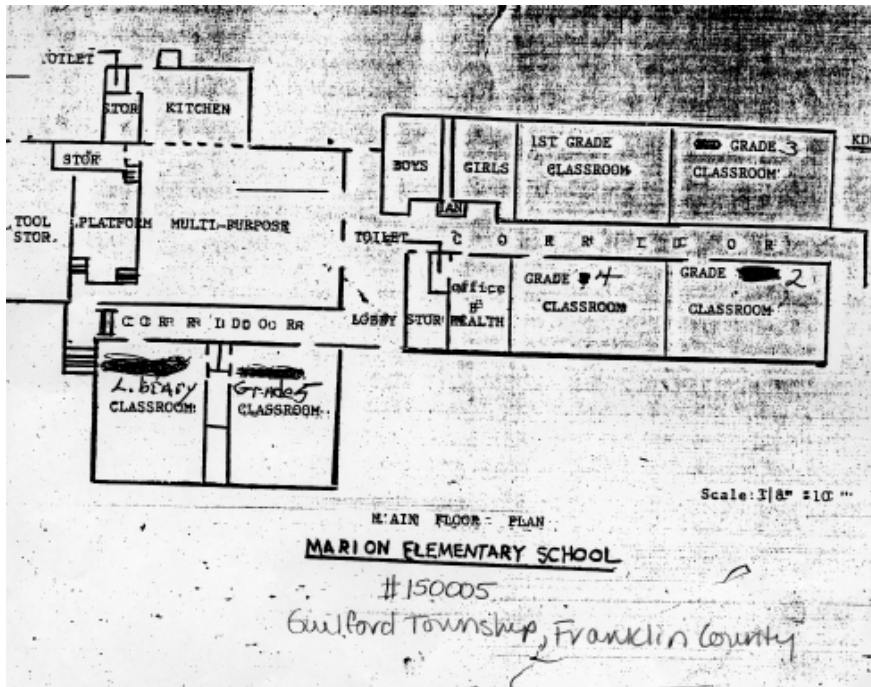

Site Plan of Marion Elementary



Floor Plan of Marion Elementary

150005; Marion Elementary School. This school is located at 145 Colorado Street, Marion, Pennsylvania, in Guilford Township, Franklin County. It is part of the Chambersburg Area School District. The ca. 1908 school sits on a small lot at the corner of Colorado and 3rd Streets. The school building is set back from Colorado Street behind a paved parking lot and a wide swath of lawn with scattered trees. A paved play area and playground equipment surrounded by a lawn are located at the rear of the building and the lot. The front lawn features scattered trees and bushes. A low concrete retaining wall along the front of the property runs along Colorado Street. A circular pier engraved with "1908" is located at the end of the wall. A small parking lot is located at the southwest corner of the school. The walkways are concrete. The paved play area features a basketball court. The swings in the playground date to ca. 1957. Additional playground equipment is from a later period.

The one-story school building is comprised of two main sections. The original rectangular school building was constructed with two classrooms and a rear hallway. An extensive addition constructed in 1957 added a full wing, a multi-purpose room, and a kitchen. The original school is a frame-reinforced structure with brick walls. The building sits on a stone foundation. Asphalt shingles cover the hipped roof, which features exposed rafters. An original entrance, located in a hipped side vestibule area, is a double set of pane-and-panel wood doors. The entrance is sheltered by an extension of the vestibule roof, supported by chamfered posts. The building is lit by six-over-six double-hung wood windows with slab sills and lintels. The 1957 addition to the school includes a large multi-purpose room with a kitchen at the rear of the original school building. The combination cafeteria/auditorium/gymnasium has access to the kitchen and stage. The current main entrance to the school and lobby connects the multi-purpose room and original school building to a 1957 one-story wing containing classroom and office space, and bathrooms. The addition reflects the original building in that it is a frame structure with brick walls lit by six-over-six double-hung wood windows. A portable one-story kindergarten room was appended to the eastern corner of the school ca. 1970.

The corridor at the rear of the original school building features a tile floor, a dropped ceiling with acoustic ceiling tile, fluorescent lighting, and a trap door to a cellar. Doors to the two classrooms are pane-and-panel with multi-pane transoms. The classrooms feature acoustic ceiling tile, fluorescent lighting, coatrooms, and decorative molding incorporated into bulletin board/chalkboard space. One classroom has been converted into the school library. The library floor is carpeted.

The original school building appears to have been constructed ca. 1908 to replace a one-room schoolhouse located on the other side of Colorado Street. In 1957, the school was expanded significantly with the construction of the large addition.

(Robert Carball, pers. com., April 17, 2006.)

United States Geological Survey

1994 *Greencastle NE, PA Aerial Photograph*. USGS Reference Number 39077-G6-02-PHT. Created on April 15, 1994.

1995 *Greencastle, PA Quadrangle*. 7.5 minute series. Compiled from imagery dated 1988. Field checked 1990. Map edited 1995. Denver, CO or Reston, VA.

United States Department of Agriculture

1937 Aerial Photograph AHF 30-38. On file at the Pennsylvania State Archives, Record Group 31, Records of the Department of Commerce, State Planning Board Collection.



Aerial View of Marion Elementary

Other Photos of Marion Elementary School

